

A Firm Access with *Kadex* Series

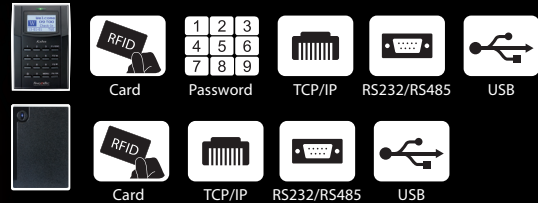

Kadex series is an access control and time attendance card reader system suitable for all types of offices that require a card solution with a modern twist. The main reader Kadex supports card ID, a 5-digit password and a combination of both, m-Kadex is a simpler version of Kadex without any LCD screen and keypads, while i-Kadex and k-Kadex are both the slave readers of Kadex series. A combination of either Kadex or m-Kadex with any of the slave readers will make a complete and cost-effective in/out door access system for your premises.



Small, Yet Loaded with Great Capacity

Kadex and m-Kadex can store a whopping total of 30000 users, and 50000 transaction logs.

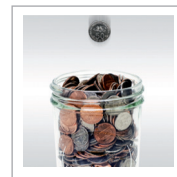

Value for Money

Mix and match your FingerTec system with m-Kadex to give you more value for your money. Choose Kadex for the main entrance and m-Kadex for other entrances.



Combine Your Verification Methods

Choose a combination of verification methods to secure your workplace i.e. card and password for tighter security.



Manage Your Shift Workers

Kadex and m-Kadex can be programmed with a total of 50 time zones – perfect for companies with shift work.



Manage Your Data Easily

Administration of data is easy with the bundled software, Ingress. With Ingress you can remotely manage all door activities of the connected terminals and get time attendance functions too.



Built-In Alarm

Increase the security at your workplace by installing an external alarm, and be alerted during unexpected scenarios such as break-ins and fire emergencies.



Simple Administrator Management & Enrollment

m-Kadex's simple outlook is complimented with a simple management system. Just swipe your administrator card to enroll, delete, or reset the terminal.



Easy Data Management

Apart from providing a TCP/IP connection for data transfer, Kadex offers a USB data transfer as well.



WEB LINK



Product
<http://info.fingertec.com/kadex-1>
<http://info.fingertec.com/mkadex-1>



Quick Start Guide
<http://info.fingertec.com/kadexmkadex-2>



Installation Guide
<http://info.fingertec.com/kadex-3>
<http://info.fingertec.com/mkadex-3>



User Guide
<http://info.fingertec.com/kadex-4>
<http://info.fingertec.com/mkadex-4>



Video Guide
<http://info.fingertec.com/kadex-5>



Technical Tips
<http://info.fingertec.com/kadex-6>



Ingress Software
<http://info.fingertec.com/ingress>

LAYOUT PLAN

System Communication

for illustration only

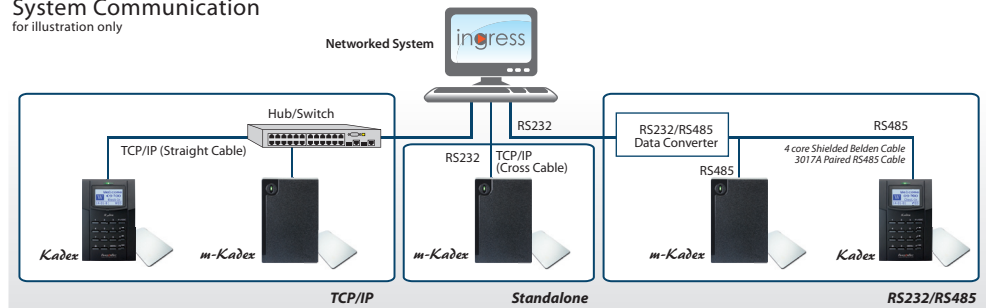

Note: System Communication for Kadex installation is exactly the same as shown above, minus the i-Kadex

Installation Diagram

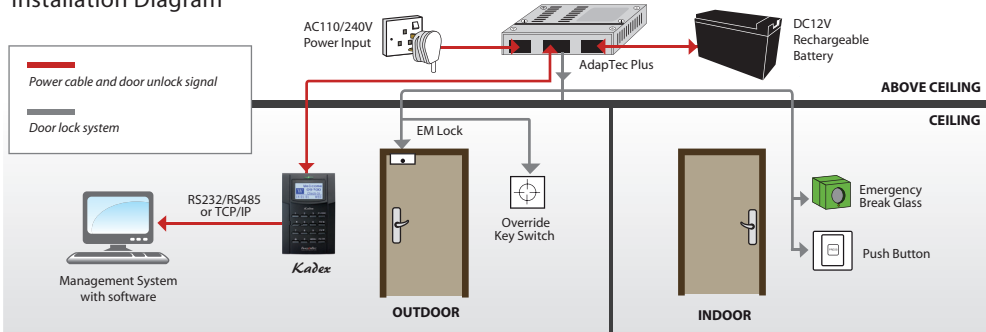

SPECIFICATIONS

MODEL	Kadex	m-Kadex
SURFACE FINISHING	Acrylonitrile butadiene styrene (ABS)	Polycarbonate
TYPE OF ANTENNA	RFID	
MICROPROCESSOR	400 MHz	
MEMORY	8 MB flash memory & 32 MB SDRAM	4 MB flash memory & 32 MB SDRAM
PUSH TECHNOLOGY	Yes	N/A
DIMENSION (L X W X H), mm	92 x 49 x 137	92 x 29 x 134
STORAGE		
Cards	30000	
Transactions	50000	
ENROLLMENT & VERIFICATION		
Methods	Card & password	Card
Card per user ID	1	
Reading distance, mm	40 ~ 80 (RFID, HID), 30 ~ 50 (Mifare)	
Verification time (sec)	<1	
CARD TECHNOLOGY		
RFID: 64-bit, 125kHz	Yes	
MIFARE: MFIS50/S70, 13.56MHz	Made to order	
HID: HID 1325, 26-bit, 125kHz	Made to order	
COMMUNICATIONS		
Method	TCP/IP, RS232, RS485, USB disk	
Baud rates	9600, 19200, 38400, 57600, 115200	
Wiegand	26-bit input / output	
OPERATING ENVIRONMENT		
Temperature (°C)	0 ~ 45	
Humidity (%)	20 ~ 80	
Power input	DC 12V 2A	
TIME ATTENDANCE		
Work codes	Yes	N/A
MULTIMEDIA		
Voice	Yes	N/A
Display	Black and White	N/A
Short messaging	Yes	N/A
ACCESS CONTROL		
EM lock driving output	DC 12V 3A / relay output	
Alarm output	NO / NC	
Anti passback	Yes	
VOICE / DISPLAY LANGUAGE (TERMINAL) <small>(only for Kadex)</small>	English (Standard), Arabic, Chinese (Simplified/Traditional), Indonesian, Portuguese (Portugal), Spanish. Other languages are available upon request.	
SOFTWARE LANGUAGE	English (Standard), Arabic, Bulgarian, Chinese (Simplified/Traditional), French, German, Hindi, Indonesian, Kurdish, Malay, Persian, Portuguese, Russian, Spanish, Thai, Vietnamese	

*N/A: Not applicable

NOTE: Specifications are subject to change. Check <http://product.fingertec.com> for latest product information.



Packaging

Kadex
 Dimension (mm) : 225 (L) x 72 (W) x 168 (H)
 Weight : 0.80 kg

m-Kadex
 Dimension (mm) : 225 (L) x 72 (W) x 168 (H)
 Weight : 0.72 kg



FINGERTEC
www.fingertec.com

© 2018 Timetec Computing Sdn Bhd. All rights reserved.