

# GRINDING

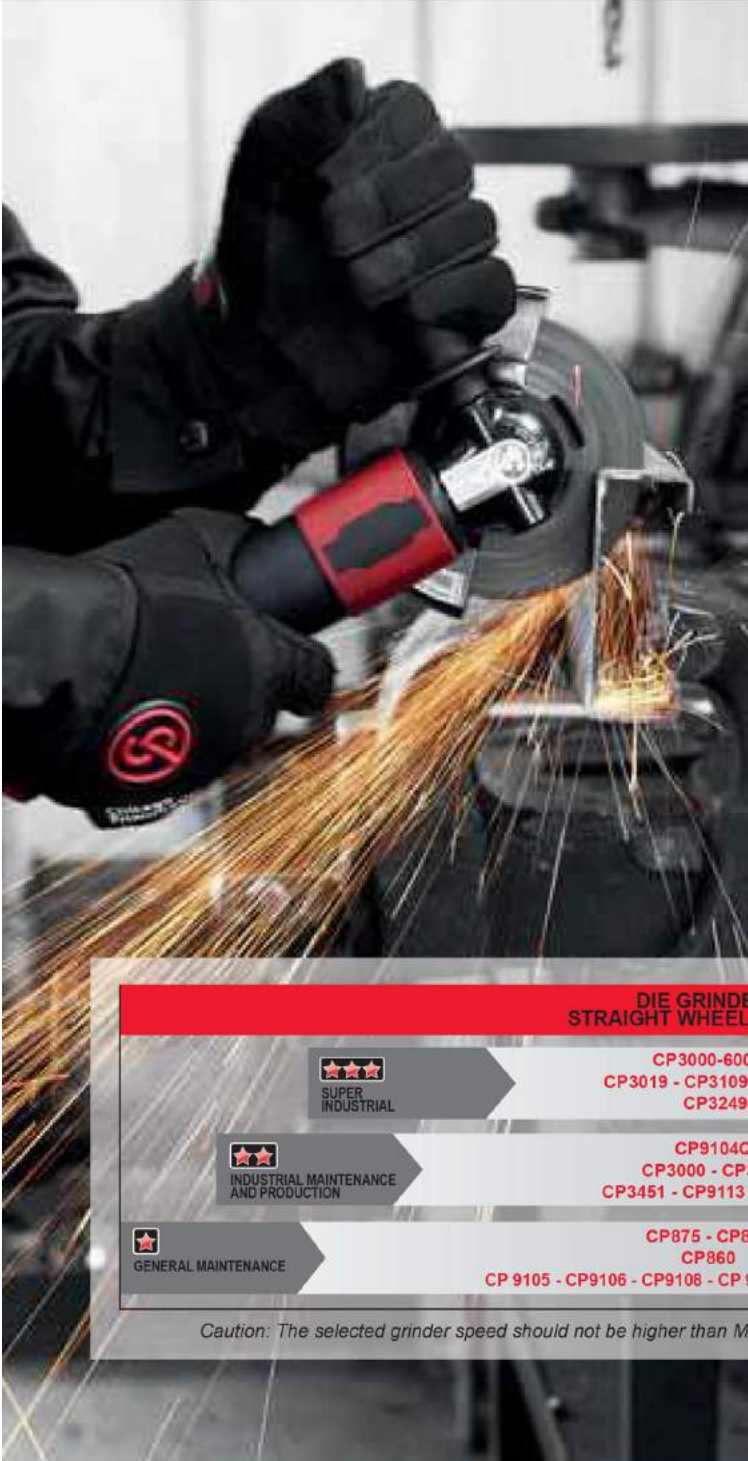

### DIE GRINDERS

For smaller surface applications and/or precision material removal, collet type grinders are preferred for deburring, die countouring, light chamfering.

### WHEEL GRINDERS ANGLE AND VERTICAL GRINDERS

For medium and large surfaces, wheel grinders are designed for grinding, cutting, countouring at a high material removal rate.

**For maximum material removal with minimum effort, choose the best tool.**

#### STEP 1

##### Applications

- ▶ Materials
- ▶ Access
- ▶ Intensity
- ▶ Precision

#### STEP 2

##### Abrasives

- ▶ Carbide burrs
- ▶ Mounted points
- ▶ Grinding wheels
- ▶ Cutting wheels
- ▶ Flap wheels

#### STEP 3

##### Tools

- ▶ Die grinders
- ▶ Angle grinders
- ▶ Vertical grinders
- ▶ Extended shaft grinders

	DIE GRINDERS / STRAIGHT WHEEL GRINDERS	ANGLE GRINDERS / VERTICAL GRINDERS
 SUPER INDUSTRIAL	CP3000-600CR CP3019 - CP3109 - CP3119 CP3249	CP3019 - CP3109 CP3650 - CP3850 CP3349
 INDUSTRIAL MAINTENANCE AND PRODUCTION	CP9104Q CP3000 - CP3030 CP3451 - CP9113 - CP3550	CP3040 - CP3450 CP857 - CP7540 - CP7545 - CP7550 CP3550 - CP3330 - CP3340
 GENERAL MAINTENANCE	CP875 - CP876 CP860 CP 9105 - CP9106 - CP9108 - CP 9110 - CP9111 - CP9112	CP7500 CP854 CP9120 - CP9121 - CP9122 - CP9123

Caution: The selected grinder speed should not be higher than Maximum Operating Speed recommended by abrasive manufacturers

# GRINDING

## ERGONOMIC FEATURES

Chicago Pneumatic Abrasive Tools are designed with advanced ergonomics and features required to enable operators to achieve increased productivity levels:

- Significant sound and vibration reduction - helps reduce operator fatigue and improve performance.
- Complete line - designed for maximum productivity under rugged conditions.
- Wide choice of tools - die grinders, small wheel grinders, horizontal grinders, and vertical grinders.
- Powerful yet lightweight - produces more power per pound than comparable electric models.

- Air powered - Minimal risk of electrical shock or overheating - even with continuous use.

### OTHER FEATURES:

- Rugged construction - to withstand tough use.
- Heat treated internal parts - keep tool operating, minimize repairs.
- Engineered to minimize downtime - simple replacement of rotor blades usually restores original power.
- Wide variety of accessories - Increases productivity, ergonomics, and safety.

## COLLET GRINDERS

Recommended speeds depend on both the shank and head diameter of the carbide burr.

The choice of burr depends on the size of your application. A larger volume of material to be removed will require a larger size abrasive. Select the tool rpm depending on the diameter of the burr head, the material to be ground and the material in the rotary burr. Use tungsten carbide burrs for hard and tough materials. High speed steel burrs are recommended for unhardened and medium hard materials. See table.

MATERIAL TYPE	DIAMETER OF THE HEAD OF THE CARBIDE BURRS				
	1/8" (3 mm)	1/4" (6 mm)	3/8" (10 mm)	1/2" (12 mm)	5/8" (16 mm)
Steel	60,000 - 90,000	45,000 - 60,000	30,000 - 40,000	22,500 - 30,000	18,000 - 24,000
Tempered steel	60,000 - 90,000	30,000 - 45,000	19,000 - 30,000	15,000 - 22,500	12,000 - 18,000
Stainless steel	60,000 - 90,000	30,000 - 45,000	19,000 - 30,000	15,000 - 22,500	12,000 - 18,000
Casting	45,000 - 90,000	22,500 - 60,000	15,000 - 40,000	11,000 - 30,000	9,000 - 24,000
Titanium	60,000 - 90,000	30,000 - 45,000	19,000 - 30,000	15,000 - 22,500	12,000 - 18,000
Nickel	60,000 - 90,000	30,000 - 45,000	19,000 - 30,000	15,000 - 22,500	12,000 - 18,000
Copper & copper alloys	45,000 - 90,000	22,500 - 60,000	15,000 - 40,000	11,000 - 30,000	9,000 - 24,000
Aluminium	30,000 - 90,000	15,000 - 70,000	10,000 - 50,000	7,000 - 3,8000	6,000 - 30,000
Plastics	30,000 - 90,000	15,000 - 70,000	10,000 - 50,000	7,000 - 3,8000	6,000 - 30,000
Cermet	60,000 - 90,000	30,000 - 45,000	19,000 - 30,000	15,000 - 22,500	12,000 - 18,000

Small precision deburring: die grinding is performed with either tungsten carbide, high speed steel burrs or mounted points.



Carbide Burrs

Mounted Points

## WHEEL GRINDERS

Pure material removal, regardless of whether it is removed from a cramped or an open space, is determined by the power generated on the grinding application. The applied feed force and the rotation of the wheel generates a cutting force which when multiplied by the peripheral speed of the wheel, represents the power for removing material (power = peripheral speed x cutting force).

Chicago Pneumatic grinders features a high degree of safety. Safety throttles, over-speed shut-off and wheel guards are good examples of product safety features carried by your grinders.

The table below will help you to translate the peripheral speed of the grinding wheel to the correct rotational speed of the grinder when using a specific diameter of grinding wheel.

DIAMETER IN. (MM)	MAXIMUM WORK SPEED IN M/S OR FEET/MIN							
	32	35	40	50	63	80	100	125
1 (25)	24,450	26,740	30,560	38,200	48,130	61,120	76,390	95,490
1-1/4 (32)	19,100	20,890	23,870	29,840	37,600	47,750	59,680	74,600
1-9/16 (40)	15,280	16,710	19,100	23,870	30,080	38,200	47,750	59,680
2 (50)	1,220	1,3370	15,280	19,100	24,060	30,560	38,200	47,750
2-1/2 (63)	9,700	10,610	12,130	15,160	19,100	24,250	30,320	37,890
3 (75)	7,640	8,360	9,550	11,940	15,040	19,100	23,870	29,840
4 (100)	6,110	6,680	7,640	9,550	12,030	15,280	19,100	23,870
5 (125)	4,890	5,350	6,110	7,640	9,630	12,220	15,280	19,100
6 (150)	4,070	4,460	5,090	6,370	8,020	1,190	12,730	15,920
7 (180)	3,400	3,710	4,240	5,310	6,680	8,490	10,610	13,260
7-7/8 (200)	3,060	3,340	3,820	4,780	6,020	7,640	9,550	11,940
9 (230)	2,660	2,910	3,320	5,150	5,230	6,640	8,300	10,380
9-27/32 (250)	2,440	2,670	3,060	3,820	4,810	6,110	7,640	9,550
11-13/16 (300)	2,040	2,230	2,550	3,180	4,010	5,090	6,370	7,960

### HOW ENSURE SAFE OPERATION:

- Check the tool free speed
- Match the maximum speed of the abrasive to the grinder
- Inspect the grinding wheel
- Inspect the flange
- Inspect the wheel guard
- Wear protection goggles, gloves & hearing protection
- Test run your grinder in a protected area after assembling the wheel
- Make sure that the tools receive proper maintenance, see service sheet
- Disconnect the tool from the air network before changing accessories abrasives.



## < 0.12 hp (90 W) Die Grinders

### CP9104Q

60,000 RPM



### CP9104Q K

See details on page 95

### HIGH-SPEED FOR PRECISION WORK



#### FEATURES

- Includes 1/8", 3mm collet
- Very low noise level: only 71 dB(A)
- Includes silencer hose

#### BENEFITS

- General maintenance application
- Easy to handle
- Quiet and lightweight



### CP3000-600CR

60,000 RPM



### HIGH SPEED & DURABLE BODY



### FEATURES

- 1/8" collet - Product for imperial system only
- Steel but lightweight body
- Included silencer hose

### BENEFITS

- Industrial Production applications pencil grinder
- Great durability
- Operator comfort





### CP3000-600CR

### CP3000-600CR

Same features as CP3000-600CR 1/8, with 3 mm collet capacity



See accessories on pages 92-97

 GENERAL MAINTENANCE  INDUSTRIAL MAINTENANCE & PRODUCTION  SUPER INDUSTRIAL

MODEL	PART NUMBER	FREE SPEED		POWER		COLLET CAPACITY		AIR CONS. @LOAD		NET WEIGHT		LENGTH		VIBRATION LEVEL ISO 28927 (m/s <sup>2</sup> )		SOUND PRESS. ISO 15744 - dB(A)	SOUND POWER	AIR INLET
		rpm		hp	W	in.	mm	cfm	l/s	lb	kg	in.	mm	a	k			
CP9104Q	615 195 9104	60,000		0.05	40	1/8	3	7	3.2	0.5	0.2	5.2	133	<2.5	-	71	82	1/4
CP3000-600CR	615 160 0140	60,000		0.12	90	1/8	3.2	5.5	2.6	0.3	0.1	6	153	<2.5	-	71	82	1/4
CP3000-600CR	615 160 0330	60,000		0.12	90	-	3	5.5	2.6	0.3	0.1	6	153	<2.5	-	71	82	1/4

All models: Hose int. 3/8" (10mm) - @90 PSI (@6.3 Bar)

Listed specifications are for reference only. Please check documents in each tool.



# GRINDING

<0.47 hp (350 W) Die Grinders

## The CP91 Series Benefits

- General maintenance application
- High operator comfort
- Power and performance
- Ideal for limited space applications

### CP9105Q-B 28,000 RPM



#### QUIET & EFFICIENT

##### FEATURES

- Rubber overmould grip
- Swivel air inlet
- Built-in air regulator

### CP9106Q-B

Same features as CP9105Q-B with 23,000 rpm and 90° angle head



### CP9108Q-B

Same features as CP9105Q-B with 23,000 rpm and 120° angle head



### CP9110Q-B

Same features as CP9105Q-B with 27,000 rpm and with extended shaft



### CP9111Q-B 22,000 RPM



#### POWERFUL & QUIET

##### FEATURES

- Rubber overmould grip
- Swivel air inlet
- Built-in air regulator

### CP9112Q-B

Same features as CP9111Q-B with extended shaft

### CP9111Q-B Kit Metric

See details on page 95



CP9108Q-B



See accessories on pages 92-97

 GENERAL MAINTENANCE  INDUSTRIAL MAINTENANCE & PRODUCTION  SUPER INDUSTRIAL

MODEL	PART NUMBER	FREE SPEED		POWER		COLLET CAPACITY		AIR CONS. @LOAD		NET WEIGHT		LENGTH		VIBRATION LEVEL ISO 28927 (m/s <sup>2</sup> )		SOUND PRESS. ISO 15744 - dB(A)	SOUND POWER	AIR INLET
		rpm	hp	W	in.	mm	cfm	l/s	lb	kg	in.	mm	a	k				
CP9105Q-B	615 195 2105	28,000	0.32	240	1/4	6.35	8.7	4.1	0.8	0.4	6.3	160	3.6	2.0	80	91	1/4	
CP9106Q-B	615 195 2106	23,000	0.32	240	1/4	6.35	8.7	4.1	1.5	0.7	6.5	165	5.1	2.6	80	91	1/4	
CP9108Q-B	615 195 2108	23,000	0.32	240	1/4	6	8.7	4.1	1.1	0.5	7.9	200	5.1	1.6	80	91	1/4	
CP9110Q-B	615 195 2110	27,000	0.32	240	1/4	6	8.7	4.1	1.5	0.7	10.2	260	4.9	2.5	80	91	1/4	
CP9111Q-B	615 195 2111	22,000	0.47	350	1/4	6	8.7	4.1	1.5	0.7	6.3	160	3.7	1.6	80	91	1/4	
CP9112Q-B	615 195 2112	22,000	0.47	350	1/4	6	8.7	4.1	2.9	1.3	13.4	340	2.7	1.2	80	91	1/4	

All models: Hose int. 3/8" (10mm) - @90 PSI (@6.3 Bar)

Listed specifications are for reference only. Please check documents in each product.



## < 0.54 hp (400 W) Die Grinders

### CP875 ★

22,500 RPM



#### COMPACT ANGLE DIE GRINDER

#### CP875 K

See details on page 95



#### FEATURES

- Includes 1/4" and 6 mm collet
- 90° angle head allows flexibility in tight areas
- Built-in air regulator

#### CP876

Same features as CP875 with 30000 rpm and straight body



#### BENEFITS

- General maintenance applications
- Compact and lightweight tool designed for easy maneuverability
- Ideal for limited space applications

### CP860 ★

24,000 RPM



#### GREAT DURABILITY

#### CP860E

Same features as CP860 with 6 mm collet

#### FEATURES

- 1/4" collet
- Rugged and energy efficient 0.54 hp (400 W) motor
- Adjustable speed regulator

#### CP860ES

Same features as CP860 with 6" extended shaft

#### BENEFITS

- General maintenance applications
- Productivity and control
- Excellent for cleaning tires, moldings, porting, relieving engines, and general high-speed polishing and grinding

#### CP860ESE

Same features as CP860E with 6" extended shaft and 6 mm collet



CP860



See accessories on pages 92-97

★ GENERAL MAINTENANCE    ★★ INDUSTRIAL MAINTENANCE & PRODUCTION    ★★★ SUPER INDUSTRIAL

MODEL	PART NUMBER	FREE SPEED		POWER		COLLET CAPACITY		AIR CONS. @LOAD		NET WEIGHT		LENGTH		VIBRATION LEVEL ISO 28927 (m/s <sup>2</sup> )		SOUND PRESS.	SOUND POWER	AIR INLET
		rpm		hp	W	in.	mm	cfm	l/s	lb	kg	in.	mm	a	k	ISO 15744 - dB(A)		in.
CP875	T023995	22,500		0.3	220	1/4	6	22	10.4	1.0	0.5	4.9	124	4.4	1.9	101	112	1/4
CP876	T023996	30,000		0.3	220	1/4	6	24	11.3	0.8	0.3	4.8	121	<2.5	-	101	112	1/4
CP860	T019704	24,000		0.54	400	1/4	6.35	21	9.9	1.3	0.6	5.8	146	3.7	1.6	93	104	1/4
CP860E	T021136	24,000		0.54	400		6	21	9.9	1.3	0.6	5.8	146	3.7	1.6	93	104	1/4
CP860ES	T023193	24,000		0.54	400	1/4	-	23.1	10.9	2.1	1.0	11.8	294	3.7	1.5	93	104	1/4
CP860ESE	T023354	24,000		0.54	400		6	23.1	10.9	2.1	1.0	11.8	294	3.7	1.5	93	104	1/4

All models: Hose int. 3/8" (10mm) - @90 PSI (@6.3 Bar)

Listed specifications are for reference only. Please check documents in each tool.



# GRINDING

## <0.7 hp (500 W) Die Grinders The CP3000 Series Benefits

### LIGHTWEIGHT & ERGONOMIC

- Industrial die grinder
- Industrial grade durability up to 1,000 hours between maintenance intervals
- Operator comfort

### CP3000-325R 25,000 RPM

#### FEATURES

- Compact composite handle
- Streamlined safety lever
- Rear Exhaust



### CP3000-325R

#### CP3000-330R

Same features as CP3000-325R with 30,000 rpm

#### CP3000-325F/330F

Same features as CP3000-325R with 25,000, 30,000 rpm and Front exhaust. **NOT FOR CE MARKET**



### CP3000-420R

20,000 RPM



#### CP3000-415R/418R/424R

Same features as CP3000-420R with respectively 15,000 - 18,000 - 24,000 rpm

#### FEATURES

- Compact composite handle
- Streamlined safety lever
- Rear Exhaust

#### CP3000-418F/420F/424F

Same features as CP3000-420R with same speeds and Front exhaust.

**NOT FOR CE MARKET**

### CP3000-520R

20,000 RPM



#### CP3000-515R/518R

Same features as CP3000-520R with respectively 15,000 - 18,000 rpm

#### FEATURES

- Compact composite handle
- Streamlined safety lever
- Front Exhaust

 GENERAL MAINTENANCE  INDUSTRIAL MAINTENANCE & PRODUCTION  SUPER INDUSTRIAL

MODEL	PART NUMBER	FREE SPEED		POWER		COLLET CAPACITY		AIR CONS. @LOAD		NET WEIGHT		LENGTH		VIBRATION LEVEL ISO 28927 (m/s <sup>2</sup> )		SOUND PRESS. ISO 15744 - dB(A)	SOUND POWER	AIR INLET
		rpm	hp	W	in.	mm	cfm	l/s	lb	kg	in.	mm	a	k				
CP3000-325F	615 160 0180	25,000	0.4	300	1/4	6.35	17.2	8.1	0.9	0.4	5.9	150	<2.5	-	84	95	1/4	
CP3000-325R	615 160 0150	25,000	0.4	300	1/4	6.35	19.1	9	0.9	0.4	5.9	150	3.2	1.6	79	90	1/4	
CP3000-330R	615 160 0160	30,000	0.4	300	1/4	6.35	19.1	9	0.9	0.4	5.9	150	<2.5	-	78	89	1/4	
CP3000-415R	615 160 0190	15,000	0.54	400	1/4	6.35	21.2	10	1.7	0.8	7.7	196	<2.5	-	80	91	1/4	
CP3000-418R	615 160 0200	18,000	0.54	400	1/4	6.35	21.2	10	1.7	0.8	7.7	196	<2.5	-	77	88	1/4	
CP3000-420F	615 160 0250	20,000	0.54	400	1/4	6.35	22	10.4	1.7	0.8	7.7	196	<2.5	-	82	93	1/4	
CP3000-420R	615 160 0210	20,000	0.54	400	1/4	6.35	23.3	11	1.7	0.8	7.7	196	<2.5	-	78	89	1/4	
CP3000-424F	615 160 0260	24,000	0.54	400	1/4	6.35	24	11.3	1.7	0.8	7.7	196	<2.5	-	82	93	1/4	
CP3000-424R	615 160 0220	24,000	0.54	400	1/4	6.35	23.3	11	1.7	0.8	7.7	196	<2.5	-	79	90	1/4	
CP3000-515R	615 160 0270	15,000	0.7	500	1/4	6.35	25.4	12	1.9	0.9	7.6	195	<2.5	-	81	92	1/4	
CP3000-518R	615 160 0280	18,000	0.7	500	1/4	6.35	27.6	13	1.9	0.9	7.6	195	<2.5	-	80	91	1/4	
CP3000-520R	615 160 0290	20,000	0.7	500	1/4	6.35	27.6	13	1.9	0.9	7.6	195	<2.5	-	81	92	1/4	

All models: Hose int. 3/8" (9.5 mm) - @90 PSI (@6.3 Bar)

Listed specifications are for reference only. Please check documents in each tool



# < 0.7 hp (500 W) Die Grinders

## The CP3030 Series Benefits

### LIGHTWEIGHT & ERGONOMIC

- Industrial die grinder
- Industrial grade durability up to 1,000 hours between maintenance intervals
- Operator comfort

### CP3030-420R 20,000 RPM



- FEATURES**
- Streamlined safety lever
  - Rear Exhaust
  - Gearless durable construction

**CP3030-418R/424R**  
Same features as CP3030-420R with respectively 18,000 - 24,000 rpm

**CP3030-420F/424F**  
Same features as CP3030-420R with same speeds and Front exhaust.  
**NOT FOR CE MARKET**

### CP3030-520R 20,000 RPM



- FEATURES**
- Streamlined safety lever
  - Rear Exhaust
  - Gearless durable construction

**CP3030-518R**  
Same features as CP3030-520R with 18,000 rpm



### CP3030-325R 25,000 RPM



### FEATURES

- Streamlined safety lever
- Rear Exhaust
- Gearless durable construction



### CP3030-325R

**CP3030-330R**  
Same features as CP3030-325R with 30,000 rpm

**CP3030-325F/330F**  
Same features as CP3030-325R with 25,000, 30,000 rpm and Front exhaust.  
**NOT FOR CE MARKET**

 GENERAL MAINTENANCE  INDUSTRIAL MAINTENANCE & PRODUCTION  SUPER INDUSTRIAL

MODEL	PART NUMBER	FREE SPEED		POWER		COLLET CAPACITY		AIR CONS. @LOAD		NET WEIGHT		LENGTH		VIBRATION LEVEL ISO 28927 (m/s <sup>2</sup> )		SOUND PRESS.	SOUND POWER	AIR INLET
		rpm		hp	W	in.	mm	cfm	l/s	lb	kg	in.	mm	a	k	ISO 15744 - dB(A)		in.
CP3030-325F	615 160 4120	25,000		0.4	300	1/4	6.35	16.3	7.7	1.1	0.5	6.1	154	<2.5	-	85	96	1/4
CP3030-325R	615 160 4090	25,000		0.4	300	1/4	6.35	17	8	1.1	0.5	6.1	154	<2.5	-	80	91	1/4
CP3030-330F	615 160 4110	30,000		0.4	300	1/4	6.35	17.6	8.3	1.1	0.5	6.1	154	<2.5	-	84	95	1/4
CP3030-330R	615 160 4100	30,000		0.4	300	1/4	6.35	19.1	9	1.1	0.5	6.1	154	<2.5	-	77	88	1/4
CP3030-418R	615 160 4130	18,000		0.54	400	1/4	6.35	21.2	10	1.8	0.8	6.8	174	<2.5	-	75	86	1/4
CP3030-420F	615 160 4170	20,000		0.54	400	1/4	6.35	21.4	10.1	1.8	0.8	6.8	174	<2.5	-	82	93	1/4
CP3030-420R	615 160 4140	20,000		0.54	400	1/4	6.35	23.3	11	1.8	0.8	6.8	174	<2.5	-	76	87	1/4
CP3030-424F	615 160 4180	24,000		0.54	400	1/4	6.35	23.1	10.9	1.8	0.8	6.8	174	<2.5	-	82	93	1/4
CP3030-424R	615 160 4150	24,000		0.54	400	1/4	6.35	23.3	11	1.8	0.8	6.8	174	<2.5	-	78	89	1/4
CP3030-518R	615 160 4190	18,000		0.7	500	1/4	6.35	27.6	13	1.9	0.9	6.8	174	<2.5	-	80	91	1/4
CP3030-520R	615 160 4200	20,000		0.7	500	1/4	6.35	29.7	14	1.9	0.9	6.8	174	<2.5	-	80	91	1/4

All models: Hose int. 3/8" (9.5 mm) - @90 PSI (@6.3 Bar)

Listed specifications are for reference only. Please check documents in each tool



# GRINDING

## <0.5 hp (375 W) Die Grinders The CP3019 Series Benefits

### HIGH PERFORMANCE IN A COMPACT PACKAGE

- Industrial angle die grinder
- Optimal productivity
- Highest durability in demanding applications up to 2000 hours maintenance intervals

### CP3019-31ES 31,000 RPM

#### FEATURES

- Compact body
- Insulating composite over-housing
- Streamlined safety lever



### CP3019-31ES

#### CP3019-20ES/25ES/40ES

Same features as CP3019-31ES with 20,000 - 25,000 - 40,000 rpm

#### CP3019-20ES/25ES/40ES CNOMO

Same features as CP3019-31ES with 20,000 - 25,000 - 40,000 rpm and 6 mm CNOMO collet



CP3019-31

### CP3019-31 31,000 RPM



#### FEATURES

- Compact body
- Insulating composite over-housing
- Streamlined safety lever

#### CP3019-18/20/25/40

Same features as CP3019-31 with respectively 18,000 - 20,000 - 25,000 - 40,000 rpm

#### CP3019-20/25/31/40 CNOMO

Same features as CP3019-31 with 20,000 - 25,000 - 31,000 - 40,000 rpm and 6 mm CNOMO collet

### CP3019-12AC 12,000 RPM



#### FEATURES

- Compact body
- Insulating composite over-housing
- Streamlined safety lever

#### CP3019-20AC

Same features as CP3019-12AC with 20,000 rpm

#### CP3019-12AC/20AC CNOMO

Same features as CP3019-12AC with 12,000 - 20,000 rpm and 6 mm CNOMO collet

MODEL	PART NUMBER	FREE SPEED		POWER		COLLET CAPACITY		AIR CONS. @LOAD		NET WEIGHT		LENGTH		VIBRATION LEVEL ISO 28927 (m/s <sup>2</sup> )		SOUND PRESS.	SOUND POWER	AIR INLET
		rpm	hp	W	in.	mm	cfm	ls	lb	kg	in.	mm	a	k	ISO 15744 - dB(A)	(A)	in.	
CP3019-12AC	615 160 4070	12,000	0.5	375	1/4	6.35	17	8	1.1	0.5	8.5	216	3.7	1.9	78	89	1/4	
CP3019-20AC	615 160 4080	20,000	0.5	375	1/4	6.35	19.9	9.4	1.1	0.5	8.5	216	4.3	3.4	82	93	1/4	
CP3019-18	615 160 0090	18,000	0.5	375	1/4	6.35	15.1	7.1	0.8	0.4	6.7	169	<2.5	-	76	87	1/4	
CP3019-20	615 160 0100	20,000	0.5	375	1/4	6.35	19.1	9	0.8	0.4	6.7	169	4.1	1.5	75	86	1/4	
CP3019-25	615 160 0110	25,000	0.5	375	1/4	6.35	19.1	9	0.8	0.4	6.6	169	2.6	1.5	78	89	1/4	
CP3019-31	615 160 0120	31,000	0.5	375	1/4	6.35	21.2	10	0.8	0.4	6.6	169	3.3	2.0	79	90	1/4	
CP3019-40	615 160 0130	40,000	0.5	375	1/4	6.35	22	10.4	0.8	0.4	6.6	169	<2.5	-	81	92	1/4	
CP3019-20ES	615 160 2170	20,000	0.5	375	1/4	6.35	18	8.5	1.2	0.6	9.8	249	3.7	1.9	74	85	1/4	
CP3019-25ES	615 160 2180	25,000	0.5	375	1/4	6.35	19.1	9	1.2	0.6	9.8	249	3.2	1.7	77	88	1/4	
CP3019-31ES	615 160 2190	31,000	0.5	375	1/4	6.35	19.9	9.4	1.2	0.6	9.8	249	3.6	1.6	81	92	1/4	
CP3019-40ES	615 160 2200	40,000	0.5	375	1/4	6.35	21.2	10	1.2	0.6	9.8	249	3	2.0	80	91	1/4	
CP3019-20 CNOMO	615 160 0340	20,000	0.5	375	-	6	19.1	9	0.8	0.4	6.7	169	<2.5	-	74	85	1/4	
CP3019-25 CNOMO	615 160 0350	25,000	0.5	375	-	6	19.1	9	0.8	0.4	6.7	169	<2.5	-	78	89	1/4	
CP3019-31 CNOMO	615 160 0360	31,000	0.5	375	-	6	21.2	10	0.8	0.4	6.7	169	2.8	2.0	77	88	1/4	
CP3019-40 CNOMO	615 160 0370	40,000	0.5	375	-	6	22	10.4	0.8	0.4	6.7	169	2.8	1.4	77	88	1/4	
CP3019-20ES CNOMO	615 160 2210	20,000	0.5	375	-	6	18	8.5	1.2	0.6	9.8	249	2.9	0.9	75	86	1/4	
CP3019-25ES CNOMO	615 160 2220	25,000	0.5	375	-	6	19.1	9	1.2	0.6	9.8	249	4.7	2.4	78	89	1/4	
CP3019-31ES CNOMO	615 160 2230	31,000	0.5	375	-	6	19.9	9.4	1.2	0.6	9.8	249	<2.5	-	80	91	1/4	
CP3019-40ES CNOMO	615 160 2240	40,000	0.5	375	-	6	21.2	10	1.2	0.6	9.8	249	<2.5	-	78	89	1/4	
CP3019-12AC CNOMO	615 160 4230	12,000	0.5	375	-	6	17	8	1.1	0.5	8.5	216	3.7	1.9	78	89	1/4	
CP3019-20AC CNOMO	615 160 4240	20,000	0.5	375	-	6	19.9	9.4	1.1	0.5	8.5	216	4.3	3.4	82	93	1/4	

All models: Hose int. 3/8" (10mm) - @90 PSI (@6.3 Bar)

Listed specifications are for reference only. Please check documents in e





## 1 hp (750 W) Die Grinders

**CP9113G** ★★

25,000 RPM



### ROBUST STEEL CONSTRUCTION

#### FEATURES

- Robust machined steel housing
- Robust safety lever
- Front exhaust

#### BENEFITS

- Industrial die grinder
- High body durability
- Designed for rough use

**CP3451-18SEC** ★★

18,000 RPM



**CP3451-18SERC**

Same features as CP3451-18SEC with rotative valve

NOT FOR CE / NA MARKETS



### INDUSTRIAL GRADE EXTENDED SHAFT DIE GRINDER

#### FEATURES

- Aluminum body
- Insulating composite cover
- Rear exhaust

#### BENEFITS

- Industrial straight die grinder
- Light body
- Industrial grade durability up to 1000 hours



CP3451-18SEC

**CP9113GES** ★★

25,000 RPM

### ROBUST STEEL CONSTRUCTION



### FEATURES

- Robust machined steel housing
- Robust safety lever
- Side exhaust

### BENEFITS

- Industrial extended shaft die grinder
- High body durability
- Designed for rough use



CP9113GES



See accessories on pages 92-97

★ GENERAL MAINTENANCE   ★★ INDUSTRIAL MAINTENANCE & PRODUCTION   ★★★ SUPER INDUSTRIAL

MODEL	PART NUMBER	FREE SPEED		POWER		COLLET CAPACITY		AIR CONS. @LOAD		NET WEIGHT		LENGTH		VIBRATION LEVEL ISO 28927 (m/s <sup>2</sup> )		SOUND PRESS. ISO 15744 - dB(A)	SOUND POWER	AIR INLET
		rpm	hp	W	in.	mm	cfm	l/s	lb	kg	in.	mm	a	k	in.			
CP3451-18SEC	615 160 2010	18,000	1	750	1/4	6.35	36.9	17.4	3.1	1.4	13	330	2.7	1.8	84	95	3/8	
CP3451-18SERC	615 160 2040	18,000	1	750	1/4	6.35	36.9	17.4	3.1	1.4	13	330	2.7	1.8	84	95	3/8	
CP9113G	615 160 0010	25,000	1	750	1/4	6.35	31.8	15	2.5	1.2	6.7	170	3.6	1.8	93	104	3/8	
CP9113GES	615 160 2070	25,000	1	750	1/4	6.35	31.8	15	3.5	1.6	12.6	320	2.7	1.1	83	94	3/8	

All models: Hose int. 1/2" (13mm) - @90 PSI (@6.3 Bar)

Listed specifications are for reference only. Please check documents in each tool



# GRINDING

**CP3109-24** 

24,000 RPM



## HIGH PERFORMANCE

### FEATURES

- Steel housing
- Insulating composite over-housing
- Streamlined safety lever

### BENEFITS

- Industrial die grinder
- High productivity
- Highest durability in demanding applications with up to 2000 hrs between maintenance intervals



**CP3109-24**

**CP3109-28**

Same features as CP3109-24 with 28,000 rpm



**CP3109-28ES**

Same features as CP3109-24 with 28,000 rpm and extended shaft

## 0.8 hp (600 W) Die Grinders

**CP3109-19** 

19,000 RPM



## HIGH PERFORMANCE

### FEATURES

- Steel housing
- Insulating composite over-housing
- Streamlined safety lever

### BENEFITS

- Industrial die grinder
- High productivity
- Highest durability in demanding applications up to 2000 hours maintenance intervals

**CP3109-19ES**

Same features as CP3109-19 with extended shaft

**CP3109-24ES** 

24,000 RPM



## HIGH PERFORMANCE

### FEATURES

- Steel housing
- Insulating composite over-housing
- Extended body with rubber grip

### BENEFITS

- Industrial extended shaft die grinder
- High productivity
- Highest durability in demanding applications up to 2000 hours maintenance intervals



See accessories on pages 92-97

 GENERAL MAINTENANCE  INDUSTRIAL MAINTENANCE & PRODUCTION  SUPER INDUSTRIAL

MODEL	PART NUMBER	FREE SPEED		POWER		COLLET CAPACITY		AIR CONS. @LOAD		NET WEIGHT		LENGTH		VIBRATION LEVEL ISO 28927 (m/s <sup>2</sup> )		SOUND PRESS. ISO 15744 - dB(A)	SOUND POWER	AIR INLET
		rpm	hp	W	in.	mm	cfm	l/s	lb	kg	in.	mm	a	k				
<b>CP3109-19</b>	<b>615 160 0020</b>	19,000	0.8	600	1/4	6.35	31.8	15	2.0	0.9	8.8	222	3.0	1.8	76	87	3/8	
<b>CP3109-19ES</b>	<b>615 160 2080</b>	19,000	0.8	600	1/4	6.35	31.8	15	2.9	1.3	14.5	363	<2.5	-	76	87	3/8	
<b>CP3109-24</b>	<b>615 160 0030</b>	24,000	0.8	600	1/4	6.35	31.8	15	2.0	0.9	8.8	222	<2.5	-	81	92	3/8	
<b>CP3109-24ES</b>	<b>615 160 2090</b>	24,000	0.8	600	1/4	6.35	31.8	15	2.9	1.3	14.2	361	<2.5	-	81	92	3/8	
<b>CP3109-28</b>	<b>615 160 0040</b>	28,000	0.8	600	1/4	6.35	31.8	15	2.0	0.9	8.8	222	<2.5	-	85	96	3/8	
<b>CP3109-28ES</b>	<b>615 160 2100</b>	28,000	0.8	600	1/4	6.35	31.8	15	2.9	1.3	14.2	361	<2.5	-	85	96	3/8	

All models: Hose int. 1/2" (13mm) - @90 PSI (@6.3 Bar)

Listed specifications are for reference only. Please check documents in each tool.



0.8 to 2.4 hp (600 to 1,800 W) Die Grinders

**CP3550-120AC** ★★ ★

12,000 RPM



**INDUSTRIAL PRODUCTIVITY & ERGONOMICS**

**FEATURES**

- 1.5 hp (1,100 W) governed motor
- Durable bevel gear
- Spindle lock button

**BENEFITS**

- Industrial angle die grinder
- Industrial grade durability with up to a 1,000 hour maintenance interval
- Superior torque for maximal productivity

To learn more about CP3550 series please refer p104

**CP3109-13AC** ★★ ★

13,000 RPM



**HIGH PERFORMANCE**

**FEATURES**

- Insulating composite over-housing
- Streamlined safety lever
- Highly durable bevel gear

**BENEFITS**

- Industrial die grinder
- Optimal productivity
- Highest durability in demanding applications with up to 2,000 hours between maintenance intervals

**CP3650-120ACC**

12,000 RPM



**SUPERIOR PERFORMANCE & ERGONOMICS**

**FEATURES**

- 2.4 hp (1,800 W) high performance governed motor
- Superior durability bevel gear
- Streamlined safety lever

**BENEFITS**

- Highest durability in demanding applications up to 2000 hours
- Superior torque for maximal productivity
- Superior ergonomics



To learn more about CP3650 series please refer p106



See accessories on pages 92-97

★ GENERAL MAINTENANCE   ★★ INDUSTRIAL MAINTENANCE & PRODUCTION   ★★★

MODEL	PART NUMBER	FREE SPEED		POWER		COLLET CAPACITY		AIR CONS. @LOAD		NET WEIGHT		LENGTH		VIBRATION LEVEL ISO 28927 (m/s <sup>2</sup> )		SOUND PRESS.	SOUND POWER	AIR INLET
		rpm		hp	W	in.	mm	cfm	l/s	lb	kg	in.	mm	a	k	ISO 15744 - dB(A)		in.
<b>CP3109-13AC</b>	<b>615 160 4060</b>	13,000		0.8	600	1/4	6.35	31.8	15	2.4	1.1	8.6	216	3.7	1.4	85	96	3/8
<b>CP3550-120AC</b>	<b>615 160 7750</b>	12,000		1.5	1100	1/4	6.35	56	26	3.2	1.5	9.8	249	6.1	7.3	84	95	3/8
<b>CP3650-120ACC</b>	<b>615 160 7230</b>	12,000		2.4	1800	1/4	6.35	68	32	3.1	1.4	9.4	238	7.5	2.5	82	93	3/8

All models: Hose int. 1/2" (13mm) - @90 PSI (@6.3 Bar)

Listed specifications are for reference only. Please check documents in each tool



# GRINDING

1.2 hp (900 W) Die Grinders

## The CP3119 Series Benefits

### HIGH PERFORMANCE

- Industrial
- High productivity
- Highest durability in demanding applications up to 2000 hours maintenance intervals

**CP3119-22ES**  22,000 RPM

### FEATURES

- Steel housing
- Insulating composite over-housing
- Extended body with rubber grip



**CP3119-22ES**

**CP3119-12ES/15ES/18ES/22ES**

Same features as CP3119-22ES with 12,000 - 15,000 - 18,000 - 22,000 rpm

**CP3119-12ES/15ES/18ES/22ES CNOMO**

Same features as CP3119-22ES with 12,000 - 15,000 - 18,000 - 22,000 rpm and 6 mm CNOMO collet



See accessories on pages 92-97

**CP3119-22** 

22,000 RPM



### FEATURES

- Steel housing
- Insulating composite over-housing
- Streamlined safety lever

**CP3119-12/15/18**



Same features as CP3119-22 with 12,000 - 15,000 - 18,000 rpm

**CP3119-12/15/18/22 CNOMO**

Same features as CP3119-22 with 12,000 - 15,000 - 18,000 - 22,000 rpm and 6 mm CNOMO collet



**CP3119-22ES**

 GENERAL MAINTENANCE  INDUSTRIAL MAINTENANCE & PRODUCTION  SUPER INDUSTRIAL

MODEL	PART NUMBER	FREE SPEED		POWER		COLLET CAPACITY		AIR CONS. @LOAD		NET WEIGHT		LENGTH		VIBRATION LEVEL ISO 28927 (m/s <sup>2</sup> )		SOUND PRESS. ISO 15744 - dB(A)	SOUND POWER	AIR INLET
		rpm		hp	W	in.	mm	cfm	l/s	lb	kg	in.	mm	a	k			
<b>CP 3119-12</b>	<b>6 15 16 0 0050</b>	12,000		1.2	900	1/4	6.35	33.9	16	2.2	1.0	8.8	222	<2.5	-	76	87	3/8
<b>CP 3119-12ES</b>	<b>6 15 16 0 2110</b>	12,000		1.2	900	1/4	6.35	33.9	16	3.1	1.4	14.2	361	<2.5	-	76	87	3/8
<b>CP 3119-15</b>	<b>6 15 16 0 0060</b>	15,000		1.2	900	1/4	6.35	36	17	1.2	1.0	8.8	222	3.8	2.2	81	92	3/8
<b>CP 3119-15ES</b>	<b>6 15 16 0 2120</b>	15,000		1.2	900	1/4	6.35	36	17	3.1	1.4	14.2	361	<2.5	-	81	92	3/8
<b>CP 3119-18</b>	<b>6 15 16 0 0070</b>	18,000		1.2	900	1/4	6.35	38.2	18	2.2	1.0	8.8	222	2.9	1.8	80	91	3/8
<b>CP 3119-18ES</b>	<b>6 15 16 0 2130</b>	18,000		1.2	900	1/4	6.35	38.2	18	3.1	1.4	14.2	361	<2.5	-	80	91	3/8
<b>CP 3119-22</b>	<b>6 15 16 0 0080</b>	22,000		1.2	900	1/4	6.35	38.2	18	2.2	1.0	8.8	222	<2.5	-	81	92	3/8
<b>CP 3119-22ES</b>	<b>6 15 16 0 2140</b>	22,000		1.2	900	1/4	6.35	38.2	18	3.1	1.4	14.2	361	2.6	0.8	81	92	3/8
<b>CP 3119-12 CNOMO</b>	<b>6 15 16 0 0380</b>	12,000		1.2	900	-	6	33.9	16	2.2	1.0	8.7	222	<2.5	-	75	86	3/8
<b>CP 3119-12ES CNOMO</b>	<b>6 15 16 0 2250</b>	12,000		1.2	900	-	6	33.9	16	3.1	1.4	14.3	363	2.7	-	76	87	3/8
<b>CP 3119-15 CNOMO</b>	<b>6 15 16 0 0390</b>	15,000		1.2	900	-	6	36	17	2.2	1.0	8.7	222	<2.5	-	80	91	3/8
<b>CP 3119-15ES CNOMO</b>	<b>6 15 16 0 2260</b>	15,000		1.2	900	-	6	36	17	3.1	1.4	14.3	363	<2.5	-	81	92	3/8
<b>CP 3119-18 CNOMO</b>	<b>6 15 16 0 0400</b>	18,000		1.2	900	-	6	38.2	18	2.2	1.0	8.7	222	<2.5	-	81	92	3/8
<b>CP 3119-18ES CNOMO</b>	<b>6 15 16 0 2270</b>	18,000		1.2	900	-	6	38.2	18	3.1	1.4	14.3	363	<2.5	-	80	91	3/8
<b>CP 3119-22 CNOMO</b>	<b>6 15 16 0 0410</b>	22,000		1.2	900	-	6	38.2	18	2.2	1.0	8.7	222	<2.5	-	81	92	3/8
<b>CP 3119-22ES CNOMO</b>	<b>6 15 16 0 2280</b>	22,000		1.2	900	-	6	38.2	18	3.1	1.4	14.3	363	<2.5	-	81	92	3/8

All models: Hose Int. 1/2" (13mm) - @90 PSI (@6.3 Bar)

Listed specifications are for reference only. Please check documents in each tool.



## 1.2 hp (900 W) Long Reach Die Grinders

**CP3119-12EL** 

12,000 RPM



### HIGH PERFORMANCE

#### FEATURES

- 23.7" (603 mm) extended body with one piece steel structure
- Steel housing
- Insulating composite over-housing

#### BENEFITS

- Industrial extended shaft long die grinder
- High productivity
- Highest durability in demanding applications with up to 2000 hrs between maintenance intervals



CP3119-12EL

**CP3119-12EXL** 

12,000 RPM



### HIGH PERFORMANCE

### FEATURES

- 33.6" (853 mm) extended body with one piece steel structure
- Steel construction
- Insulating composite over-housing

### BENEFITS

- Industrial extended shaft long die grinder
- High productivity
- Highest durability in demanding applications with up to 2000 hrs between maintenance intervals



CP3119-12EXL



See accessories on pages 92-97

 GENERAL MAINTENANCE  INDUSTRIAL MAINTENANCE & PRODUCTION  SUPER INDUSTRIAL

MODEL	PART NUMBER	FREE SPEED		POWER		COLLET CAPACITY		AIR CONS. @LOAD		NET WEIGHT		LENGTH		VIBRATION LEVEL ISO 28927 (m/s <sup>2</sup> )		SOUND PRESS. ISO 15744 - dB(A)	SOUND POWER	AIR INLET
		rpm		hp	W	in.	mm	cfm	l/s	lb	kg	in.	mm	a	k			
CP3119-12EL	615 160 2150	12,000		1.2	900	1/4	6.35	33.9	16	4.6	2.1	23.7	603	3	1.3	74	85	3/8
CP3119-12EXL	615 160 2160	12,000		1.2	900	1/4	6.35	33.9	16	5.9	2.7	33.6	853	3.1	1.4	74	85	3/8

All models: Hose int. 3/8" (10mm) - @90 PSI (@6.3 Bar)

Listed specifications are for reference only. Please check documents in each tool.



# GRINDING

**CP3451-18SE3** ★★ 18,000 RPM

## INDUSTRIAL GRADE STRAIGHT WHEEL GRINDER



### FEATURES

- Aluminum body
- Insulating composite cover
- Rear exhaust

### BENEFITS

- Industrial straight wheel grinder
- Light body
- Industrial grade durability with up to 1,000 hours between maintenance intervals



**CP3451-18SE3**

### CP3451-16SE25

Same features as CP3451-18SE3 with 16,000 rpm & 2.5" wheel capacity

### CP3451-16SER25

Same features as CP3451-18SE3 with 16,000 rpm, 2.5" wheel capacity and rotative valve  
**NOT FOR CE / NA MARKET**

### CP3451-18SER3

Same features as CP3451-18SE3 with rotative valve  
**NOT FOR CE / NA MARKET**



See accessories on pages 92-97

## < 1.2 hp (900 W) Straight Wheel Grinders

**CP3119-18ES3** ★★★ 18,000 RPM



### CP3119-12ES3

Same features as CP3119-18ES3 with 12,000 rpm and 3" wheel capacity

### CP3119-12ES4

Same features as CP3119-18ES3 with 12,000 rpm and 4" wheel

### CP3119-15ES2/3

Same features as CP3119-18ES3 with 15,000 rpm and 2" & 3" wheel capacity

### CP3119-123X

Same features as CP3119-12ES3 with short shaft



### HIGH PERFORMANCE

#### FEATURES

- Steel housing
- Insulating composite over-housing
- Extended body with rubber grip

#### BENEFITS

- Industrial straight wheel grinder
- High productivity
- Highest durability in demanding applications with up to 2,000 hours between maintenance intervals



**CP3119-15ES3**

★ GENERAL MAINTENANCE    ★★ INDUSTRIAL MAINTENANCE & PRODUCTION    ★★★ SUPER INDUSTRIAL

MODEL	PART NUMBER	FREE SPEED		POWER		MAX WHEEL CAPACITY		SPINDLE THREAD	AIR CONS. @LOAD		NET WEIGHT		LENGTH		VIBRATION LEVEL ISO 28927 (m/s <sup>2</sup> )		SOUND PRESS. ISO 15744 - dB(A)	SOUND POWER	AIR INLET
		rpm	hp	W	in.	mm	in.		cfm	l/s	lb	kg	in.	mm	a	k			
CP3119-123X	615 160 6070	12,000	1.2	900	3x25/32x1/2	80x20x12.7	1/2-13	33.9	16	3.7	1.7	9.3	236	<2.5	-		81	3/8	
CP3119-12ES3X	615 160 6030	12,000	1.2	900	3x1/2x3/8	80x13x9.52	3/8-24	33.9	16	3.7	1.7	13.3	338	NA	-	77	88	3/8	
CP3119-12ES4	615 160 6020	12,000	1.2	900	4x1/2x3/8	100x13x9.52	3/8-24	33.9	16	4.0	1.8	13.3	338	2.5	-	78	89	3/8	
CP3119-15ES2	615 160 6040	15,000	1.2	900	2.5x1/2x3/8	63x13x9.52	3/8-24	33.9	16	3.5	1.6	13.3	338	<2.5	-	77	88	3/8	
CP3119-15ES3	615 160 6050	15,000	1.2	900	3x1/2x3/8	80x13x9.52	3/8-24	33.9	16	3.7	1.7	13.3	338	2.7	1.1	78	89	3/8	
CP3119-18ES3	615 160 6060	18,000	1.2	900	3x1/2x3/8	80x13x9.52	3/8-24	33.9	16	3.7	1.7	13.3	338	5.3	3.1	77	88	3/8	
CP3451-16SE25	615 160 2020	16,000	0.8	600	2.5x1/2x3/8	63x13x9.52	-	27.8	13.1	3.3	1.5	13.8	346	10	5.0	82	93	3/8	
CP3451-16SER25	615 160 2050	16,000	0.8	600	2.5x1/2x3/8	63x13x9.52	-	27.8	13.1	3.3	1.5	13.8	346	14.1	4.7	82	93	3/8	
CP3451-18SE3	615 160 2030	18,000	1	750	3x1/2x3/8	80x13x9.52	-	36.9	17.4	3.5	1.6	14	351	3.1	1.3	84	95	3/8	
CP3451-18SER3	615 160 2060	18,000	1	750	3x1/2x3/8	80x13x9.52	-	36.9	17.4	3.5	1.6	14	351	3.1	1.3	84	95	3/8	

All models: Hose int. 1/2" (13mm) - @90 PSI (@6.3 Bar)

Listed specifications are for reference only. Please check documents in each tool.



## 3.2 & 3.6 HP (2,400 & 2,700 W) Straight Wheel Grinders

### The CP3249 Series Benefits

#### PERFORMANCE IN HEAVY APPLICATIONS

- Industrial straight wheel grinder
- High productivity
- Highest durability in demanding applications with up to 2000 hrs between maintenance intervals

### CP3249-GABSUD 4,500 RPM



#### CP3249-GABSUDE

Same features as CP3249-GABSUD

**CE CERTIFICATION / NOT FOR ANSI MARKET**

#### FEATURES

- Grooved handles for improved operator grip
- Double action safety lever
- Overspeed prevention device included



CP3249-GABSUD

### CP3249-GABSYG 6,000 RPM



#### FEATURES

- Grooved handles for improved operator grip
- Double action safety lever
- Overspeed prevention device included



### CP3249-GABSYG

#### CP3249-GABSYGE

Same features as CP3249-GABSYG

**CE CERTIFICATION / NOT FOR ANSI MARKET**



See accessories on pages 92-97

 GENERAL MAINTENANCE  INDUSTRIAL MAINTENANCE & PRODUCTION  SUPER INDUSTRIAL

MODEL	PART NUMBER	FREE SPEED		POWER		MAX WHEEL CAPACITY		SPINDLE THREAD	AIR CONS. @LOAD		NET WEIGHT		LENGTH		VIBRATION LEVEL ISO 28927 (m/s <sup>2</sup> )		SOUND PRESS. ISO 15744 - dB(A)	SOUND POWER	AIR INLET
		rpm		hp	W	in.	mm		in.	cfm	l/s	lb	kg	in.	mm	a			
CP3249-GABSUD	615 160 6140	4,500		3.2	2,400	8x1x5/8	200x25x15.9	5/8-11	70	33	13.9	6.3	21.8	554	NA	-	82	93	1/2
CP3249-GABSUDE	615 160 6190	4,500		3.2	2,400	8x1x5/8	200x25x15.9	5/8-11	70	33	13.9	6.3	19.4	492	NA	-	82	93	1/2
CP3249-GABSYG	615 160 6130	6,000		3.6	2,700	6x1x5/8	150x25x15.9	5/8-11	86	41	12.3	5.6	21.8	554	NA	-	82	93	1/2
CP3249-GABSYGE	615 160 6180	6,000		3.6	2,700	6x1x5/8	150x25x15.9	5/8-11	86	41	12.3	5.6	19.4	492	NA	-	82	93	1/2

All models: Hose inf. 5/8" (16mm) - @90 PSI (@6.3 Bar)

Listed specifications are for reference only. Please check documents in each tool.



# GRINDING

## Accessories Die Grinders

### ACCESSORIES INCLUDED



MODEL	DESCRIPTION	PART NO.
CP3000-600CR	Collet ø 1/8"	205 054 8553
	Wrench	205 054 8083
CP3000-600CR	Collet ø 3mm	205 054 8563
	Wrench	205 054 8083
CP3000-3..R/F	Series 300 collet ø 1/4" (5.55 to 6.35mm)	615 526 0590
	Flat wrench (2)	205 054 8063
CP3000-5..R/F	Series 200 collet, ø 1/4" (5.55 to 6.35mm)	615 526 0630
CP3000-4..R/F	Flat wrench	205 054 8193
CP3030-4..R/F		
CP3030-5..R/F		
CP3019-..ES	Series 300 collet ø 1/4" (5.55 to 6.35mm)	615 526 0590
CP3019-..AC	Exhaust hose L= 31" (0.8m)	615 875 1060
CP3119-..	Flat wrench, 7/16" (11mm)	615 801 0030
	Flat wrench, 11/16" (17mm)	615 501 0320
CP3030-3..R/F	Series 300 collet, ø 1/4" (5.55 to 6.35mm)	615 526 0590
	Flat wrench (2)	205 054 8063
CP9113..	Series 200 collet, ø 1/4" (5.55 to 6.35mm)	615 526 0630
	Flat wrench	205 054 4513
	Flat wrench	205 054 4523
CP3451	Series 200 collet ø1/4" (5.55 to 6.35mm)	615 526 0630
	Exhaust hose	615 432 0110
	(only with CP3451-16SERC)	
	Cone wheel adaptor	615 542 1330
	Stem	615 801 0810
	Wrench (2)	205 049 6453
CP3109-13AC	Series 300 collet, ø 1/4" (5.55 to 6.35mm)	615 526 0590
	Exhaust hose 60" (1.5m)	615 875 1130
	Flat wrench, 7/16" (11mm)	615 801 0030
	Flat wrench, 11/16" (17mm)	615 801 0320
CP3109-..	Series 200 collet, ø 1/4" (5.55 to 6.35mm)	615 526 0630
CP3109-..ES	Exhaust hose 60" (1.5m)	615 875 1130
CP3119-..	Flat wrench, 14mm	615 801 0050
CP3119-..ES	Flat wrench, 3/4" (19mm)	615 801 0760
CP3019-..CNOMO	CNOMO collet ø 6mm	615 526 0460
CP3019-..ES	Exhaust hose L = 0.8m (31")	615 875 1060
CNOMO	Flat wrench, 25/64" (10mm)	615 801 0020
	Flat wrench, 7/16" (11mm)	615 801 0030
CP3119-...	Collet-holder extension L = 28mm (1.1")	615 523 0180
CNOMO	CNOMO collet ø 6mm	615 526 0490
CP3119-..ES	Exhaust hose L = 1.5m (60")	615 875 1130
CNOMO	Flat wrench, 14mm (Qty 2)	615 801 0050
CP3550-120AC	Series 200 collet ø1/4" (5.55 to 6.35mm)	615 526 0630
	Exhaust hose kit	615 813 2520
	Flat wrench	205 049 6453
	Side handle	205 052 4063
CP3650-120ACC	3/8" air hose nipple for 1/2" (13mm) ID hose	615 704 0270
	Hose clamp	615 263 0240
	Exhaust hose	615 875 1130
	Vibration-damping side handle	615 576 0660
	Spanner wrench 19mm	615 801 0760

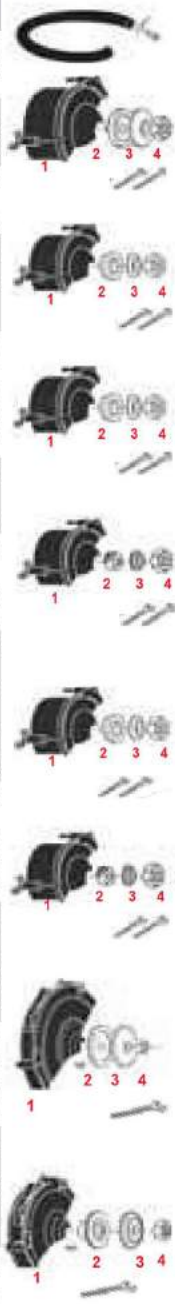

MODEL	ITEM	DESCRIPTION	PART NO.
CP3119-...	-	Exhaust hose L= 31" (0.8m)	615 875 1130
CP3119-12ES4	1	4" (100mm) Disc Guard	615 504 1520
	2	Rear flange 3/8"	615 503 1310
	3	Front flange 3/8"	615 502 0630
	4	Locknut	615 608 0440
	-	Flat wrench, 9/16" (14.3mm)	615 801 0740
	-	Flat wrench, 3/4" (19mm)	615 801 0760
CP3119-18ES3	1	3" (80mm) Disc Guard	615 504 1510
CP3119-15ES3	2	Rear flange 3/8"	615 503 1250
CP3119-12ES3	3	Front flange 3/8"	615 502 0130
CP3119-12ES3X	4	Locknut	615 608 0440
	-	Flat wrench, 9/16" (14.3mm)	615 801 0740
	-	Flat wrench, 3/4" (19mm)	615 801 0760
CP3119-123X	1	3" (80mm) Disc Guard	615 504 1510
	2	Rear flange 1/2"	615 503 1270
	3	Front flange 1/2"	615 502 0440
	4	Locknut	615 608 0450
	-	Flat wrench, 3/4" (19mm)	615 801 0760
CP3119-15ES2	1	2-1/2" (63mm) Disc Guard	615 504 1500
	2	Rear flange 3/8"	615 503 1260
	3	Front flange 3/8"	615 502 0430
	4	Locknut	615 608 0440
	-	Flat wrench, 11/16" (17mm)	615 801 0320
	-	Flat wrench, 9/16" (14.3mm)	615 801 0740
CP3451-..	-	Exhaust hose	615 432 0110
CP3451-18SE3	1	3" (80mm) Disc Guard	615 504 1910
CP3451-18SER3	2	Rear flange	615 503 1620
	3	Front flange	615 502 0790
	4	Locknut	615 605 0950
	-	Flat wrench (2)	205 049 6453
CP3451-16SE25	1	2-1/2" (63mm) Disc Guard	615 504 1890
CP3451-16SER25	2	Rear flange	615 503 1610
	3	Front flange	615 502 0800
	4	Locknut	615 605 0950
	-	Flat wrench (2)	205 049 6453
CP3249	1	8" (200mm) Disc Guard	615 504 0780
-GABSUDE	2	Rear flange	615 503 0040
CP3249	3	Front flange	615 502 0070
-GABSUD	4	Locknut	615 608 0060
	-	Woodruff key	615 630 0190
	-	Flat wrench 1-1/16" (27 mm)	615 801 0770
CP3249	1	6" (150mm) Disc Guard	615 504 0790
-GABSYPGE	2	Rear flange	615 503 0280
CP3249	3	Front flange	615 502 0270
-GABSYPG	4	Locknut	615 608 0060
	-	Woodruff key	615 630 0190
	-	Flat wrench	615 801 0770
CP3249	1	6" (150mm) Disc Guard	615 504 0790
-GABSYPGE	2	Rear flange	615 503 0280
CP3249	3	Front flange	615 502 0270
-GABSYPG	4	Locknut	615 608 0060
FLAP WHEEL	-	Woodruff key	615 630 0190
	-	Flat wrench 1-1/16" (27 mm)	615 801 0770
	*	Flange supplied with flap wheel. To be drilled to fit the diameter of the output shaft of the tool	





# Accessories Die Grinders



GRINDING

## OPTIONAL ACCESSORIES

MODEL	DESCRIPTION	PART NO.
<b>3119-...CNOMO</b>	Collet-holder extension L = 28mm (1.1")	615 523 0180
<b>3119-...ES</b>	CNOMO collet ø 3mm	615 526 0480
<b>CNOMO</b>	CNOMO collet ø 6.35mm (1/4")	615 526 0500
	CNOMO collet ø 8mm	615 526 0510
	Complete silencer kit	615 396 1660
	Reinforced cloth-lined exhaust hose L = 0.75m (30")	615 875 1160
	Clippable silencer	615 396 6550
<b>CP3650-120ACC</b>	Silencer kit	615 396 1660
	Vibration-damping side handle	615 576 0660
	Hose clamp	615 263 0240
	Clippable silencer	615 396 9570
	Reinforced cloth-lined exhaust hose L=30" (0.75m)	615 875 1160
	Grease gun include 24g	615 990 1490
	Grease for bevel gear (1kg)	615 990 1480
	Blades kit (x100)	615 434 0640



MODEL	DESCRIPTION	PART NO.
<b>3019-...CNOMO</b>	CNOMO collet ø 2.5mm	615 526 0890
<b>3019-...ES</b>	CNOMO collet ø 3mm	615 526 0440
<b>CNOMO</b>	CNOMO collet ø 3.2mm (1/8")	615 526 0450
	CNOMO collet ø 4mm (5/32")	615 526 0900
	CNOMO collet ø 5mm	615 526 0920
	CNOMO collet ø 6.4mm (1/4")	615 526 0470
	Complete silencer kit	615 396 1010
	Silencer	615 574 0280
	Clippable silencer	615 396 1240
	Grease gun (capacity 24g - 0.8 oz.)	615 990 1490
	Grease for bevel gear (1kg - 2.2lb)	615 990 1480
<b>CP3550-...</b>	Low vibration handle	615 576 0780

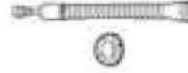

## COLLET

### SERIES 200 COLLET



MODEL	CAPACITY	PART NO.
<b>CP3000-5...R/F</b>	Collet, ø 3.2 to 4mm	615 526 1510
<b>CP3000-4...R/F</b>	Collet, ø 3.7 to 4.5mm	615 526 1520
<b>CP3030-4...R/F</b>	Collet, ø 5.2 to 6mm	615 526 0620
<b>CP3030-5...R/F</b>	Collet, ø 1/4" (5.55 to 6.35mm)	615 526 0630
<b>CP3109-..</b>	Collet, ø 7.2 to 8mm	615 526 0640
<b>CP3119-..</b>	Collet, ø 3/8" (8.7 to 9.5mm)	615 526 0650
<b>CP3451-..</b>		
<b>CP3550-120AC</b>	Serie 200 collet ø1/4" (5.55 to 6.35mm)	615 526 0630
<b>CP3650-120ACC</b>		
<b>CP9113G/ES</b>		

### SERIES 300 COLLET



MODEL	CAPACITY	PART NO.
<b>CP3000-3...R/F</b>	Collet, ø 1/8" (2.4 to 3.2mm)	615 526 0610
<b>CP3019-...(ES)</b>	Collet, ø 4.2 to 5mm	615 526 1530
<b>CP3019-..</b>	Collet, ø 3/64" (0.4 to 1.2mm)	615 526 0520
<b>CP3109-13AC</b>	Collet, ø 5/64" (1.2 to 2mm)	615 526 0530
<b>CP3030-3...R/F</b>	Collet, ø 3/32" (1.7 to 2.5mm)	615 526 0540
	Collet, ø 1/8" (2.4 to 3.2mm)	615 526 0550
	Collet, ø 5/32" (3.16 to 3.96mm)	615 526 0560
	Collet, ø 3/16" (3.95 to 4.75mm)	615 526 0570
	Collet, ø 7/32" (4.75 to 5.55mm)	615 526 0580
	Collet, ø 1/4" (5.55 to 6.35mm)	615 256 0590



MODEL	CAPACITY	PART NO.
<b>CP875, CP876, CP9105Q-B, CP9106Q-B, CP9108Q-B, CP9110Q-B, CP9111Q-B, CP9112Q-B,</b>	3 mm	205 048 4292
<b>CP9105Q-B, CP9106Q-B, CP9108Q-B,</b>	1/4"	205 048 4293
<b>CP9110Q-B, CP9111Q-B, CP9112Q-B,</b>	6 mm	C139289
<b>CP9105Q-B, CP9106Q-B, CP9108Q-B,</b>	1/8"	205 051 6623
<b>CP9110Q-B, CP9111Q-B, CP9112Q-B, CP875, CP876</b>	1/4"	C138727



# GRINDING

## Accessories Die Grinders



### SILENCERS

MODEL	DESCRIPTION	PART NO.
CP3019-..(ES)	Kit silencer	615 396 1010
CP3000-3..R	Clippable silencer	615 396 1240

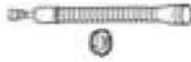

MODEL	ITEM	DESCRIPTION	PART NO.
CP3109-..	1	Kit silencer	615 396 1660
CP3119-..	2	Clippable silencer	615 396 6550
CP3109-13AC			
CP3650-120ACC			



CP3451	3	Kit silencer	615 574 0760
	4	Exhaust hose	615 432 0110
	5	Exhaust hose adaptor*	615 730 1870

\* Needed to fit 3 and 4 on safety lever versions



MODEL	DESCRIPTION	PART NO.
CP3249-...	Kit silencer	615 399 4600



### OTHER ACCESSORIES

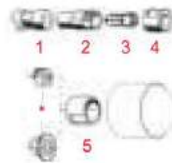

MODEL	ITEM	DESCRIPTION	PART NO.
CP3119-..	1	Spacer for collet-holder	615 666 1490
	2	Series 200 collet holder	615 523 0230
	3	Series 200 collet	see page 89
	4	Series 200 collet nut	615 607 1440
	5	Spacer for threaded cone wheel	615 503 5160
	*	3/8"	

Rear flange supplied with tool 615 503 1260 or 615 503 1250

### HOSE

MODEL	DESCRIPTION	PART NO.
CP3000-600CR	Hose kit (incl. Inlet hose & exhaust hose)	205 054 8473

### ADAPTER

DESCRIPTION	PART NO.
Collet adapter allows use of 1/8" shank burrs (For any 1/4" Collet die grinder)	C123029



### MOUNTED POINTS 6 MM Ø SHANK - RED

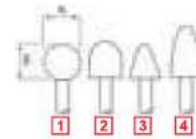

N°	MAX SPEED*	A		B		PART NO.
		in.	mm	in.	mm	
1	59,000	0.62	16	0.62	16	435983
2	50,000	0.79	20	0.62	16	435993
3	45,000	0.79	20	1.10	28	436003
4	48,000	0.79	20	1.26	32	436013

### MOUNTED POINTS 3 MM Ø SHANK - RED

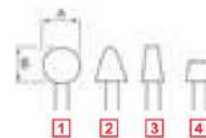

N°	MAX SPEED*	A		B		PART NO.
		in.	mm	in.	mm	
1	104,000	0.19	5	0.19	5	38582
2	104,000	0.19	5	0.31	8	38522
3	105,000	0.16	4	0.16	4	38562
4	81,000	0.25	6	0.25	6	38542



# Accessories Die Grinders



GRINDING



## TUNE-UP KITS

MODEL	TUNE-UP KIT
CP3000/3030-3...	205 054 6403
CP3000/3030-4...	205 054 7863
CP3000/3030-5...	205 054 7923
CP3000-600CR	205 054 8613
CP3019-...AC	205 054 2133
CP3451-...	615 397 3030
CP3550-...	615 399 2280
CP3650 Series	205 055 6003
CP9104Q	205 050 6623
CP9105Q-B	894 016 8879
CP9106Q-B	894 016 8880
CP9108Q-B	894 016 8880
CP9111Q-B	894 016 8892
CP9110Q-B	894 016 8879
CP9112Q-B	894 016 8892
CP9113	205 054 5233

## KITS



### CP9104Q Kit

Part No. 615 195 0104

Kit includes:

- (1) Pencil Grinder
- (5) Mounted points 3mm
- (5) Carbide burrs 3 mm
- (1) 1/8" and 3 mm collets
- (1) 2.4 mm collet



### CP9111Q-B Mkit

Part No. 615 195 0211

Kit includes:

- (1) Die grinder CP9111QB
- (1) 3 mm collet
- (5) 3 mm mounted points
- (5) 6 mm mounted points



### CP875 Kit

Part No. 894 110 8751

Kit includes:

- (1) Grinder CP875
- (1) 2" - 50 mm backing pad
- (2) 2" - 50 mm coarse surface prep pad
- (2) 2" - 50 mm medium surface prep pad
- (2) 2" - 50 mm fine surface pre pad
- (2) 2" - 50 mm 50 grit sanding disc
- (2) 2" - 50 mm 36 grit sanding disc
- (2) 2" - 50 mm 24 grit sanding disc



## DIMENSIONS

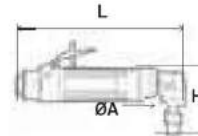
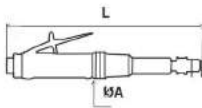

DIE GRINDER	L		ØA	
	in	mm	in	mm
CP9104Q	5.23	133	0.59	15
CP3000-600CR	6.0	153	0.59	15
CP876	4.75	121	1.38	35
CP9105Q-B	6.3	160	1.6	40
CP9110Q-B	10.2	260	1.6	40
CP3019	6.6	168	1.26	32
CP3019-..ES	9.8	248	1.26	32
CP3000-3...	5.9	150	1.61	41
CP3000-4...	7.7	196	1.73	44
CP3000-5...	7.6	195	1.73	44
CP9111Q-B	6.3	160	2.6	65
CP9112Q-B	13.4	340	2.8	70
CP860	5.75	146	2.8	70
CP860-ES	12.3	310	2.8	70
CP860E	5.75	146	2.8	70
CP860-ESE	12.3	310	2.8	70
CP9113G	6.7	170	1.85	47
CP9113GES	12.6	320	1.85	47
CP3451-..SE	14.2	361	1.18	30
CP3119-..ES..	13.3	338	1.26	32
CP3109/3119	8.8	222	1.67	42.5
CP3109/3119 ES	14.2	361	1.71	43.5
CP3119-12EL	23.7	601	1.71	43.5
CP3119-12EXL	33.6	851	1.71	43.5
CP3119 CNOMO	8.8	222	1.67	42.5
CP3119 ES CNOMO	14.3	363	1.71	43.5

ANGLE DIE GRINDER	L		H		ØA	
	in	mm	in	mm	in	mm
CP3019-...AC	6.5	166	3	76	1.2	30
CP3030-3...	6.1	154	4.1	103	1.6	41
CP3030-4...	6.8	174	5.9	143	1.7	43
CP3030-5...	6.8	174	6.3	160	2.1	53
CP3109-...AC	8.5	216	3	76	1.2	30
CP3550-120AC	9.8	249	4.1	103	1.1	27
CP3650-12ACC	9.4	238	-	-	4	102
CP875	4.88	124	3	76	1.04	26.4
CP9106Q-B	4.7	120	3	76	1.04	26.4
CP9108Q-B	7.9	200	3.07	78	1.04	26.4

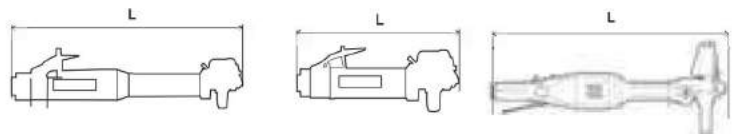

STRAIGHT WHEEL GRINDER	L	
	in	mm
CP3119-123X	9.3	236
CP3119-12ES3X	13.3	338
CP3119-12ES4	13.3	338
CP3119-15ES2	13.3	338
CP3119-15ES3	13.3	338
CP3119-18ES3	13.3	338
CP3249-..	21.8	554
CP3451-16SE..	14.2	361
CP3451-18SE..	14.2	361



# GRINDING

## Accessories Die Grinders



### CP CARBIDE BURR

#### SPEED GUIDE

Recommended Operating Speeds

All rpm ratings in the table below are listed as thousands.

BURR HEAD DIAMETER	MAX. OPERATING SPEED	ALUMINUM, PLASTIC		BRASS, COPPER, CAST IRON, BRONZE		UNHARDENED STEEL		HARDENED STEEL, STAINLESS STEEL, NIMONIC ALLOYS	
		Speed Range	Recomm. Start Point	Speed Range	Recomm. Start Point	Speed Range	Recomm. Start Point	Speed Range	Recomm. Start Point
3 mm (1/8")	100	60 - 80	65	45 - 80	65	60 - 80	80	60 - 80	80
6 mm (1/4")	65	15 - 60	40	22 - 60	45	45 - 60	50	30 - 45	40
10 mm (3/8")	55	10 - 50	25	15 - 40	30	30 - 40	30	19 - 30	25
12 mm (1/2")	35	7 - 30	20	11 - 30	25	22 - 30	25	15 - 22	20
16 mm (5/8")	25	6 - 20	15	9 - 20	20	18 - 20	20	12 - 18	15
20 mm (3/4")	20	5 - 17	10	8 - 17	12	15 - 17	15	10 - 15	10
25 mm (1")	15	4 - 13	8	6 - 13	10	10 - 13	10	7 - 11	8

Recommended speeds are based on standard shank length of 45 mm / (1-3/4") max overhang of 10 mm (3/8")  
Maximum recommended operating speeds for extended length shanks is 15,000 rpm

Chicago Pneumatic offers a wide range of products that will cover virtually every application on industry.

#### CP OFFERS THREE DIFFERENT TYPES OF CUT



##### DOUBLE CUT

The most common on the market, to be used on hard metal applications



##### POWER CUT

When high performance and durability is a must, to be used on hard metal application



##### ALUMINUM CUT

To be used on all soft metals

#### CARBIDE BURR DISPLAY



##### IMPERIAL

Part No. 894 017 2244

- 40 pieces display CP branded
- Plastic door with a key lock
- All double cut burrs
- All 1/4" Ø shank
- 2 x (5 shapes and 4 head sizes)
- Shapes B, C, F, G, L
- Head sizes 1/4", 5/16", 3/8", 1/2"

##### METRIC

Part No. 894 017 1789

- 40 pieces display CP branded
- Plastic door with a key lock
- All double cut burrs
- All 6 mm shank
- 2 x (5 shapes and 4 head sizes)
- Shapes B, C, F, G, L
- Head sizes 6, 8, 10, 12 mm

#### CARBIDE BURR KITS

##### DOUBLE CUT

###### 1/8" Ø SHANK

Part No. 894 017 2240

Kit includes:

- 10 pieces
- 1/8" head for imperial, shapes A, B, C, D, E, F, G, L, M, N



##### DOUBLE CUT

###### 1/4" Ø SHANK

Part No. 894 017 2242

Kit includes:

- 5 pieces
- 3/8" head, shapes B, C,
- 1/2" head, shapes C, F, L



##### POWER CUT

###### 1/4" Ø SHANK

Part No. 894 017 2241

Kit includes:

- 5 pieces
- 1/2" head for imperial, shapes B, C, F, G, L



##### ALUMINUM CUT

###### 1/4" Ø SHANK

Part No. 894 017 2243

Kit includes:

- 5 pieces
- 3/8" head, shapes B, C,
- 1/2" head, shapes C, F, L



##### 3MM Ø SHANK

Part No. 894 017 1785

Kit includes:

- 10 pieces
- 3mm head for metric, shapes A, B, C, D, E, F, G, L, M, N

##### 6MM Ø SHANK

Part No. 894 017 1787

Kit includes:

- 5 pieces
- 10mm head, shapes B, C,
- 12mm head, shapes C, F, L

##### 6MM Ø SHANK

Part No. 894 017 1786

Kit includes:

- 5 pieces
- 12mm head for metric, shapes B, C, F, G, L

##### 6MM Ø SHANK

Part No. 894 017 1788

Kit includes:

- 5 pieces
- 10mm head, shapes B, C,
- 12mm head, shapes C, F, L



# Accessories Die Grinders

## CP CARBIDE BURR



### SINGLE PIECE - IMPERIAL

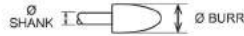

SHAPE	HEAD SHAPE	DOUBLE CUT						POWER CUT		ALUMINUM CUT	
		SHANK 1/8"		SHANK 1/4"				SHANK 1/4"		SHANK 1/4"	
		BURR Ø 1/8"	BURR Ø 1/4"	BURR Ø 5/16"	BURR Ø 3/8"	BURR Ø 1/2"	BURR Ø 5/8"	BURR Ø 1/2"	BURR Ø 5/8"	BURR Ø 3/8"	BURR Ø 1/2"
	A Cylinder w/o endcut	894 017 2174	894 017 2204	894 017 2211		894 017 2192		894 017 2223	894 017 2228		
	B Cylinder with endcut	894 017 2175	894 017 2205	894 017 2212	894 017 2184	894 017 2193		894 017 2217	894 017 2224	894 017 2248	894 017 2234
	C Ball nosed cylinder	894 017 2176	894 017 2206	894 017 2213	894 017 2185	894 017 2194	894 017 2201	894 017 2218	894 017 2225	894 017 2229	894 017 2235
	D Ball	894 017 2177	894 017 2207	894 017 2214	894 017 2186	894 017 2195				894 017 2230	894 017 2236
	E Oval	894 017 2178		894 017 2215	894 017 2187						
	F Ball nosed tree	894 017 2179	894 017 2208	894 017 2245	894 017 2188	894 017 2196	894 017 2202	894 017 2219	894 017 2226	894 017 2231	894 017 2237
	G Pointed Tree	894 017 2180	894 017 2209	894 017 2216	894 017 2189	894 017 2197		894 017 2220		894 017 2249	894 017 2238
	H Flame					894 017 2198		894 017 2221			
	L Ball nose cone	894 017 2181	894 017 2246	894 017 2247	894 017 2190	894 017 2199	894 017 2203	894 017 2222	894 017 2227	894 017 2232	894 017 2239
	M Cone	894 017 2182	894 017 2210		894 017 2191	894 017 2200					
	N Inverted Cone	894 017 2183									

### SINGLE PIECE - METRIC

SHAPE	HEAD SHAPE	DOUBLE CUT						POWER CUT		ALUMINUM CUT	
		SHANK 3 mm		SHANK 6 mm				SHANK 6 mm		SHANK 6 mm	
		BURR 3 mm	BURR 6 mm	BURR 8 mm	BURR 10 mm	BURR 12 mm	BURR 15 mm	BURR 12 mm	BURR 15 mm	BURR 10 mm	BURR 12 mm
	A Cylinder w/o endcut	894 017 1719	894 017 1749	894 017 1756		894 017 1737		894 017 1768	894 017 1773	894 017 1778	
	B Cylinder with endcut	894 017 1720	894 017 1750	894 017 1757	894 017 1729	894 017 1738		894 017 1762	894 017 1769	894 017 1935	894 017 1779
	C Ball nosed cylinder	894 017 1721	894 017 1751	894 017 1758	894 017 1730	894 017 1739	894 017 1746	894 017 1763	894 017 1770	894 017 1774	894 017 1780
	D Ball	894 017 1722	894 017 1752	894 017 1759	894 017 1731	894 017 1740				894 017 1775	894 017 1781
	E Oval	894 017 1723		894 017 1760	894 017 1732						
	F Ball nosed tree	894 017 1724	894 017 1753	894 017 1932	894 017 1733	894 017 1741	894 017 1747	894 017 1764	894 017 1771	894 017 1776	894 017 1782
	G Pointed Tree	894 017 1725	894 017 1754	894 017 1761	894 017 1734	894 017 1742		894 017 1765		894 017 1936	894 017 1783
	H Flame					894 017 1743		894 017 1766			
	L Ball nose cone	894 017 1726	894 017 1933	894 017 1934	894 017 1735	894 017 1744	894 017 1748	894 017 1767	894 017 1772	894 017 1777	894 017 1784
	M Cone	894 017 1727	894 017 1755		894 017 1736	894 017 1745					
	N Inverted Cone	894 017 1728									



# GRINDING

**CP3019-18A3**  18,000 RPM

**HIGH PERFORMANCE  
IN A COMPACT PACKAGE**



## FEATURES

- Highly durable bevel gearing
- Compact body
- Insulating composite over housing

## BENEFITS

- Industrial angle wheel grinder
- Optimal productivity
- Highest durability in demanding applications, up to 2000 hour service interval



### CP3019-20A3

Same features as CP3019-18A3 with 20,000 rpm

### CP3019-13A4

Same features as CP3019-18A3 with 13,500 rpm and with 4" wheel capacity



<0.5 hp (375 W) Angle Wheel Grinders 2" to 4"

**CP7500D**  22,000 RPM



## COMPACT CUTTING & GRINDING

### CP7500DK

Part No. 894 107 5002

Kit includes:

- (1) 2" (51mm) Angle Grinder / Cut-off Tool CP7500D
- (3) 2" (51mm) grinding wheel 60 Grit
- (3) 2" (51mm) grinding wheel 80 Grit
- (3) 2" (51mm) grinding wheel 120 Grit
- (5) 2" (51mm) cutting wheel
- (1) Pin wrench
- (1) Spanner
- (1) Protective glasses

## FEATURES



- Rubber handle grip
- Lock off safety lever
- Full 180° protective guard

## BENEFITS

- General maintenance applications
- Compact and lightweight
- Versatile: designed for grinding and cutting



See accessories on pages 116-122

 GENERAL MAINTENANCE  INDUSTRIAL MAINTENANCE & PRODUCTION  SUPER INDUSTRIAL

MODEL	PART NUMBER	FREE SPEED		POWER		MAX WHEEL CAPACITY		SPINDLE THREAD	AIR CONS. AT FREE SPEED		AIR CONS. @LOAD		NET WEIGHT		LENGTH		VIBRATION LEVEL ISO 28927 (M/S <sup>2</sup> )		SOUND PRESS. ISO 15744 - dB(A)	SOUND POWER	AIR INLET
		rpm	hp	W	in.	mm	in.		cfm	l/s	cfm	l/s	lb	kg	in.	mm	a	k			
<b>CP7500D</b>	894 107 5001	22,000	0.2	150	2	50	3/8-24	17	8	8	3.8	1.2	0.6	5.5	140	19.9	6.7	81	92	1/4	
<b>CP3019-18A3</b>	615 160 7060	18,000	0.5	375	3	75	3/8-24	10.4	4.9	19.3	9.1	0.7	0.3	6.4	163	12.3	2.6	80	91	1/4	
<b>CP3019-20A3</b>	615 160 7070	20,000	0.5	375	3	75	3/8-24	12.7	6	19.1	9	0.7	0.3	6.4	163	13.3	3.2	83	94	1/4	
<b>CP3019-13A4</b>	615 160 7050	13,500	0.5	375	4	100	3/8-24	7.4	3.5	17.6	8.3	0.7	0.3	6.4	163	8.6	3.0	79	90	1/4	

All models: Hose int. 1/2" (13 mm) - @90 PSI (@6.3 Bar)

Listed specifications are for reference only. Please check documents in each tool.



# 0.8 hp (600 W) Angle Wheel Grinders 4" to 5" The CP91 Series Benefits

## LIGHTWEIGHT & EASY HANDLING

- General Maintenance Applications
- Lightweight rugged housing
- Durability and performance

### CP9121BR ★

12,000 RPM



### CP9121CR

Same features as CP9121-BR with 3/8"-24 spindle thread

### CP9121AR

Same features as CP9121-BR with M14 spindle thread

#### FEATURES

- Keyless adjustable protective guard
- Governed for optimal performance
- Aluminum alloy housing



CP9121BR



See accessories on pages 116-122

### CP9120CR ★

12,000 RPM

## FEATURES

- Keyless adjustable protective guard
- Governed for optimal performance
- Aluminum alloy housing



CE CERTIFICATION / NOT FOR ANSI MARKET



CP9120CR

### CP9120CRN

Same features as CP9120-CR with different flanges for the North American market only

### CP9122CR

Same features as CP9120-CR with 3/8"-24 spindle thread for 4.5" (114mm) max wheel capacity

### CP9122BR

Same features as CP9120-CR with 5/8"-11 spindle thread for 4.5" (114mm) max wheel capacity

★ GENERAL MAINTENANCE   ★★ INDUSTRIAL MAINTENANCE & PRODUCTION   ★★★ SUPER INDUSTRIAL

MODEL	PART NUMBER	FREE SPEED		POWER		MAX WHEEL CAPACITY		SPINDLE THREAD		AIR CONS. AT FREE SPEED			AIR CONS. @LOAD		NET WEIGHT		LENGTH		VIBRATION LEVEL ISO 28927 (M/S2)		SOUND PRESS.	SOUND POWER	AIR INLET
		rpm	hp	W	in.	mm	in.	in.	cfm	l/s	cfm	l/s	lb	kg	in.	mm	a	k	ISO 15744 - dB(A)	in.			
CP9120CR	615 195 2120	12,000	0.8	600	4	100	3/8-24	21	9.9	23.3	11	4.2	1.9	9.3	233	5.3	1.6	84	95	1/4			
CP9120CRN	894 109 1200	12,000	0.8	600	4	100	3/8-24	21	9.9	23.3	11	4.2	1.9	9.3	233	5.3	1.6	84	95	1/4			
CP9121AR	615 195 7321	12,000	0.8	600	5	125	M14	21	9.9	27.6	13	4.6	2.1	9.6	240	6.7	2.2	84	95	1/4			
CP9121BR	615 195 7221	12,000	0.8	600	5	125	5/8-11	21	9.9	27.6	13	4.6	2.1	9.6	240	8.6	4.6	84	95	1/4			
CP9121CR	615 195 2121	12,000	0.8	600	5	125	3/8-24	21	9.9	25.4	12	4.6	2.1	9.6	240	11.2	3.4	84	95	1/4			
CP9122BR	615 195 7222	12,000	0.8	600	4.5	115	5/8-11	21	9.9	29.7	14	4.2	1.9	9.3	233	8.6	4.6	84	95	1/4			
CP9122CR	615 195 2122	12,000	0.8	600	4.5	115	3/8-24	21	9.9	29.7	14	4.2	1.9	9.3	233	5.4	1.0	84	95	1/4			

All models: Hose int. 3/8" (10mm) - @90 PSI (@6.3 Bar)

Listed specifications are for reference only. Please check documents in each tool.



# GRINDING

## CP3040GABTIM

13,500 RPM



### ROBUST STEEL CONSTRUCTION

### FEATURES

- Durable bevel gear
- Robust machined steel housing
- Robust safety lever

### BENEFITS

- Industrial angle wheel grinder
- High body durability
- Withstands rough usage



**CP3040GABTIM**

### CP3040-GASTIM

Same features as CP3040 GABTIM with extended shaft



## 0.7 & 0.8 HP (525 & 600 W) Angle Wheel Grinders 4" & 5"

### CP854



13,000 RPM



### CP854 E

Same features as CP854 with 5" (125 mm) max wheel capacity and M10 spindle thread

### EFFICIENT & DURABLE

#### FEATURES

- Aluminum alloy housing
- Helical bevel gear design
- 4" (100 mm) wheel capacity

#### BENEFITS

- General maintenance applications
- Lightweight rugged housing
- Durability and performance

### CP3109-13A4

13,000 RPM



### CP3109-13A4ES

Same features as CP3109-13A4 with extended shaft

### HIGH PERFORMANCE

#### FEATURES

- Highly durable bevel gear
- Insulating composite over-housing
- Streamlined safety lever

#### BENEFITS

- Industrial angle wheel grinder
- Optimal productivity
- Highest durability in demanding applications up to 2,000 hours maintenance intervals



See accessories on pages 116-122

★ GENERAL MAINTENANCE   ★★ INDUSTRIAL MAINTENANCE & PRODUCTION   ★★★ SUPER INDUSTRIAL

MODEL	PART NUMBER	FREE SPEED		POWER		MAX WHEEL CAPACITY		SPINDLE THREAD	AIR CONS. AT FREE SPEED		AIR CONS. @LOAD		NET WEIGHT		LENGTH		VIBRATION LEVEL ISO 28927 (M/S2)		SOUND PRESS. ISO 15744 - dB(A)	SOUND POWER	AIR INLET
		rpm		hp	W	in.	mm		in.	cfm	l/s	cfm	l/s	lb	kg	in.	mm	a			
CP854E	T023187	12,000		0.7	525	5	125	M10	16	7.5	16	7.6	3.8	1.7	9	229	4.9	1.5	85	96	1/4
CP854	T023186	13,000		0.7	525	4	100	3/8-24	24	11.3	24	11.3	3.8	1.7	9	229	4.9	1.5	85	96	1/4
CP3109-13A4ES	615 160 7040	13,000		0.8	600	4	100	3/8-24	21	10	32	15.1	3.3	1.5	11.3	287	7.2	2.4	84	95	3/8
CP3109-13A4	615 160 7030	13,000		0.8	600	4	100	3/8-24	21	10	32	15.1	2.6	1.2	8.5	217	9.3	3.0	85	96	3/8
CP3040GASTIM	615 160 7020	13,500		0.7	520	4	100	3/8-24	32.9	15.5	26.5	12.5	3.7	1.7	10.6	270	9.6	3.3	92	103	3/8
CP3040GABTIM	615 160 7010	13,500		0.7	520	4	100	3/8-24	32.9	15.5	26.5	12.5	3.3	1.5	8.3	210	7.2	2.4	88	99	3/8

All models: Hose int. 3/8 (10mm) - @90 PSI (@6.3 Bar)

Listed specifications are for reference only. Please check documents in each tool.





# 1.1 hp (810 W) Angle Wheel Grinders 4" to 5"

## The CP3450 Series Benefits

### INDUSTRIAL GRADE ANGLE GRINDER

- Industrial angle wheel grinder
- High productivity
- Industrial grade durability with up to a 1,000 hour maintenance interval

#### CP3450-12AC4 ★★

12,000 RPM



#### FEATURES

- Constant lubrication bevel gear design
- Low profile angle head design
- Insulating composite cover

#### CP3450-12ACR4

Same features as CP3450-12AC4 with rotative throttle  
**NOT FOR CE/NA MARKETS**

#### CP3450-12AC45

Same features as CP3450-12AC4 with 4.5" (115 mm) max wheel capacity



CP3450-12AB5

#### CP3450-12AB5

12,000 RPM



### FEATURES

- Constant lubrication bevel gear design
- Low profile angle head design
- Insulating composite cover



CP3450-12AB5

#### CP3450-12AA5

Same features as CP3450-12AB5 with M14 spindle



See accessories on pages 116-122

★ GENERAL MAINTENANCE   ★★ INDUSTRIAL MAINTENANCE & PRODUCTION   ★★★ SUPER INDUSTRIAL

MODEL	PART NUMBER	FREE SPEED		POWER		MAX WHEEL CAPACITY		SPINDLE THREAD	AIR CONS. AT FREE SPEED		AIR CONS. @LOAD		NET WEIGHT		LENGTH		VIBRATION LEVEL ISO 28927 (M/S <sup>2</sup> )		SOUND PRESS. ISO 15744 - dB(A)	SOUND POWER	AIR INLET
		rpm		hp	W	in.	mm		in.	cfm	l/s	cfm	l/s	lb	kg	in.	mm	a			
CP3450-12AA5	615 160 4040	12,000		1.1	810	5	125	M14	38.6	18.2	36	17	3.7	1.7	9.2	231	8.1	2.9	95	106	3/8
CP3450-12AB5	615 160 4050	12,000		1.1	810	5	125	5/8-11	38.6	18.2	36	17	3.7	1.7	9.2	231	8.5	2.8	95	106	3/8
CP3450-12ACR4	615 160 4020	12,000		1.1	810	4	100	3/8-24	42.8	20.2	36	17	3.2	1.5	9.2	231	8.1	2.9	94	105	3/8
CP3450-12AC4	615 160 4010	12,000		1.1	810	4	100	3/8-24	37.7	17.8	36	17	3.1	1.4	9.2	231	6.5	2.1	94	105	3/8
CP3450-12AC45	615 160 4030	12,000		1.1	810	4.5	115	3/8-24	38.2	18	36	17	3.1	1.4	9.2	231	8.3	3.0	94	105	3/8

All models: Hose int. 3/8" (10mm) - @90 PSI (@6.3 Bar)

Listed specifications are for reference only. Please check documents in each tool.



# GRINDING

**CP75**  
**series**  
**POWERFUL**  
**AND**  
**DURABLE**

**UNIQUE**  
**FEATURES**  
*Premium Tool*



## CP7540/45/50 **★★**

**Best in class grinder for maintenance applications**

### DURABILITY AT A WHOLE NEW LEVEL

THE CP75 SERIES BOASTS 1000H  
SERVICE INTERVAL

### THE MOST POWERFUL IN ITS CLASS

1.1 HP / 840 W

#### POWERFUL & EFFICIENT

- 1.1 HP – 840 W
- Governed motor

#### ERGONOMIC

- Well balanced & compact
- Composite grip insulates operator's hand from cold
- 360° swivel air inlet

#### SAFE

- Rear exhaust (exhaust hose included)
- Streamline CP Safety Lever
- Steel guard
- Safety screw

#### HIGH DURABILITY

- 1,000 hr service interval
- High quality bevel gears

#### COMFORT

Streamline composite handle for either right or left handed operation

#### EASY OPERATION

Robust steel keyless adjustable wheel guard



### CP75 series

The range has abrasives capacity from 4" (100 mm), 4.5" (115 mm), 5" (125 mm) abrasive capacity and features 3/8"-24



# 1.1 hp (840 W) Angle Wheel Grinders 4" to 5"

## The CP75 Series Benefits

**POWERFUL & DURABLE / 1.1HP - 840 W / 1,000 HOUR SERVICE INTERVAL**

- Powerful & Efficient
- High Durability
- Easy Operation

### CP7540-C ★★

12,000 RPM



#### FEATURES

- High quality bevel gears & Governed motor
- Robust steel keyless rotative wheel guard
- 3/8- 24 spindle thread

### CP7540-CN

Same features as CP7540-C with 3/8" spindle and North America flanges

### CP7545-B ★★

12,000 RPM



#### FEATURES

- High quality bevel gears & Governed motor
- Robust steel keyless rotative wheel guard
- 5/8- 11 spindle thread

### CP7545-C

Same features as CP7545-B with 3/8" spindle

### CP7550-B ★★

12,000 RPM



#### FEATURES

- High quality bevel gears & Governed motor
- Robust steel keyless rotative wheel guard
- 360° swivel air inlet



### CP7550-B

### CP7550-A

Same features as CP7550-B with M14 spindle

### CP7550-C

Same features as CP7550-B with 3/8" spindle



See accessories on pages 116-122

★ GENERAL MAINTENANCE   ★★ INDUSTRIAL MAINTENANCE & PRODUCTION   ★★★ SUPER INDUSTRIAL

MODEL	PART NUMBER	FREE SPEED			MAX WHEEL CAPACITY		SPINDLE THREAD		AIR CONS. AT FREE SPEED		AIR CONS. @LOAD		NET WEIGHT		LENGTH		VIBRATION LEVEL ISO 28927 (M/S2)		SOUND PRESS. ISO 15744 -dB(A)	SOUND POWER	AIR INLET
		rpm	hp	W	in.	mm	in.	cfm	l/s	cfm	l/s	lb	kg	in.	mm	a	k	in.			
CP7540-C	894 107 5401	12,000	1.1	840	4	100	3/8-24	20	9.3	40	18.9	3.5	1.6	10.6	270	6.5	3.0	85	96	1/4	
CP7540-CN	894 107 5400	12,000	1.1	840	4	100	3/8-24	20	9.3	40	18.9	3.5	1.6	10.6	270	6.5	3.0	85	96	1/4	
CP7545-B	894 107 5452	12,000	1.1	840	4.5	115	5/8-11	20	9.3	40	18.9	3.5	1.6	10.6	270	7.0	2.1	85	96	1/4	
CP7545-C	894 107 5451	12,000	1.1	840	4.5	115	3/8-24	20	9.3	40	18.9	3.5	1.6	10.6	270	7.0	2.1	85	96	1/4	
CP7550-A	894 107 5503	12,000	1.1	840	5	125	M14	20	9.3	40	18.9	3.5	1.6	10.6	270	7.0	2.1	85	96	1/4	
CP7550-B	894 107 5502	12,000	1.1	840	5	125	5/8-11	20	9.3	40	18.9	3.5	1.6	10.6	270	7.0	2.1	85	96	1/4	
CP7550-C	894 107 5501	12,000	1.1	840	5	125	3/8-24	20	9.3	40	18.9	3.5	1.6	10.6	270	7.0	2.1	85	96	1/4	

All models: Hose int. 3/8" (10mm) - @90 PSI (@6.3 Bar)

Listed specifications are for reference only. Please check documents in each tool.



# GRINDING

**CP3550**  
**EASY TO**  
**HANDLE**  
**AND**  
**INDUSTRIAL**  
**TOUGH**

**UNIQUE**  
**FEATURES**  
*Premium Tool*

**NEW**



## CP3550

### INDUSTRIAL PACKAGE

- Governed motor maintains maximal abrasive speed
- Spindle lock allows single tool abrasive replacement
- Rotative inlet swivel allows easier handling

### GRINDING, SANDING & CUTTING APPLICATIONS

- Foundries, Casting Plants, Fabrication shops
- Production and Maintenance operations on cast iron, steel, stainless steel, aluminum, composite, alloys

### ROTATIVE INLET SWIVEL

- Maintains tool operation easy and avoid air hose knots

### STREAMLINED SAFETY LEVER

- Allows heavy tool operation while wearing heavy gloves, and can be easily oriented downwards

### ELABORATE SILENCER

- Unique silencer foam damps noise emissions down to 86 dB

### INDUSTRIAL GRADE POWER

- 1.5 hp (1100W) governed motor allows industrial performance in intensive material removal applications

### COMPOSITE OVER-SLEEVE

- Thermal insulating sleeve provides operator comfort while offering a low diameter for comfortable handling

### UNIQUE KEYLESS ADJUSTABLE GUARD

- Helps to adjust quickly the guard position to best suit the working position and deflecting sparks

### FAST AND EASY ABRASIVE CHANGE

- Spindle lock feature allows fast abrasive replacement to reduce tool downtime



# 1.5 hp (1100 W) Angle Wheel Grinders The CP3550 Series Benefits

## INDUSTRIAL PRODUCTIVITY & ERGONOMICS

- Industrial angle wheel grinder
- Industrial grade durability with up to a 1,000 hour maintenance interval
- Superior torque for maximal productivity

### CP3550-120AB45

12,000 RPM



#### FEATURES

- 1.5 hp (1,100 W) governed motor
- Durable bevel gear
- Spindle lock button



### CP3550-120AB5

12,000 RPM



#### FEATURES

- 1.5 hp (1,100 W) governed motor
- Durable bevel gear
- Spindle lock button



### CP3550-120AB5

#### CP3550-120AC4

Same features as CP3550-120AB5 with 3/8 spindle and 4" wheel

#### CP3550-120AA45

Same features as CP3550-120AB5 with M14 spindle and 4.5" wheel

#### CP3550-120AA5

Same features as CP3550-120AB5 with M14 spindle



See accessories on pages 116-122

SUPER INDUSTRIAL



MODEL	PART NUMBER	FREE SPEED		POWER		MAX WHEEL CAPACITY		SPINDLE THREAD	AIR CONS. AT FREE SPEED		AIR CONS. @LOAD		NET WEIGHT		LENGTH		VIBRATION LEVEL ISO 28927 (M/S <sup>2</sup> )		SOUND PRESS.	SOUND POWER	AIR INLET
		rpm		hp	W	in.	mm	in.	cfm	l/s	cfm	l/s	lb	kg	in.	mm	a	k	ISO 15744 - dB(A)		in.
CP3550-120AA45	615 160 7760	12,000		1.5	1,100	4.5	115	M14	36	17	56	26	4.1	1.9	9.9	252	7.5	4.1	84	95	3/8
CP3550-120AA5	615 160 7780	12,000		1.5	1,100	5	125	M14	36	17	56	26	4.2	1.9	9.9	252	9.8	4.4	84	95	3/8
CP3550-120AC4	615 160 7750	12,000		1.5	1,100	4	100	3/8-24	36	17	56	26	3.7	1.7	9.9	252	6.0	2.6	84	95	3/8
CP3550-120AB45	615 160 7770	12,000		1.5	1,100	4.5	115	5/8-11	36	17	56	26	4.1	1.9	9.9	252	7.5	4.1	84	95	3/8
CP3550-120AB5	615 160 7790	12,000		1.5	1,100	5	125	5/8-11	36	17	56	26	4.2	1.9	9.9	252	9.8	4.4	84	95	3/8

All models: Hose int. 3/8" (10mm) - @90 PSI (@6.3 Bar)

Listed specifications are for reference only. Please check documents in each tool.



# GRINDING

## CP3650 ENGINEERED FOR YOUR PRODUCTIVITY

**UNIQUE  
FEATURES**  
Premium Tool



### HIGH PRODUCTIVITY



- Powerful governed motor offers a higher torque at maximum operating speed, to increase productivity
- Excellent power to weight ratio 2.4 hp for 3.4 lbs / 1,800 W for 1.4 kg
- Spindle lock button, for single tool abrasive replacement
- Autobalancer optimizes contact between abrasive and application, increasing productivity by 15%

### GRINDING, SANDING & CUTTING APPLICATIONS

- Foundries, Metalworking
- Shipyards, Rolling stock
- Oil, Gas & Petrochemical Maintenance on cast iron, steel, stainless steel, aluminum, composite, magnesium, titanium...

### LOW NOISE LEVEL EXHAUST, WITH BUILT IN ANTI-BARKING VALVE

Optional silencer lowers noise levels down to 68dBa. Prevents dust from entering the tool when the motor stops. Optional silencer attachment reduces.

### STREAMLINED AND ERGONOMIC TWO POSITION SAFETY TRIGGER

Trigger may be positioned above or below tools housing for optimal handling.

### COMPOSITE OVER-SLEEVE

Thermal insulating sleeve provides greater comfort and grip for safer extended operation.

### FAST AND EASY ABRASIVE CHANGE

Spindle lock feature allows quicker abrasive replacement to reduce tool downtime.



### GREAT PRODUCTIVITY AND DURABILITY

Powerful governed 2.4hp (1,800W) motor provides maximum torque at the right speed.

### VIBRATION DAMPING SIDE HANDLE

For greater operator comfort. May be positioned for either left or right hand use.

### UNIQUE KEYLESS, ADJUSTABLE GUARD

Robust design rotates 270° for greater versatility. Keyless feature allows quick guard adjustment for great productivity and operator comfort while maintaining maximum safety. Not available on 4" (100mm) and 6" (150mm) models.

### AUTOBALANCER (OPTIONAL)

Compensates for abrasive vibration to optimize contact between the abrasive and application. Autobalancer feature can increase material removal by up to 15% (VK versions only).



### SUPER DURABLE SPIRAL BEVEL GEAR

The advanced design of the helical bevel gear and pinion allows the spiral shaped teeth to engage gradually. This design reduces vibration and decreases stress on the gears while transmitting torque to the abrasive. This feature allows for service intervals of up to 2,000 hours.

OPTION



**ALLEN KEY FOR TIME  
SAVING AND IMPROVED SAFETY**



# 2.4 hp (1,800 W) Angle Wheel Grinders 4", 5" & 6"

## The CP3650 Series Benefits

### SUPERLATIVE PERFORMANCE & ERGONOMICS

- Industrial angle wheel grinder
- Industrial grade durability with up to a 2,000 hour maintenance interval
- Fast single tool abrasive replacement



### CP3650-100AB6VK 10,000 RPM



#### FEATURES

- High power and torque motor
- Superior durability bevel gearing
- Spindle lock button



CP3650-120AB5

### CP3650-120AB45 12,000 RPM



#### FEATURES

- High power and torque motor
- Superior durability bevel gearing
- Spindle lock button



See accessories on pages 116-122

### CP3650-120AB5VK 12,000 RPM



#### FEATURES

- High power and torque motor
- Superior durability bevel gearing
- Spindle lock button



### CP3650-120AB5VK

#### CP3650-120AH5VK

Similar features as CP3650-AB5VK with HEX spindle thread



**SINGLE ALLEN KEY ABRASIVE REPLACEMENT FOR TIME SAVINGS, AND IMPROVED SAFETY**

GENERAL MAINTENANCE INDUSTRIAL MAINTENANCE & PRODUCTION SUPER INDUSTRIAL

MODEL	PART NUMBER	FREE SPEED		POWER		MAX WHEEL CAPACITY		SPINDLE THREAD	AIR CONS. AT FREE SPEED		AIR CONS. @LOAD		NET WEIGHT		LENGTH		VIBRATION LEVEL ISO 28927 (M/S <sup>2</sup> )		SOUND PRESS. ISO 15744 - dB(A)	SOUND POWER	AIR INLET
		rpm		hp	W	in.	mm		in.	cfm	l/s	cfm	l/s	lb	kg	in.	mm	a			
CP3650-135AC4FK	615 160 7170	13,500		2.4	1,800	4	100	3/8-24	53	25	74	35	3.4	1.5	9.4	238	9.9	5.0	82	93	3/8
CP3650-120AB5	615 160 7220	12,000		2.4	1,800	5	125	5/8-11	42	20	68	32	3.9	1.8	9.4	238	7.5	2.5	82	93	3/8
CP3650-120AB45	615 160 7320	12,000		2.4	1,800	4.5	115	5/8-11	42	42	68	32	3.9	1.8	9.4	238	7.8	4.6	82	93	3/8
CP3650-120AA5	615 160 7210	12,000		2.4	1,800	5	125	M14	42	20	68	32	3.9	1.8	9.4	238	7.1	2.2	82	93	3/8
CP3650-120AA45	615 160 7310	12,000		2.4	1,800	4.5	115	M14	42	42	68	32	3.9	1.8	9.4	238	7.8	4.6	82	93	3/8
CP3650-120AH5VK	615 160 7200	12,000		2.4	1,800	5	125	HEX	42	20	68	32	4.3	2	9.4	238	4.5	1.1	79	90	3/8
CP3650-120AB5VK	615 160 7190	12,000		2.4	1,800	5	125	5/8-11	42	20	68	32	4.2	1.9	9.4	238	4.5	1.1	79	90	3/8
CP3650-120AA5VK	615 160 7180	12,000		2.4	1,800	5	125	M14	42	20	68	32	4.2	1.9	9.4	238	4.5	2.0	79	90	3/8
CP3650-100AB5VK	615 160 7300	10,000		2.4	1,800	6	150	5/8-11	42	20	68	32	4.2	1.9	9.4	238	5.2	1.5	79	90	3/8

All models: Hose Int. 1/2" (13 mm) - @90 PSI (@6.3 Bar)

Listed specifications are for reference only. Please check documents in each tool.



# GRINDING

**CP857** ★★



7,500 RPM

**POWERFUL & DURABLE**



## FEATURES

- Aluminum alloy housing
- Helical bevel gear design
- 1.3 hp (940 W) high performance motor

## BENEFITS

- Ideal for general maintenance applications
- Rugged housing
- Durability



**CP857**

1.1 & 1.3 hp (850 & 940 W) Angle Wheel Grinders 7"

**CP9123** ★



7,500 RPM



**ROBUST CONSTRUCTION**

## FEATURES

- Aluminum alloy housing
- Rubber handle grip

## BENEFITS

- General maintenance applications
- Rugged housing
- Durability and performance



**CP9123**



See accessories on pages 116-122

★ GENERAL MAINTENANCE   ★★ INDUSTRIAL MAINTENANCE & PRODUCTION   ★★★ SUPER INDUSTRIAL

MODEL	PART NUMBER	FREE SPEED		POWER		MAX WHEEL CAPACITY		SPINDLE THREAD	AIR CONS. AT FREE SPEED		AIR CONS. @LOAD		NET WEIGHT		LENGTH		VIBRATION LEVEL ISO 28927 (M/S2)		SOUND PRESS.	SOUND POWER	AIR INLET
		rpm	hp	W	in.	mm	in.	cfm	l/s	cfm	l/s	lb	kg	in.	mm	a	k	ISO 15744 - dB(A)		in.	
CP857	T024387	7,500	1.3	940	7	180	5/8-11	24	11.3	24	11.3	6.3	2.8	13.1	334	4.0	1.3	102	113	3/8	
CP9123	615 195 9123	7,500	1.1	850	7	180	5/8-11	40	18.9	24	11.3	7.5	3.4	13.4	340	4.3	1.3	93	104	3/8	

All models: Hose int. 5/8" (16mm) - @90 PSI (@6.3 Bar)

Listed specifications are for reference only. Please check documents in ea





# CP3850

**THE ULTIMATE MATERIAL REMOVAL TOOL**

**UNIQUE FEATURES**  
Premium Tool



## HIGH PRODUCTIVITY



- Powerful governed motor offers a higher torque at maximum operating speed, increasing productivity
- Highest power to weight ratio 2.8 hp for 5.1 lbs / 2,100 W for 2.7 kg
- Spindle lock button, for single tool abrasive replacement
- Autobalancer optimizes contact between abrasive and application, increasing the productivity by 15%

## GRINDING, SANDING & CUTTING APPLICATIONS

- Foundries, Metalworking
- Shipyards, Rolling stock
- Oil, Gas & Petrochemical Maintenance
- Composite materials

### ERGONOMIC DESIGN

Curved design for greater comfort during extended use

### DOUBLE SAFETY LEVER

Streamline design facilitates single hand engagement and helps reduce risk of accidental start up

### 360° AIR EXHAUST MUFFLER

Provides low noise level, as low as 84 dB(A) for greater operator comfort during extended use

### MULTI-POSITION GUARD

The 220° multi-position guard provides maximum operator comfort, flexibility and protection

### FAST AND EASY DISC CHANGE

The spindle lock button allows a quicker abrasive replacement



### MULTI-POSITION VIBRATION DAMPING SIDE HANDLE

Adjustable 360° side handle, left and right, for greater operator comfort

### LOW PROFILE ANGLE HEAD

Allows grinding in restricted areas and improves operator's view of the abrasive



### DEBRIS MAGNET

Collects debris and extends life of the beveled gear extends life of bevel gear

### AUTOBALANCER (OPTIONAL) NOT FOR ANSI MARKET

Compensates abrasive vibration and optimizes the contact between the abrasive and application for a material removal rate increased up to +15%



### SUPER DURABLE SPIRAL BEVEL GEAR

The spiral shaped teeth of the helical bevel gear and pinion engage gradually to reduce vibration and stress of torque transmission resulting in up to 2000 hours durability between service intervals

### OPTION



**ALLEN KEY FOR TIME SAVING AND IMPROVED SAFETY**



# GRINDING

2.8 hp (2,100 W) Angle Wheel Grinders 7" & 9"

## The CP3850 Series Benefits

### SUPERLATIVE PERFORMANCE & ERGONOMICS

- Industrial angle wheel grinder
- Highest durability in demanding applications with up to 2,000 hours maintenance intervals
- Superior torque for maximum productivity



### CP3850-85AB7V

8,500 RPM



#### FEATURES

- Low profile angle head
- Superior durability bevel gearing
- Double action safety lever

FOR ANSI MARKET



CP3850-85AB7V

### CP3850-77AB7V

Same features as CP3850-85AB7V with 7,700 rpm

### CP3850-60AB9V



6,000 RPM



FOR ANSI MARKET

#### FEATURES

- Low profile angle head
- Superior durability bevel gearing
- Double action safety lever



CP3850-60AB9V



See accessories on pages 116-122



MODEL	PART NUMBER	FREE SPEED	POWER		MAX WHEEL CAPACITY		SPINDLE THREAD	AIR CONS. AT FREE SPEED		AIR CONS. @LOAD		NET WEIGHT		LENGTH		VIBRATION LEVEL ISO 28927 (M/S2)		SOUND PRESS.	SOUND POWER	AIR INLET
		rpm	hp	W	in.	mm	in.	cfm	l/s	cfm	l/s	lb	kg	in.	mm	a	k	ISO 15744 - dB(A)		in.
CP3850-85AB7V	615 160 7440	8,500	2.8	2,100	7	180	5/8-11	36	17	77	36	6.6	3	13.4	340	5.7	1.1	87	98	1/2
CP3850-77AB7V	615 170 4960	7,700	2.8	2,100	7	180	5/8-11	33	16	69	32	6.6	3	13.4	340	5.3	1.1	84	95	1/2
CP3850-60AB9V	615 160 7340	6,000	2.8	2,100	9	230	5/8-11	44	21	80	38	7	3.2	13.4	340	6.8	1.1	93	104	1/2

All models: Hose int. 5/8" (16mm) - @90 PSI (@6.3 Bar)

Listed specifications are for reference only. Please check documents in each tool.



2.8 hp (2,100 W) Angle Wheel Grinders 7" & 9"

**CP3850-65AB9VE** ★★ ★

6,500 RPM



**CP3850-65AH9VE**

Same features as CP3850-65AB9VE with Hex spindle

**FEATURES**

- Low profile angle head
- Superior durability bevel gearing
- Double action safety lever

**CE CERTIFICATION / NOT FOR ANSI MARKET**

**CP3850-85AB7VE**

8,500 RPM



**FEATURES**

- Low profile angle head
- Superior durability bevel gearing
- Double action safety lever



**CE CERTIFICATION / NOT FOR ANSI MARKET**



**CP3850-85AB7VE**

**CP3850-85AH7VE**



Same features as CP3850-85AB7VE with Hex spindle



**SINGLE ALLEN KEY ABRASIVE REPLACEMENT FOR TIME SAVINGS, AND IMPROVED SAFETY**

**CE CERTIFICATION / NOT FOR ANSI MARKET**



**CP3850-65AB9VE**



See accessories on pages 116-122

★ GENERAL MAINTENANCE   ★★ INDUSTRIAL MAINTENANCE & PRODUCTION   ★★★ SUPER INDUSTRIAL

MODEL	PART NUMBER	FREE SPEED		POWER		MAX WHEEL CAPACITY		SPINDLE THREAD	AIR CONS. AT FREE SPEED		AIR CONS. @LOAD		NET WEIGHT		LENGTH		VIBRATION LEVEL ISO 28927 (M/S <sup>2</sup> )		SOUND PRESS. ISO 15744 - dB(A)	SOUND POWER	AIR INLET
		rpm	hp	W	in.	mm	in.		cfm	l/s	cfm	l/s	lb	kg	in.	mm	a	k			
CP3850-85AB7VE	615 170 4920	8,500	2.8	2,100	7	180	5/8-11	36	17	77	36	6.4	2.9	13.4	340	5.7	1.1	87	98	1/2	
CP3850-85AH7VE	615 170 4930	8,500	2.8	2,100	7	180	HEX	36	17	77	36	5.9	2.7	13.4	340	5.4	1.0	87	98	1/2	
CP3850-65AB9VE	615 170 4940	6,500	2.8	2,100	9	230	5/8-11	44	21	80	38	5.9	2.7	13.4	340	5.7	1.1	93	104	1/2	
CP3850-65AH9VE	615 170 4950	6,500	2.8	2,100	9	230	HEX	44	21	80	38	6.4	2.9	13.4	340	5.4	1.0	93	104	1/2	

All models: Hose int. 5/8" (16mm) - @90 PSI (@6.3 Bar)

Listed specifications are for reference only. Please check documents in each tool.



**CP3330**  
**CP3340**  
**BEST IN CLASS**  
**PRODUCTIVITY**

**★**  
**UNIQUE FEATURES**  
*Premium Tool*

**NEW**



**BEST IN CLASS PRODUCTIVITY** ★★

- Optimal Operator Safety
- Boast best in class power for 2 times faster Material Removal over Competition
- Packing an Over Speed Shut-off Device

**GRINDING & CUTTING APPLICATIONS**

- Metal working, Fabrication, Foundries & Casting plants, Shipbuilding, Oil & Gas
- Contouring, Deburring, Cutting, Finishing, Weld cleaning
- Materials : cast iron, steel, stainless steel, aluminum, composite, magnesium, titanium
- With 7" and 9" abrasive grinding and cutting wheels, and 6" cup wheels

**HIGH POWER MOTOR**

- High torque 3.7 hp and 4.5 hp motors for the most demanding applications

**2 TIMES FASTER MATERIAL REMOVAL VERSUS COMPETITION**

**STREAMLINED SAFETY LEVER**

- Allows easy tool operation while wearing heavy gloves

**OVER SPEED SHUT-OFF DEVICE**

- Avoids abrasive bursts in case of accidental air pressure variations

**HIGH RESISTANCE PROTECTIVE GUARD**

- Smart design combines durability and operator safety (2.6 mm / 12 gauge thick)

**AIR GOVERNOR**

- Maintains abrasive speed and productivity under operator load

**ROBUST HOUSING**

- Durable aluminium housing, designed to withstand tough usage



ONLY FOR ANSI MARKET



## 3.7 & 4.5 hp Vertical Grinders 6" to 9"

### The CP3330/3340 Series Benefits

#### BEST IN CLASS PRODUCTIVITY AND OPTIMAL OPERATOR SAFETY

- Industrial vertical wheel grinder
- Avoids abrasive bursts in case of accidental air pressure variations
- Maintains abrasive speed under operator load

### CP3330-SALAVAD 8,500 RPM



### CP3330-SALAVEL

Same features as CP3330-SALAVAD with 6,000 RPM and 9" (230mm) grinding wheel

#### FEATURES

- Integrated Over Speed Shut-off device for improved safety
- Streamlined safety lever
- Robust aluminum housing

ONLY FOR ANSI MARKET

### CP3330-SALAVET 6,000 RPM



#### FEATURES

- Integrated Over Speed Shut-off device for improved safety
- Streamlined safety lever
- Robust aluminum housing

ONLY FOR ANSI MARKET



See accessories on pages 116-122

### CP3340-SALAVEL 6,000 RPM



#### FEATURES

- Integrated Over Speed Shut-off device for improved safety
- Streamlined safety lever
- Robust aluminum housing



### CP3340-SALAVEL

ONLY FOR ANSI MARKET

### CP3340-SALAVET

Same features as CP3340-SALAVEL with 6,000 RPM for 6" (150mm) cup wheels

### CP3340-SALAVAD

Same features as CP3340-SALAVEL with 8,500 RPM and 7" (180mm) grinding wheel



MODEL	PART NUMBER	FREE SPEED		POWER		MAX WHEEL CAPACITY		SPINDLE THREAD		AIR CONS. AT FREE SPEED		AIR CONS. @LOAD		NET WEIGHT		LENGTH		VIBRATION LEVEL ISO 28927 (M/S <sup>2</sup> )		SOUND PRESS. ISO 15744 -dB(A)	SOUND POWER	AIR INLET
		rpm	hp	W	in.	mm	in.	cfm	l/s	cfm	l/s	lb	kg	in.	mm	a	k					
CP3330-SALAVET	615 160 9210	6,000	3.7	2,800	6"	150	5/8-11	22	10	70	33	10.8	4.9	9.8	250	2.6	1.9	95	106	1/2		
CP3330-SALAVAD	615 160 9220	8,500	3.7	2,800	7"	180	5/8-11	22	10	83	39	10.5	4.8	9.8	250	5.2	1.5	91	102	1/2		
CP3330-SALAVEL	615 160 9230	6,000	3.7	2,800	9"	230	5/8-11	22	10	70	33	11.2	5.1	9.8	250	4.4	1.6	95	106	1/2		
CP3340-SALAVET	615 160 9270	6,000	4.5	3,400	6"	150	5/8-11	34	16	95	45	12.8	5.8	9.8	250	3.6	1.3	95	106	1/2		
CP3340-SALAVAD	615 160 9280	8,500	4.5	3,400	7"	180	5/8-11	61	29	110	52	12.3	5.6	9.8	250	4.9	1.7	100	111	1/2		
CP3340-SALAVEL	615 160 9290	6,000	4.5	3,400	9"	230	5/8-11	34	16	95	45	13.1	6	9.8	250	2.5		95	106	1/2		

All models: Hose int. 5/8" (16mm) - @90 PSI (@6.3 Bar)

Listed specifications are for reference only. Please check documents in each



# GRINDING

## CP3349 MAXIMUM POWER FOR MAXIMUM CAPACITY

★  
**UNIQUE  
FEATURES**  
Premium Tool



### MAXIMUM PRODUCTIVITY



- Powerful governed motor provides unparalleled torque levels at rated speeds and boasts 4 hp (3,000 W) of power wherever maximum power is needed
- Double action safety lever and rubber covered side handle provide easy control and improved operator grip

### GRINDING & CUTTING APPLICATIONS

- Foundries, Metalworking
- Shipyards, Rolling stock
- Oil, Gas & Petrochemical Maintenance on cast iron, steel, stainless steel, aluminum, composite, magnesium, titanium...

### SUPERIOR COMFORT

Curved design positions wrists straight to improve control and increase operator comfort

### ERGONOMIC DOUBLE ACTION SAFETY LEVER

Streamline design facilitates single hand engagement and helps reduce risk of accidental start up

### ROBUST EXHAUST GRID

Withstands rough use

### HIGH RESISTANCE PROTECTIVE GUARD

Takes operator safety at another level



### ROBUST HOUSING

Durable streamlined housing designed to withstand tough applications

### POWERFUL MOTOR

High torque 4 hp (3000 W) motor for the most demanding applications

### REINFORCED RUBBER GRIP

Durable handle provides a steady grip and increases operator comfort and productivity

### BUILT IN OIL TANK

Durable handle provides a steady grip and increases operator comfort and productivity



# 4 hp Vertical Grinders 6" to 9"

## The CP3349 Series Benefits



### ULTIMATE PERFORMANCE IN HEAVY APPLICATIONS

- Industrial vertical wheel grinder
- Highest durability in demanding applications up to 2,000 hours maintenance intervals
- Superior torque for maximal productivity

## CP3349-SALAVADE 7,700 RPM



#### FEATURES

- Durable and robust housing
- Built in oil tank for continuous lubrication
- Double action safety lever

**CE CERTIFICATION / NOT FOR ANSI MARKET**

## CP3349-SALAVET 6,000 RPM



#### FEATURES

- Integrated overspeed device for improved safety
- Built in oil tank for continuous lubrication
- Double action safety lever

**FOR ANSI MARKET**

## CP3349-SALAVETE

**CE CERTIFICATION / NOT FOR ANSI MARKET**

## CP3349-SALAVEL 6,500 RPM



### FEATURES

- Integrated overspeed device for improved safety
- Built in oil tank for continuous lubrication
- Double action safety lever

**FOR ANSI MARKET**



## CP3349-SALAVEL

## CP3349-SALAVELE

**CE CERTIFICATION / NOT FOR ANSI MARKET**



See accessories on pages 116-122



MODEL	PART NUMBER	FREE SPEED		POWER		MAX WHEEL CAPACITY		SPINDLE THREAD		AIR CONS. AT FREE SPEED		AIR CONS. @LOAD		NET WEIGHT		LENGTH		VIBRATION LEVEL ISO 28927 (M/S <sup>2</sup> )		SOUND PRESS.	SOUND POWER	AIR INLET
		rpm	hp	W	in.	mm	in.	in.	cfm	l/s	cfm	l/s	lb	kg	in.	mm	a	k	ISO 15744 - dB(A)	ISO 15744 - dB(A)	in.	
<b>For ANSI NA Market</b>																						
CP3349-SALAVEL	615 160 9070	6,000	4	3,000	9"	230	5/8-11	27	13	93	44	9.7	4.4	11	280	4.0	-	87	98	1/2		
CP3349-SALAVET	615 160 9080	6,000	4	3,000	6"	150	5/8-11	25	12	91	43	9.7	4.4	11	280	2.5	-	84	95	1/2		
<b>For CE Market</b>																						
CP3349-SALAVADE	615 160 9110	7,700	4	3,000	7"	180	5/8-11	40	19	97	46	9.2	4.2	11	280	4.6	-	88	99	1/2		
CP3349-SALAVETE	615 160 9150	6,000	4	3,000	6"	150	5/8-11	25	12	91	43	9.7	4.4	11	280	2.5	-	84	95	1/2		
CP3349-SALAVELE	615 160 9130	6,500	4	3,000	9"	230	5/8-11	27	13	93	44	9.7	4.4	11	280	4.0	-	87	98	1/2		

All models: Hose int. 5/8" (16mm) - @90 PSI (@6.3 Bar)

Listed specifications are for reference only. Please check documents in each tool



# GRINDING

## Accessories Angle Grinders

### INCLUDED ACCESSORIES

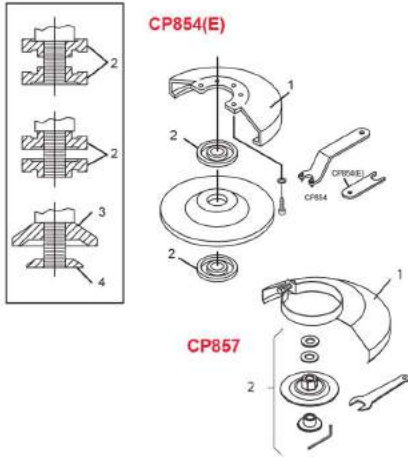

MODEL	ITEM	DESCRIPTION	PART NUMBER	
<b>CP7500</b>		2" Grinding wheel 60 Grit (5 PC) 20,000 (max speed)	894 016 2768	
		2" Grinding wheel 80 Grit (5 PC) 20,000 (max speed)	894 016 2769	
		2" Grinding wheel 120 Grit (5 PC) 20,000 (max speed)	894 016 2770	
		Pin wrench	894 016 2763	
		Spanner	894 016 2759	
		Nuts	894 016 2765	
		2" Cutting wheel 20,000 (max speed)	894 016 4490	
<b>CP7550-CI-BI-A</b>		5" (125 mm) Disc Guard	894 017 3446	
		Flange kit for 3/8"-24 UNF (Flange+nut)	894 017 3437	
		Flange kit for 5/8"-11 UNC (Flange+nut+screw)	894 017 3438	
		Flange kit for M14 (Flange+nut+screw)	895 025 1317	
		Tool kit (Pin wrench+spanner+key)	894 017 3513	
		Side Handle	205 052 4063	
		Exhaust hose kit	894 017 3439	
<b>CP854</b>	1	4" (100mm) Disc Guard	C136898	
	2	Nut	C138512	
	3	Wheel adapter	C128495	
	4	Wheel retainer, nut	C050588	
	.	Wrench stop spanner	C136927	
	.	Wrench wheel spanner	C136926	
	.	Wrench 5/8" open end	C139702	
.	Side handle	C136901		
<b>CP854E</b>	1	5" (125mm) Disc Guard	C136898	
	2	Nut	C138512	
	.	Wheel adapter	KF141861	
<b>CP857</b>	1	7" (180mm) Disc Guard	C139081	
	.	Wrench-spindle	C141027	
	.	Wrench -3/8 Hex	P084363	
	2	Adapter	C087920	
<b>CP9105Q-B, CP9106Q-B, CP9107, CP9108Q-B</b>		Spanner (2)	CA144807	
		Double Ended Spanner	205 049 6453	
<b>CP9111Q-B, CP9112Q-B</b>		Spanner	205 049 6443	
		4" (100 mm) Disc Guard	205 053 4003	
<b>CP9120CR CP7540C</b>		Flange kit for 3/8"-24 UNF (Flange + nut)	894 017 3436	
		Tool kit (Pin wrench + 2 spanners)	894 017 3440	
		Side Handle	205 052 4063	
		Exhaust hose kit for CP7540C	894 017 3439	
		4" (100 mm) Disc Guard	205 053 4003	
<b>CP9120CRN CP7540CN</b>		Flange kit for 3/8"-24 UNF (Flange+nut+2 nuts)	894 017 3435	
		Tool kit (Pin wrench + 2 spanners)	894 017 3440	
		Side Handle	205 052 4063	
		Exhaust hose kit for CP7540CN	894 017 3439	
		5" (125 mm) Disc Guard	205 053 4023	
<b>CP9121CR/BR/AR</b>		Flange kit for 3/8"-24 UNF (Flange+nut)	894 017 3437	
		Flange kit for 5/8"-11 UNC (Flange+nut)	894 017 3438	
		Flange kit for M14 (Flange+nut)	895 025 1317	
		Tool kit (Pin wrench+spanner)	894 017 3513	
		Side Handle	205 052 4063	
	<b>CP9122BR/CR CP7545-C/B</b>		4.5" (115 mm) Disc Guard	205 053 4013
			Flange kit for 3/8"-24 UNF (Flange+nut)	894 017 3437
		Flange kit for 5/8"-11 UNC (Flange+nut+screw*)	894 017 3438	
		Tool kit (Pin wrench+spanner+key*)	894 017 3513	
		Side Handle	205 052 4063	
		Exhaust hose kit for CP7545	894 017 3439	
	*not used on CP9122			
<b>CP9123</b>		Disc Guard	205 050 0973	
		Flange	205 050 0963	
		Flange Nut	205 050 0983	
		Spanner	205 050 1193	
		Hex. Key	205 050 1213	
		Wheel retainer, nut	KF142108	
		Wrench stop spanner	C136927	
		Wrench spanner	KF141865	
		Side handle	C136901	





# Accessories Angle Grinders



GRINDING

## INCLUDED ACCESSORIES

CP3040...



For 3/8" & 5/8" hole disc

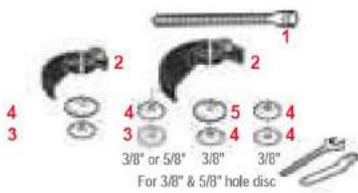

For 3/8" & 5/8" hole disc

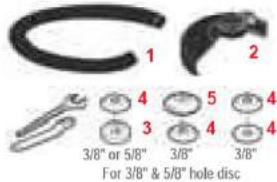

For 3/8" & 5/8" hole disc



For 7/8" hole disc



For 7/8" hole disc



For 7/8" hole disc



For 5/8" hole disc



MODEL	ITEM	DESCRIPTION	PART NO.
CP3040-GABTIM	1	ø 4" (100mm) Disc Guard	205 054 5213
CP3040-GASTIM	2	Rear flange 3/8"	205 054 4263
	3	Rear flange 5/8"	205 055 2633
	4	Flange nut 3/8"	205 054 4273
	5	Flange nut 5/8"	205 055 2643
	.	Spanner Wrench (for 3/8" flange)	205 054 4293
	.	Pin Wrench (for 3/8" flange)	205 054 4283
	.	Spanner Wrench (for 5/8" flange)	205 054 4303
	.	Spanner Wrench (for 5/8" flange)	205 055 2953
	.	Pin wrench (for 5/8" flange)	205 055 2943
CP3019-...A3	1	Exhaust hose L= 31" (0.8m)	615 875 1060
CP3019-...A4	2	3" (76mm) Disc Guard (A3)	615 504 1550
	2	4" (100mm) Disc Guard (A4)	615 504 1600
	3	Flange	615 606 5150
	4	Flange	615 502 0640
	5	Rear flange	615 503 1440
	.	Pin Wrench	615 802 0080
	.	Flat Wrench 7/16" (11mm)	615 801 0030
CP3109-13A4ES	1	Exhaust hose L= 60" (1.5m)	615 875 1130
CP3109-13A4	2	4" (100mm) Disc Guard	615 504 1600
	3	Flange	615 606 5150
	4	Flange	615 502 0640
	5	Rear Flange	615 503 1440
	.	Pin Wrench	615 802 0080
	.	Flat Wrench 7/16" (11mm)	615 801 0030
CP3450-12AA5	1	5" (125mm) Disc Guard	615 504 1860
	2	Rear flange M14	615 503 1590
	3	Flange nut M14	615 502 0770
	4	Safety screw	615 614 0900
		Flat wrench: 205 048 4230 / Pin wrench: 205 048 6673 / Hex wrench: 895 101 1464	
CP3450-12AC45	1	4.5" (115mm) Disc Guard	615 504 2030
	2	Rear flange 3/8"	205 053 3943
	3	Flange nut 3/8"	205 053 3973
	4	Safety screw	615 614 0900
		Flat wrench: 205 048 4230 / Pin wrench: 205 048 5003 / Hex wrench: 895 101 1464	
CP3450-12AB5	1	5" (125mm) Disc Guard	615 504 1860
	2	Rear flange 5/8"	615 503 1600
	3	Flange nut 5/8"	615 502 0780
	4	Safety screw	615 614 0900
CP3450-12AC4	1	4" (100mm) Disc Guard	615 504 1880
CP3450-12AC4R	2	Flange (2)	894 017 3436
		Flat wrench	205 048 4230
		Pin wrench	205 048 5003
		Flat wrench: 205 048 4230 / Pin wrench: 205 048 6673 / Hex wrench: 895 101 1464	
MODEL		DESCRIPTION	PART NO.
CP3450-..		Side handle	205 052 4063
		Exhaust kit	205 054 1503



# GRINDING

## Accessories Angle Grinders

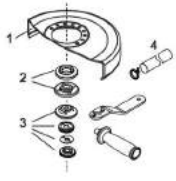

### INCLUDED ACCESSORIES

MODEL	ITEM	DESCRIPTION	PART NO.
<b>CP3650-120AC4</b> 	1	4" (100mm) Disc guard	615 504 2360
	2	Rear flange 3/8" grinding/ cutting wheel type 1 - 41	894 017 3436
	3	Flange nut 3/8" grinding/ cutting wheel type 1 - 41	894 017 3436
		Rear flange 3/8" depressed center type 27	894 017 3435
		Flange nut 3/8" depressed center type 27	894 017 3435
		Flanges (x2) 3/8" grinding/ cutting wheel type 1 - 41	894 017 3435
	4	Exhaust hose kit	615 813 2520
		Pin wrench	205 048 5003
		Side handle	205 052 4063

MODEL	ITEM	DESCRIPTION	PART NO.
<b>CP3650-120AA45</b> <b>CP3650-120AA5</b> 	1	4.5" (115mm) Disc guard	615 504 2370
	1	5" (125mm) Disc guard	615 504 2380
	2	Rear flange M14	895 025 1317
	3	Flange nut M14	895 025 1317
	4	Safety screw	895 025 1317
	5	Exhaust hose kit	615 813 2520
		Pin wrench	205 048 6673
		Hex. Wrench	895 101 1464
		Side handle	205 052 4063

MODEL	ITEM	DESCRIPTION	PART NO.
<b>CP3650-120AB45</b> <b>CP3650-120AB5</b> 	1	4.5" (115mm) Disc guard	615 504 2370
	1	5" (125mm) Disc guard	615 504 2380
	2	Rear flange 5/8"	819 017 3438
	3	Flange nut 5/8"	819 017 3438
	4	Safety screw	894 017 3438
	5	Exhaust hose kit	615 813 2520
		Pin wrench	205 048 6673
		Hex. wrench	895 101 1464
		Side handle	205 052 4063

MODEL	ITEM	DESCRIPTION	PART NO.
<b>CP3650-120AA5VK</b> <b>CP3650-120AB5VK</b> <b>CP3650-120AH5VK</b> <b>CP3650-100AB6VK</b> 	1	Silencer kit	615 396 1660
	2	Vibration-damping side handle	615 576 0660
	3	Hose clamp	615 263 0240

MODEL	ITEM	DESCRIPTION	PART NO.
<b>CP3650-120AA5</b> <b>CP3650-120AB5</b> <b>CP3650-120AA45</b> <b>CP3650-120AB45</b> 		3/8" air hose nipple for 1/2" (13 mm) ID hose	615 704 0270
	1	Hose clamp	615 263 0240
	2	Exhaust hose	615 875 1130
	3	Side handle	615 576 0380

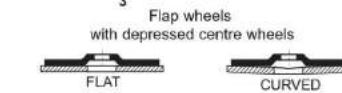
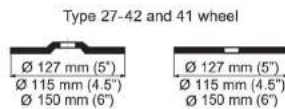

MODEL	ITEM	DESCRIPTION	PART NO.
<b>CP3650-120AB45</b> <b>CP3650-120AB5</b> 	1	4.5" (115 mm) Multi-position guard (AB45)	615 504 1980
	1	5" (127 mm) Multi-position guard (AB5)	615 504 1970
	2	Rear flange	615 503 1410
	3	Front flange	615 502 0670
	4	Safety screw	615 614 0760
		Pin wrench 1-3/8" (35 mm)	615 802 0100
		Hex. key 1/4" A/F (6.35 mm)	615 802 0570

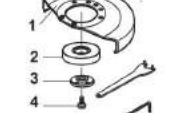
MODEL	ITEM	DESCRIPTION	PART NO.
<b>CP3650-120AB5VK</b> 	1	5" (127 mm) Multi-position guard	615 504 1930
	2	Auto balancer	615 990 1810
	3	Front flange	615 502 0670
	4	Safety screw	615 614 0760
		Hex. key 1/4" A/F (6.35 mm)	615 802 0570

MODEL	ITEM	DESCRIPTION	PART NO.
<b>CP3650-135AC4FK</b> 	1	4" (100 mm) Disc Guard	615 504 1960
	2	Flange (2)	615 606 5150
	3	Rear Flange	615 503 5150
		Flat wrench, 5/8" (16 mm)	615 802 5120
		Pin wrench 20-3 mm	615 802 0080

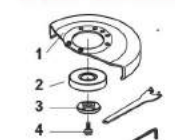
MODEL	ITEM	DESCRIPTION	PART NO.
<b>CP3650-120AA5VK</b> 	1	5" (127 mm) Multi-position guard	615 504 1930
	2	Auto balancer	615 990 1810
	3	Front flange	615 502 0660
	4	Safety screw	615 614 0760
		Pin wrench 1-3/8" (6.35 mm)	615 802 0100
		Hex. key 1/4" A/F (6.35 mm)	615 802 0570

MODEL	ITEM	DESCRIPTION	PART NO.
<b>CP3650-120AA45</b> <b>CP3650-120AA5</b> 	1	4.5" (115 mm) Multi-position guard (AA45)	615 504 1980
	1	5" (127 mm) Multi-position guard (AA5)	615 504 1970
	2	Rear flange	615 503 1340
	3	Front flange	615 502 0660
	4	Safety screw	615 614 0760
		Pin wrench 1-3/8" (35 mm)	615 802 0100
		Hex. key 1/4" A/F (6.35 mm)	615 802 0570

MODEL	ITEM	DESCRIPTION	PART NO.
<b>CP3650-100AB6VK</b> 	1	6" (150 mm) Disc Guard	615 504 2020
	2	Auto balancer	615 990 1810
	3	Front Flange	615 502 0670
	4	Safety screw	615 614 0760
		Pin wrench 1-3/8" (35 mm)	615 802 0100
		Hex. key 1/4" A/F (6.35 mm)	615 802 0570



# Accessories Angle and Vertical Grinders



GRINDING

## INCLUDED ACCESSORIES

MODEL	ITEM	DESCRIPTION	PART NO.
CP3850-...	1	1/2" Air hose nipple, 5/8" (16 mm) ID hose	615 704 0140
	2	Vibration-damping side handle	615 576 0660



MODEL	ITEM	DESCRIPTION	PART NO.
CP3850-60AB9V	1	9" (230 mm) Disc Guard	205 055 9613
	2	Rear Flange	615 503 1530
	3	Nut 5/8"	615 608 0490
	4	Safety screw	615 614 0340
	.	Hex. key 6 mm	615 802 0560

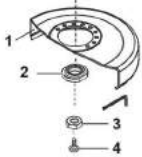

MODEL	ITEM	DESCRIPTION	PART NO.
CP3850-85AH7VE	1	7" (180 mm) Disc Guard (AH7VE)	615 504 2115
	1	9" (230 mm) Disc Guard (AH9VE)	615 504 2125
CP3850-65AH9VE	2	Auto balancer (AH7VE)	615 990 1940
	3	Rear Flange	615 503 1640
	4	Front Flange	615 502 0850
	.	Pin wrench 1-3/8" (35 mm)	615 802 0100
	.	Hex. key 6 mm	615 802 0560



MODEL	ITEM	DESCRIPTION	PART NO.
CP3850-77AB7V	1	7" (180 mm) Disc Guard	615 504 2135
CP3850-85AB7V	2	Rear Flange	615 503 1530
	3	Nut 5/8"	615 608 0490
	4	Safety screw	615 614 0340
	.	Hex. key 6 mm	615 802 0560

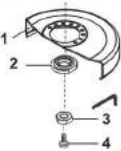

MODEL	ITEM	DESCRIPTION	PART NO.
CP3850-85AB7VE	1	7" (180 mm) Disc Guard (AB7VE)	615 504 2115
CP3850-65AB9VE	1	9" (230 mm) Disc Guard (AB9VE)	615 504 2125
	2	Auto balancer	615 990 1810
	3	Front Flange	615 502 0670
	4	Safety screw	615 614 0760
	.	Pin wrench 1-3/8" (35 mm)	615 802 0100
	.	Hex. key 6 mm	615 802 0560



MODEL	ITEM	DESCRIPTION	PART NO.
CP3349-SALAVEL	1	9" (230 mm) Disc Guard	615 504 2250
	3	Rear Flange	615 503 1070
	4	Nut	615 542 1040
	5	Locknut	615 614 0340
	.	Flat wrench 1-1/16" (27 mm)	615 801 0770
	.	Hex. key 6 mm	615 802 0560



MODEL	ITEM	DESCRIPTION	PART NO.
CP3349-...	.	1/2" Air hose nipple, 5/8" (16 mm) ID hose	615 704 0140

MODEL	ITEM	DESCRIPTION	PART NO.
CP3349-SALAVELE	1	9" (230 mm) Disc Guard	615 504 1830
	2	Rear flange	615 503 1030
	4	Nut	615 542 1040
	5	Locknut	615 614 0340
	.	Pin Wrench 1-3/8" (35 mm)	615 802 0100
	.	Flat wrench 1-1/16" (27 mm)	615 801 0770
.	Hex. key 6 mm	615 802 0560	



MODEL	ITEM	DESCRIPTION	PART NO.
CP3349-SALAVADE	1	7" (180 mm) Disc Guard	615 504 1820
	2	Rear flange	615 503 1030
	3	Nut	615 542 1040
	4	Locknut	615 614 0340
	.	Pin Wrench 1-3/8" (35 mm)	615 802 0100
	.	Flat wrench 1-1/16" (27 mm)	615 801 0770
.	Hex. key 6 mm	615 802 0560	



MODEL	ITEM	DESCRIPTION	PART NO.
CP3349-SALAVET	1	6" (150 mm) Disc Guard	615 504 1780
	2	Rear flange	615 503 1500
	3	Nut	615 608 0490
	.	Lever	615 595 2020
	.	Hex. key 6 mm	615 802 0610



MODEL	ITEM	DESCRIPTION	PART NO.
CP3349-SALAVETE	1	6" (150 mm) Disc Guard	615 504 1810
	2	Rear flange	615 503 1160
	3	Locknut	615 614 0340
	.	Flat wrench 1-1/16" (27 mm)	615 801 0770
	.	Hex. key 6 mm	615 802 0560



# GRINDING

## Accessories Vertical Grinders



### INCLUDED ACCESSORIES

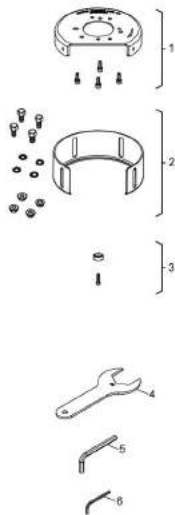

MODEL	ITEM	DESCRIPTION	PART NO.
<b>CP3330/CP3340 SALAVET</b>	1	6" Guard top kit	615 504 2320
	2	6" Guard bottom kit	615 504 2330
	3	Type 6 and 11 wheel retention kit	615 548 3070
	4	Spanner - 51mm	615 802 0720
	5	Hex key - 5/16"	615 802 0730
	6	Hex key - 5/32"	615 802 0740



MODEL	ITEM	DESCRIPTION	PART NO.
<b>CP3330/CP3340 SALAVAD</b>	1	7" Guard kit	615 504 2340
	2	Type 27 and 42 wheel retention kit	615 548 3080
	3	Spanner - 24mm	615 802 0750
	4	Pin wrench - 32mm / ø3	895 029 0147
	5	Spanner - 51mm	615 802 0720
	6	Hex key - 5/16"	615 802 0730
	7	Hex key - 5/32"	615 802 0740

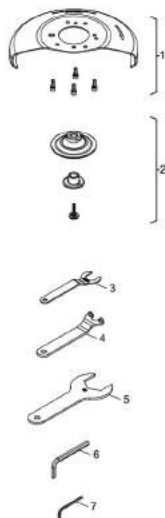

MODEL	ITEM	DESCRIPTION	PART NO.
<b>CP3330/CP3340 SALAVEL</b>	1	9" Guard kit	615 504 2350
	2	Type 27 and 42 wheel retention kit	615 548 3080
	3	Spanner - 24mm	615 802 0750
	4	Pin wrench - 32mm / ø3	895 029 0147
	5	Spanner - 51mm	615 802 0720
	6	Hex key - 5/16"	615 802 0730
	7	Hex key - 5/32"	615 802 0740



# Accessories & Spares Angle Grinders



## OPTIONAL ACCESSORIES



MODEL	DESCRIPTION	PART NO.
<b>CP3450-..</b>	Low Vibration handle	615 576 0780
	Exhaust hose adapter	615 730 1870
	Overhose	205 054 7523
<b>CP3550-....</b>	Low vibration handle	615 576 0780
<b>CP75... </b>	Low vibration handle	615 576 0780

## AUTO-BALANCER



MODEL	DESCRIPTION	PART NO.
<b>CP3349-SALAVEDE/CP3349-SALAVELE</b>	Auto-balancer	615 503 1460
<b>CP3550-AA45/5</b>	Auto-balancer M14	615 990 2020
<b>CP3550-AB45/5</b>	Auto-balancer 5/8"	615 990 2030

## COLLET HOLDER

MODEL	DESCRIPTION	PART NO.
<b>CP3450-12AC..</b>	Collet holder	615 990 1900
	Collet nut	615 607 1540
	Collet 1/4"	615 526 0630

## GREASE GUN

MODEL	DESCRIPTION	PART NO.
<b>CP3450-..</b>	Grease gun (capacity 0.8 oz - 24g)	615 990 1490

## SILENCERS

MODEL	ITEM	DESCRIPTION	PART NO.
<b>CP3019-..</b>	1	Silencer Kit	615 396 1010
	2	Clippable silencer	615 396 1240
<b>CP3109-..</b>	3	Silencer Kit	615 396 1660
	4	Clippable silencer	615 396 6550
<b>CP3450</b>	3	Silencer Kit	615 574 0760

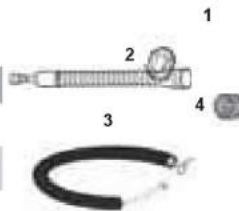

## EXHAUST HOSE

MODEL	DESCRIPTION	PART NO.
<b>CP3109-..</b>	Reinforced cloth-lined exhaust hose L= 30" (0.75m)	615 875 1160



## PAD

MODEL	DESCRIPTION	PART NO.
<b>CP3450-12AC4 AC45</b>	Backing pad ø 4" (100mm) with nut 3/8"	615 990 1900
<b>CP3450-12AA5/AB5</b>	Backing pad ø 5" (125mm) with nut 5/8" & M14	615 990 1910



MODEL	ITEM	DESCRIPTION	PART NO.
<b>CP3650-..</b>	1	Silencer kit	615 396 1660
	2	Vibration-damping side handle	615 576 0660
	3	Hose clamp	615 263 0240
	4	Clippable silencer	615 396 9570
	5	Reinforced cloth-lined exhaust hose L=30" (0.75mm)	615 875 1160
	6	Grease gun include 24g	615 990 1490
	7	Grease for bevel gear (1kg)	615 990 1480
<b>CP9120/21/22.. CP7540/45/50..</b>	2	Vibration damping side handle	615 576 0780



## DIAMOND CUTTING KIT

MODEL	ITEM	DESCRIPTION	PART NO.
<b>CP3550-AA45/5</b>		Diamond disc 5" (127mm)	615 804 9150
<b>CP3550-AB45/5</b>		Complete kit	615 397 8300
		Manifold with screws ø125 (5")	615 504 2170
	1	Gable cover plate complete 125 mm	615 504 2180
	2	Spacer 25 mm (5/8")	615 643 0900
	3	Spacer 25 mm (M14)	615 643 0890
	4	Spacer 6 mm (5/8")	616 643 0910
	4	Spacer 6 mm (M14)	616 643 0920
	5	Flange nut 5/8"	617 606 0450
	5	Flange nut M14	617 606 0460
	-	Pin key	617 802 0670



## TUNE-UP KITS

MODEL	TUNE-UP KIT
<b>CP3040</b>	205 054 5223
<b>CP3109-13A4</b>	205 054 1673
<b>CP3109-13A4ES</b>	205 054 1663
<b>CP3330</b>	615 399 4120
<b>CP3340</b>	615 399 4120
<b>CP3450-..</b>	615 397 3030
<b>CP3550-....</b>	615 399 2280
<b>CP3650 Series</b>	205 055 6003
<b>CP3850 Motor Service Kit</b>	205 055 3543
<b>CP3850 Spindle Service Kit</b>	205 055 3553
<b>CP3850 Global Service Kit</b>	205 055 3433
<b>CP75.. serie</b>	894 017 3442
<b>CP854</b>	C138089
<b>CP9120CR</b>	205 050 4823
<b>CP9121AR</b>	205 050 4823
<b>CP9121BR</b>	205 050 4823
<b>CP9121CR</b>	205 050 4823
<b>CP9122BR</b>	205 050 4823
<b>CP9122CR</b>	205 050 4823
<b>CP9123</b>	205 050 3733



# GRINDING

## Dimensions - Accessories Angle Grinders



### OPTIONAL ACCESSORIES



MODEL	ITEM	DESCRIPTION	PART NO.
CP3850-77ABVE	1	Nut	615 542 1040
CP3850-85ABVE	2	Autobalancer	615 503 1460
	3	Safety screw	615 614 0340
	4	Grease gun	615 990 1490
	5	Grease for bevel gear (1kg)	615 990 1480
	.	Pin spanner 1-3/8" (35 mm)	615 802 0100
	.	Flat spanner	615 801 0770
	.	Hexagon wrench 6 mm	615 802 0560

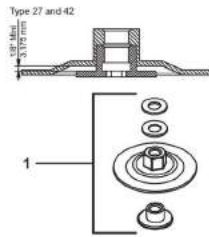

MODEL	ITEM	DESCRIPTION	PART NO.
CP3850-77AB7V CP3850-85AB7V CP3850-60AB9V	1	Wheel adapter	C087920

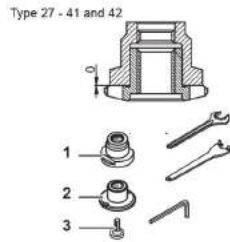

MODEL	ITEM	DESCRIPTION	PART NO.
CP3850-77AB7V	1	Rear Flange	615 503 1030
CP3850-85AB7V	2	Nut	615 542 1040
CP3850-60AB9V	3	Safety screw	615 614 0340
	.	Pin Spanner 1-3/8" (35 mm)	615 802 0100
	.	Flat spanner	615 801 0770
	.	Hexagon wrench 6 mm	615 802 0560

### DIMENSIONS

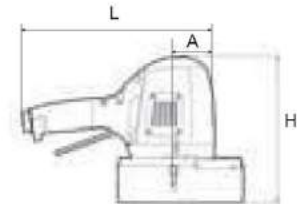
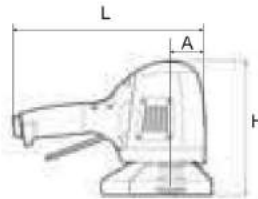
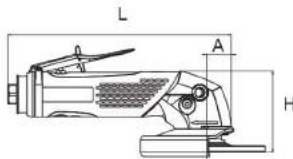

GRINDER	L		A		H	
	in	mm	in	mm	in	mm
CP3019-..A.	6.4	163	0.59	15	2.68	68
CP3109-..A4	8.5	217	0.59	15	2.68	68
CP3109-..A4ES	11.3	287	0.59	15	2.68	68
CP3040GABTIM	8.3	210	2.6	65	3.5	90
CP3040GASTIM	10.6	270	2.6	65	3.5	90
CP3550-120AC4	9.9	252	1.1	29	3.7	94
CP3550-120AA45	9.9	252	1.1	29	3.9	99
CP3550-120AB45	9.9	252	1.1	29	3.9	99
CP3550-120AA5	9.9	252	1.1	29	3.9	99
CP3550-120AB5	9.9	252	1.1	29	3.9	99
CP7500D	5.5	140	1.04	26.4	2.52	64
CP75.. Serie	10.6	270	3.6	93	1.4	36
CP854	9	229	1.02	26	1.58	40
CP854E	9	229	1.02	26	1.58	40
CP9120CR	9.3	233	1.02	26	1.58	40
CP9120CRN	9.3	233	1.02	26	1.58	40
CP9121AR	9.6	240	1.02	26	1.58	40
CP9121BR	9.6	240	1.02	26	1.58	40
CP9121CR	9.6	240	1.02	26	1.58	40
CP9122BR	9.3	233	1.02	26	1.58	40
CP9122CR	9.3	233	1.02	26	1.58	40

GRINDER	L		A		H	
	in	mm	in	mm	in	mm
CP3330-SALAVET	9.8	250	2	50	7.8	200
CP3330-SALAVAD	9.8	250	2	50	7.8	200
CP3330-SALAVEL	9.8	250	2	50	7.8	200
CP3340-SALAVET	9.8	250	2	50	8.6	220
CP3340-SALAVAD	9.8	250	2	50	8.6	220
CP3340-SALAVEL	9.8	250	2	50	8.6	220
CP3349-SALAVADE	10.2	274	1.9	49	7.4	189
CP3349-SALAVEL	10.8	274	1.9	49	8.2	208
CP3349-SALAVELE	10.8	274	1.9	49	7.4	189
CP3349-SALAVET	10.8	274	1.9	49	8.1	207
CP3450-12A..	7.9	200	1.1	27	3.5	88
CP3650-..AC4	9.4	238	1.05	26.8	3.5	88
CP3650-..AB/AA..45/5	9.4	238	1.05	26.8	3.4	87
CP3650-..AB/AA..VK	9.4	238	1.05	26.8	3.6	93
CP3650-..AB6..	9.4	238	1.05	26.8	3.7	93
CP3850-77AB7V	13.1	334	1.14	29	4.8	122
CP3850-..AB9V	13.1	334	1.14	29	4.8	122
CP3850-..AB7VE/AH7VE	13.1	334	1.14	29	4.2	107
CP3850-..AB9VE/AH9VE	13.1	334	1.14	29	4.2	107
CP857	13.1	334	1.34	34	5.5	140
CP9123	13.4	340	1.34	34	5.5	140

