

FINISHING **AS**



▶ **PISTOL GRIP SANDERS**



▶ **BELT SANDERS**



▶ **ORBITAL SANDERS**



▶ **JITTERBUG SANDERS**



▶ **ANGLE SANDERS**



HOW TO SELECT YOUR FINISHING TOOL?

STEP 1

Applications

- ▶ Material type
- ▶ Treatment type
- ▶ Finishing type
- ▶ Intensity

STEP 2

Abrasives

- ▶ Shape
- ▶ Grit size
- ▶ Process
- ▶ Rotation type
- ▶ Access

STEP 3

Tools

- ▶ Handling shape
- ▶ Pad / Belt size
- ▶ Speed

SANDING TOOLS

| | ANGLE SANDERS | PISTOL SANDER | BELT SANDER | ORBITAL SANDER | IN-LINE SANDER | JITTERBUG SANDER |
|---|-------------------------------------|---------------|--------------------------|-------------------------------------|----------------|--|
| <p>SUPER INDUSTRIAL</p> | <p>CP3019 CP3650 CP3850</p> | <p>CP3070</p> | | <p>CP7220 CP7250 CP9534</p> | | |
| <p>INDUSTRIAL MAINTENANCE AND PRODUCTION</p> | <p>CP3030 CP3550</p> | <p>CP9778</p> | <p>CP858 CP5080</p> | <p>CP7215 CP7225 CP7255</p> | | |
| <p>GENERAL MAINTENANCE</p> | | <p>CP7202</p> | <p>CP9779 CP9780</p> | <p>CP3510 CP3512 CP3514</p> | <p>CP7268</p> | <p>CP7263 CP7264 CP7266 CP7267</p> |

FINISHING

<0.7 hp (500 W) Angle Sanders 2" & 3"

The CP3030 Series Benefits

LIGHTWEIGHT & ERGONOMIC

- Industrial angle sander
- Ergonomic handle and high speed
- High durability thanks to simple and robust design

CP3030-325AFR

FEATURES

- Gearless durable construction
- Compact composite handle
- Streamlined safety lever



CP3030-325AFR

CP3030-415AFR



FEATURES

- Gearless durable construction
- Compact composite handle
- Streamlined safety lever

CP3030-420AFR

Same features as CP3030-415AFR with 20,000 rpm.

CP3030-515AFR



FEATURES

- Gearless durable construction
- Compact composite handle
- Streamlined safety lever



CP3030



See accessories on pages 139-146

 GENERAL MAINTENANCE  INDUSTRIAL MAINTENANCE & PRODUCTION  SUPER INDUSTRIAL

| MODEL | PART NUMBER | FREE SPEED | | POWER | | PAD CAPACITY | | PAPER SIZE | | SPINDLE THREAD | AIR CONS. AT FREE SPEED | | AIR CONS. @LOAD | | NET WEIGHT | | LENGTH | | VIBRATION LEVEL ISO 28927 (M/S2) | | SOUND PRESS. ISO 15744 - dB(a) | SOUND POWER | AIR INLET |
|---------------|--------------|------------|------|-------|-----|--------------|-----|------------|--------|----------------|-------------------------|------|-----------------|-----|------------|-----|--------|------|----------------------------------|----|--------------------------------|-------------|-----------|
| | | rpm | hp | W | in. | mm | in. | mm | in. | | mm | in. | mm | in. | mm | in. | mm | a | k | | | | |
| CP3030-325AFR | 615 162 0060 | 25,000 | 0.4 | 300 | 2 | 50 | 2 | 50 | 1/4-20 | 21.8 | 10.3 | 14.2 | 6.7 | 1.9 | 0.8 | 6.1 | 154 | <2,5 | - | 80 | 91 | 1/4 | |
| CP3030-415AFR | 615 162 0070 | 15,000 | 0.54 | 400 | 3 | 75 | 3 | 75 | 3/8-24 | 21.8 | 10.3 | 16.3 | 7.7 | 1.1 | 0.5 | 6.8 | 174 | <2,5 | - | 80 | 91 | 1/4 | |
| CP3030-420AFR | 615 162 0080 | 20,000 | 0.54 | 400 | 3 | 75 | 3 | 75 | 3/8-24 | 27.1 | 12.8 | 18.4 | 8.7 | 1.9 | 0.8 | 6.8 | 174 | <2,5 | - | 76 | 87 | 1/4 | |
| CP3030-515AFR | 615 162 0100 | 15,000 | 0.7 | 500 | 3 | 75 | 3 | 75 | 3/8-24 | 25 | 11.8 | 20.6 | 9.7 | 1.9 | 0.9 | 6.8 | 174 | <2,5 | - | 76 | 87 | 1/4 | |

All models: Hose int. 3/8" (10mm) - @90 PSI (@6.3 Bar)

Listed specifications are for reference only. Please check documents in each model.



0.2 & 0.5 hp (150 & 375 W) Angle Sanders 3"

CP7202 ★



ROTARY SANDING

FEATURES

- Mini pistol disc sander with 3" (75 mm) Roloc pad
- Rubber molded pistol grip
- Adjustable power regulator

BENEFITS

- General maintenance pistol sander
- Compact & lightweight
- Maximized operator control and improved ergonomics lowers fatigue



CP7202

CP3019-12AF ★★★

HIGH PERFORMANCE IN A COMPACT PACKAGE

FEATURES

- Highly durable bevel gear
- Compact body
- Insulating composite over housing

BENEFITS

- Industrial angle sander
- Ergonomic handle and high speed
- Highest durability in demanding applications up to 2,000 hours maintenance intervals



CP3019-12AF

CP3019-20AF

Same features as CP3019-12AF with 20,000 rpm



See accessories on pages 139-146

★ GENERAL MAINTENANCE ★★ INDUSTRIAL MAINTENANCE & PRODUCTION ★★★ SUPER INDUSTRIAL

| MODEL | PART NUMBER | FREE SPEED | | POWER | | PAD CAPACITY | | PAPER SIZE | | SPINDLE THREAD | AIR CONS. AT FREE SPEED | | AIR CONS. @LOAD | | NET WEIGHT | | LENGTH | | VIBRATION LEVEL ISO 28927 (M/S ²) | | SOUND PRESS. | SOUND POWER | AIR INLET |
|--------------------|---------------------|------------|--|-------|-----|--------------|----|------------|----|----------------|-------------------------|-----|-----------------|-----|------------|-----|--------|-----|---|-----|-------------------|-------------|-----------|
| | | rpm | | hp | W | in. | mm | in. | mm | in. | cfm | l/s | cfm | l/s | lb | kg | in. | mm | a | k | ISO 15744 - dB(a) | | in. |
| CP3019-12AF | 615 160 7080 | 12,000 | | 0.5 | 375 | 3 | 75 | 2 | 50 | 1/4-20 UNC | 17.6 | 8.3 | 6.4 | 3 | 0.3 | 0.6 | 6.3 | 166 | < 2.5 | - | 78 | 89 | 1/4 |
| CP3019-20AF | 615 160 7090 | 20,000 | | 0.5 | 375 | 3 | 75 | 2 | 50 | 1/4-20 UNC | 19.7 | 9.3 | 12.1 | 5.7 | 0.3 | 0.6 | 6.3 | 166 | 2.7 | 1.3 | 82 | 93 | 1/4 |
| CP7202 | 894 107 2021 | 15,000 | | 0.2 | 150 | 3 | 75 | 3 | 75 | 1/4-20 UNC | 21 | 9.9 | 21 | 9.9 | 1.5 | 0.7 | 4 | 102 | < 2.5 | - | 84.8 | 95.8 | 1/4 |

All models: Hose int. 3/8" (10mm) - @90 PSI (@6.3 Bar)

Listed specifications are for reference only. Please check documents in each tool.



FINISHING

CP3070-120G

DURABLE



FEATURES

- 5" (125 mm) sander
- High power 0.5hp (375 W)
- Free speed 12,000 rpm

BENEFITS

- Industrial pistol sander
- High durability
- Ergonomics - Compact & easy handling, ideal for limited space applications



CP3070-120G

<0.5 hp (375 W) Pistol Sanders 5"

CP9778



FAST & PRECISE

FEATURES

- Standard-duty hi-speed sander with 5" (125 mm) pad
- Built-in air regulator and variable speed throttle
- Rugged, energy efficient 0.5 hp(375 W) motor

BENEFITS

- General maintenance pistol sander
- Excellent for paint removal, smoothing and rust removal in limited space applications



CP3070-120G



See accessories on pages 139-146

 GENERAL MAINTENANCE  INDUSTRIAL MAINTENANCE & PRODUCTION  SUPER INDUSTRIAL

| MODEL | PART NUMBER | FREE SPEED | | POWER | | PAD CAPACITY | | PAPER SIZE | | SPINDLE THREAD | | AIR CONS. AT FREE SPEED | | AIR CONS. @LOAD | | NET WEIGHT | | LENGTH | | VIBRATION LEVEL ISO 28827 (M/s ²) | | SOUND PRESS. ISO 15744 - dB(a) | SOUND POWER | AIR INLET |
|-------------|--------------|------------|-----|-------|-----|--------------|-----|------------|---------|----------------|-----|-------------------------|------|-----------------|----|------------|-----|--------|---|---|-----|--------------------------------|-------------|-----------|
| | | rpm | hp | W | in. | mm | in. | mm | in. | cfm | l/s | cfm | l/s | lb | kg | in. | mm | a | k | | | | | |
| CP3070-120G | 615 162 0090 | 12,000 | 0.5 | 375 | 5 | 125 | 5 | 125 | 3/8-24 | 26 | 12 | 22 | 10.5 | 2.2 | 1 | 6.9 | 175 | <2,5 | - | 84 | 95 | 1/4 | | |
| CP9778 | 615 193 9778 | 14,000 | 0.5 | 375 | 5 | 125 | 5 | 125 | 7/16-20 | 25 | 12 | 21 | 9.9 | 2.3 | 1 | 10.5 | 297 | <2,5 | - | 90 | 101 | 1/4 | | |

All models: Hose int. 3/8" (10mm) - @90 PSI (@6.3 Bar)

Listed specifications are for reference only. Please check documents in each tool





<0.51 hp (380 W) Belt Sanders

CP9779 ★



FLEXIBLE & EASY HANDLING

FEATURES

- Quick-change belt replacement
- Rubber molded grip
- Adjustable sanding arm

BENEFITS

- Operator comfort
- Excellent for paint removal, weld sanding, smoothing and rust removal in tight areas

CP9780 ★



EASY HANDLING & LARGE REMOVAL

FEATURES

- Quick-change belt replacement
- Rubber molded grip
- Adjustable sanding arm

BENEFITS

- Excellent for paint removal, smoothing and rust removal in limited space applications

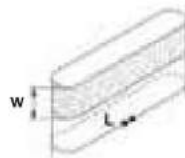

See accessories on pages 139-146

★ GENERAL MAINTENANCE ★★ INDUSTRIAL MAINTENANCE & PRODUCTION ★★★ SUPER INDUSTRIAL

| MODEL | PART NUMBER | FREE SPEED | | POWER | | BELT CAPACITY | | AIR CONS. AT FREE SPEED | | AIR CONS. @LOAD | | NET WEIGHT | | LENGTH | | VIBRATION LEVEL ISO 28827 (M/S ²) | | SOUND PRESS. | SOUND POWER | AIR INLET |
|--------|--------------|------------|--|-------|-----|---------------|--------|-------------------------|------|-----------------|------|------------|-----|--------|-----|---|---|-------------------|-------------|-----------|
| | | rpm | | hp | W | in. | mm | cfm | l/s | cfm | l/s | lb | kg | in. | mm | a | k | ISO 15744 - dB(a) | | in. |
| CP858 | T025179 | 18,000 | | 0.4 | 300 | 3/8x13 | 10x330 | 22 | 10.4 | 22 | 10.4 | 1.9 | 0.9 | 10.8 | 275 | <2.5 | - | 93 | 104 | 1/4 |
| CP9779 | 615 193 9779 | 22,000 | | 0.35 | 260 | 3/8x13 | 10x330 | 13.3 | 6.3 | 28 | 13.1 | 2 | 0.9 | 12 | 304 | <2.5 | - | 91 | 102 | 1/4 |
| CP9780 | 615 193 9780 | 20,000 | | 0.51 | 380 | 3/4x20.4 | 19x520 | 14.6 | 6.9 | 30 | 14.1 | 3.3 | 1.5 | 15 | 380 | <2.5 | - | 91 | 102 | 1/4 |

All models: Hose int. 3/8" (10mm) - @90 PSI (@6.3 Bar)

Listed specifications are for reference only. Please check documents in each tool.



CP858 ★★

PRODUCTIVITY & DURABILITY

FEATURES

- Belt sander 3/8" (10 mm) capacity
- Quick change belt replacement
- Adjustable sanding arm

BENEFITS

- Excellent for paint removal, smoothing and rust removal in limited space applications



CP858



CP858

FINISHING

0.4 & 0.54 hp (300 & 400 W) Belt Sanders

The CP5080 Series Benefits

HIGH PRODUCTIVITY BELT SANDER

- Industrial belt sander
- Ergonomic handle and high speed
- High durability thanks to simple and robust design

CP5080-3260D12 ★★

COMPACT SIZE BELT SANDER

FEATURES

- Designed for precise applications
- Sanding head pivots 360° for multi position sanding
- Easy change of abrasives and contact arm



CP5080-3260D12

CP5080-3260D12K

Part No. 615 162 0050

Kit includes:

- 205 054 5513 Guard support 12" belts
- 205 054 5583 Handle CP5080-3260D12
- 205 054 5573 Belt sanding set 12" 5pc CP
- 205 054 5523 Contact arm 1/2"x12" - 5/8" diam.
- 205 054 5543 Contact arm 1/8"x12"
- 205 054 5533 Contact arm 1/2"x12" 5/16" diam
- 205 055 2173 Blowcase CP5080
- 205 055 2183 Sticker blowcase 12" CP5080

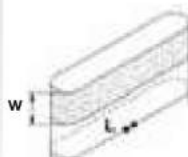

CP5080-4200D24 ★★



UNIVERSAL AND VERSATILE BELT SANDER

FEATURES

- Universal and versatile arm design
- Sanding head pivots 360° for multi position sanding
- Easy change of abrasives and contact arm

CP5080-3260H19 ★★



SPECIAL DIMENSION COMPACT BELT SANDER

FEATURES

- Designed for precise applications
- Sanding head pivots 360° for multi position sanding
- Easy change of abrasives and contact arm

★ GENERAL MAINTENANCE ★★ INDUSTRIAL MAINTENANCE & PRODUCTION ★★★ SUPER INDUSTRIAL

| MODEL | PART NUMBER | FREE SPEED | | POWER | | BELT CAPACITY | | AIR CONS. AT FREE SPEED | | AIR CONS. @LOAD | | NET WEIGHT | | LENGTH | | VIBRATION LEVEL ISO 28927 (M/SZ) | | SOUND PRESS. ISO 15744 - dB(a) | SOUND POWER | AIR INLET |
|-----------------|--------------|------------|--|-------|-----|---------------|-----------|-------------------------|------|-----------------|------|------------|-----|--------|-----|----------------------------------|---|--------------------------------|-------------|-----------|
| | | rpm | | hp | W | in. | mm | cfm | l/s | cfm | l/s | lb | kg | in. | mm | a | k | | | |
| CP5080-3260D12 | 615 162 0000 | 26,000 | | 0.4 | 300 | 1/2x12 | 13x305 | 21.8 | 10.3 | 17.8 | 8.4 | 1.7 | 0.8 | 11.4 | 280 | <2,5 | - | 82 | 93 | 1/4 |
| CP5080-3260D12K | 615 162 0050 | 26,000 | | 0.4 | 300 | 1/8-1/2x12 | 3-13x305 | 21.8 | 10.3 | 17.8 | 8.4 | 1.7 | 0.8 | 11.4 | 280 | <2,5 | - | 82 | 93 | 1/4 |
| CP5080-3260H19 | 615 162 0200 | 26,000 | | 0.4 | 300 | 1/2-1x19 | 13-25x480 | 21.8 | 10.3 | 17.8 | 8.4 | 2.5 | 1.1 | 14.6 | 370 | <2,5 | - | 79 | 90 | 1/4 |
| CP5080-4200D24 | 615 162 0010 | 20,000 | | 0.54 | 400 | 1/2x24 | 13x610 | 25.6 | 12.1 | 21.6 | 10.2 | 3.1 | 1.4 | 15.3 | 390 | <2,5 | - | 78 | 89 | 1/4 |

All models: Hose int. 3/8" (10mm) - @90 PSI (@6.3 Bar)

Listed specifications are for reference only. Please check documents in each tool.

0.54 & 0.75 hp (400 & 560 W) Belt Sanders

CP5080-4200H18 ★★



HIGH PRODUCTIVITY BELT SANDER

FEATURES

- Designed for work in tight spots
- Sanding head pivots 360° for multi position sanding
- Easy change of abrasives and contact arm

CP5080-4200H18K

Part No. 615 162 0040

Kit includes:

- 205 054 7953 Guard support 18" w/ handle
- 205 054 5603 Handle CP5080-4200h18
- 205 054 5563 Belt sanding set 18" 8pc CP
- 205 054 5483 Contact arm 1/2"x18"
- 205 054 5453 Contact arm 5/8" to 3/4"x 18"
- 205 054 5473 Contact arm 1/8" to 1/2"x 18"
- 20 5055 2173 Blowcase CP5080



CP5080-5220H18

CP5080-5220H18 ★★

LARGE SURFACE BELT SANDER

FEATURES

- Designed for large surfaces applications
- Sanding head pivots 360° for multi position sanding
- Easy change of abrasives and contact arm



CP5080-5220H18



See accessories on pages 139-146

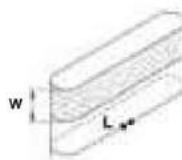

★ GENERAL MAINTENANCE ★★ INDUSTRIAL MAINTENANCE & PRODUCTION ★★★ SUPER INDUSTRIAL

| MODEL | PART NUMBER | FREE SPEED | POWER | | BELT CAPACITY | | AIR CONS. AT FREE SPEED | | AIR CONS. @LOAD | | NET WEIGHT | | LENGTH | | VIBRATION LEVEL ISO 23927 (M/G2) | | SOUND PRESS. | SOUND POWER | AIR INLET |
|-----------------|--------------|------------|-------|-----|---------------|-----------|-------------------------|------|-----------------|------|------------|-----|--------|-----|----------------------------------|---|-------------------|-------------|-----------|
| | | rpm | hp | W | in. | mm | cfm | l/s | cfm | l/s | lb | kg | in. | mm | a | k | ISO 15744 - dB(a) | | in. |
| CP5080-4200H18 | 615 162 0020 | 20,000 | 0.54 | 400 | 1/2x18 | 13x457 | 25.6 | 12.1 | 21.6 | 10.3 | 2.8 | 1.3 | 13.4 | 340 | <2,5 | - | 80 | 91 | 1/4 |
| CP5080-4200H18K | 615 162 0040 | 20,000 | 0.54 | 400 | 1/2-3/4x18 | 13-19x457 | 25.6 | 12.1 | 21.6 | 10.2 | 3.1 | 1.4 | 13.4 | 340 | <2,5 | - | 78 | 89 | 1/4 |
| CP5080-5220H18 | 615 162 0030 | 22,000 | 0.75 | 560 | 1x18 | 25x457 | 31.8 | 15 | 27.1 | 12.8 | 3.3 | 1.5 | 13.4 | 340 | <2,5 | - | 84 | 95 | 1/4 |

All models: Hose int. 3/8" (10mm) - @90 PSI (@6.3 Bar)

Listed specifications are for reference only. Please check documents in each tool



FINISHING

CP3514 ★

ERGONOMIC & POWERFUL

FEATURES

- Central Vacuum (CV) model in Hook & Loop Pad
- 5" (125 mm) random orbital palm sander
- Powerful 0.3 hp (210 W) motor

BENEFITS

- Operator comfort with ergonomic palm shape
- Productivity increased with low vibrations level
- Powerful and ergonomic palm shape for vertical and horizontal applications



0.3 HP (210 W) Orbital Sanders

CP3510 ★



ERGONOMIC & POWERFUL

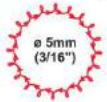

CP3511

Same features as CP3510 with PSA

FEATURES

- Non Vacuum (NV) model in Hook & Loop Pad
- 5" (125 mm) random orbital palm sander
- Powerful 0.3 hp (210 W) motor

BENEFITS

- Operator comfort with ergonomic palm shape
- Productivity increased with low vibration level
- Powerful and ergonomic palm shape for vertical and horizontal applications

CP3512 ★



ERGONOMIC & POWERFUL



FEATURES

- Self Vacuum (SV) model in Hook & Loop Pad
- 5" (125 mm) random orbital palm sander
- Powerful 0.3 hp (210 W) motor

BENEFITS

- Operator comfort with ergonomic palm shape
- Productivity increased with low vibration level
- Powerful and ergonomic palm shape for vertical and horizontal applications



See accessories on pages 139-146

★ GENERAL MAINTENANCE ★★ INDUSTRIAL MAINTENANCE & PRODUCTION ★★★ SUPER INDUSTRIAL

| MODEL | PART NUMBER | POWER | | GRIP | FREE SPEED | PAD CAPACITY | | SPINDLE THREAD | AIR CONS. AT FREE SPEED | | AIR CONS. @LOAD | | NET WEIGHT | | PAD TYPE | VAC | VIBRATION LEVEL ISO 28927 (M/S ²) | | SOUND PRESS. | SOUND POWER | AIR INLET |
|--------|--------------|-------|-----|------|------------|--------------|-----|----------------|-------------------------|-----|-----------------|-----|------------|-----|----------|-----|---|-----|--------------|-------------|-----------|
| | | hp | W | | | in. | mm | | cfm | l/s | cfm | l/s | lb | kg | | | a | k | | | |
| CP3510 | 615 193 3510 | 0.3 | 210 | Palm | 12,000 | 5 | 125 | 5/16-24 | 19.5 | 9.2 | 16 | 7.6 | 1.3 | 0.7 | H&L | no | 3 | 1.3 | 81 | 89 | 1/4 |
| CP3511 | 615 193 3511 | 0.3 | 210 | Palm | 12,000 | 5 | 125 | 5/16-24 | 19.5 | 9.2 | 16 | 7.6 | 1.3 | 0.7 | PSA | no | 3 | 1.3 | 81 | 93 | 1/4 |
| CP3512 | 615 193 3512 | 0.3 | 210 | Palm | 12,000 | 5 | 125 | 5/16-24 | 19.5 | 9.2 | 16 | 7.6 | 1.4 | 0.8 | H&L | SV | 3 | 1.3 | 81 | 91 | 1/4 |
| CP3514 | 615 193 3514 | 0.3 | 210 | Palm | 12,000 | 5 | 125 | 5/16-24 | 19.5 | 9.2 | 16 | 7.6 | 1.4 | 0.8 | H&L | CV | 3 | 1.3 | 81 | 87 | 1/4 |

All models: Hose int. 3/8" (10mm) - @90 PSI (@6.3 Bar)

Listed specifications are for reference only. Please check documents in each tool.



0.3 HP (210 W) Orbital Sanders

CP7225 ★★



POWERFUL & COMFORTABLE



CP7225E / CV

Same features as CP7225 with respectively H&L and Central Vacuum

CP7225CVE / SVE

Same features as CP7225 with H&L, Central Vacuum and with H&L, Self Vacuum

FEATURES

- Non Vacuum (NV) model in PSA pad
- 6" (150 mm) random orbital with palm sander
- Powerful 0.3 hp (210 W) motor

BENEFITS

- Productivity increased with low vibrations level
- Powerful and ergonomic palm shape for vertical and horizontal applications
- 3/32" (2.5 mm): used for final sanding, finishing, and pre-polishing processes

CP7215SV ★★



CP7215/E

Same features as CP7215SV with H&L

CP7215CV

Same features as CP7215SV with H&L and Central Vacuum

CP7215CVE/SVE

Same features as CP7215SV with H&L, Central Vacuum and with H&L, Self Vacuum

POWERFUL & COMFORTABLE

FEATURES

- Self Vacuum (SV) model in PSA pad
- 6" (150 mm) random orbital palm sander
- Powerful 0.3 hp (210 W) motor

BENEFITS

- Operator comfort with ergonomic palm shape
- Productivity increased with low vibration level
- Powerful and ergonomic palm shape for vertical and horizontal applications

CP7255CVE ★★

POWERFUL & COMFORTABLE

FEATURES

- Central Vacuum (CV) model in Hook & Loop Pad
- 6" (150 mm) random orbital palm sander
- Powerful 0.3 hp (210 W) motor



BENEFITS

- Operator comfort with ergonomic palm shape
- Productivity increased with low vibrations level
- Powerful and ergonomic palm shape for vertical and horizontal applications



CP7255

Same features as CP7255CVE with PSA

CP7255E / CV

Same features as CP7255CVE with respectively H&L and Central Vacuum

CP7255SV / SVE

Same features as CP7255CVE with respectively Self Vacuum and H&L Self Vacuum

★ GENERAL MAINTENANCE ★★ INDUSTRIAL MAINTENANCE & PRODUCTION ★★★ SUPER INDUSTRIAL

| | MODEL | PART NUMBER | POWER | | GRIP | FREE SPEED | PAD CAPACITY | | SPINDLE THREAD | AIR CONS. AT FREE SPEED | | AIR CONS. @LOAD | | NET WEIGHT | | PAD TYPE | VAC | VIBRATION LEVEL ISO 28927 (M/S ²) | | SOUND PRESS. | SOUND POWER | AIR INLET |
|-----------------------------|-----------|--------------|-------|-----|------|------------|--------------|-----|----------------|-------------------------|-----|-----------------|-----|------------|-----|----------|-----|---|-----|--------------|-------------|-----------|
| | | | hp | W | | | in. | mm | | in. | cfm | l/s | cfm | l/s | lb | | | kg | a | | | |
| ORBITAL Ø 3 1/8" (10 mm) | CP7215 | 894 107 2151 | 0.3 | 210 | Palm | 12,000 | 6 | 150 | 5/16-24 | 18 | 8 | 16 | 7.6 | 1.7 | 0.8 | PSA | no | 8.54 | 2.9 | 81 | 92 | 1/4 |
| | CP7215CV | 894 107 2153 | 0.3 | 210 | Palm | 12,000 | 6 | 150 | 5/16-24 | 18 | 8 | 16 | 7.6 | 1.8 | 0.8 | PSA | CV | 8.54 | 2.9 | 81 | 92 | 1/4 |
| | CP7215CVE | 894 127 2153 | 0.3 | 210 | Palm | 12,000 | 6 | 150 | 5/16-24 | 18 | 8 | 16 | 7.6 | 1.8 | 0.8 | H&L | CV | 5.65 | 1.8 | 81 | 92 | 1/4 |
| | CP7215E | 894 127 2151 | 0.3 | 210 | Palm | 12,000 | 6 | 150 | 5/16-24 | 18 | 8 | 16 | 7.6 | 1.7 | 0.8 | H&L | no | 5.65 | 1.8 | 81 | 92 | 1/4 |
| | CP7215SV | 894 107 2152 | 0.3 | 210 | Palm | 12,000 | 6 | 150 | 5/16-24 | 18 | 8 | 16 | 7.6 | 1.8 | 0.8 | PSA | SV | 8.54 | 2.9 | 81 | 92 | 1/4 |
| ORBITAL Ø 3/32" (2.5 mm) | CP7215SVE | 894 127 2152 | 0.3 | 210 | Palm | 12,000 | 6 | 150 | 5/16-24 | 18 | 8 | 16 | 7.6 | 1.8 | 0.8 | H&L | SV | 5.65 | 1.8 | 81 | 92 | 1/4 |
| | CP7225 | 894 107 2251 | 0.3 | 210 | Palm | 12,000 | 6 | 150 | 5/16-24 | 18 | 8 | 16 | 7.6 | 1.7 | 0.8 | PSA | no | 7.65 | 3.2 | 81 | 92 | 1/4 |
| | CP7225CV | 894 107 2253 | 0.3 | 210 | Palm | 12,000 | 6 | 150 | 5/16-24 | 18 | 8 | 16 | 7.6 | 1.8 | 0.8 | PSA | CV | 7.65 | 3.2 | 81 | 92 | 1/4 |
| | CP7225CVE | 894 127 2253 | 0.3 | 210 | Palm | 12,000 | 6 | 150 | 5/16-24 | 18 | 8 | 16 | 7.6 | 1.8 | 0.8 | H&L | CV | 3.7 | 2.1 | 81 | 92 | 1/4 |
| | CP7225E | 894 127 2251 | 0.3 | 210 | Palm | 12,000 | 6 | 150 | 5/16-24 | 18 | 8 | 16 | 7.6 | 1.7 | 0.8 | H&L | no | 3.7 | 2.1 | 81 | 92 | 1/4 |
| ORBITAL Ø 1/4" (6 mm) | CP7225SVE | 894 127 2252 | 0.3 | 210 | Palm | 12,000 | 6 | 150 | 5/16-24 | 18 | 8 | 16 | 7.6 | 1.8 | 0.8 | H&L | SV | 3.7 | 2.1 | 81 | 92 | 1/4 |
| | CP7255 | 894 107 2551 | 0.3 | 210 | Palm | 12,000 | 6 | 150 | 5/16-24 | 18 | 8 | 16 | 7.6 | 1.7 | 0.8 | PSA | no | 8.22 | 2.3 | 81 | 92 | 1/4 |
| | CP7255CV | 894 107 2553 | 0.3 | 210 | Palm | 12,000 | 6 | 150 | 5/16-24 | 18 | 8 | 16 | 7.6 | 83 | 0.8 | PSA | CV | 8.22 | 2.3 | 81 | 92 | 1/4 |
| | CP7255CVE | 894 127 2553 | 0.3 | 210 | Palm | 12,000 | 6 | 150 | 5/16-24 | 18 | 8 | 16 | 7.6 | 83 | 0.8 | H&L | CV | 5.13 | 1.8 | 81 | 92 | 1/4 |
| | CP7255E | 894 127 2551 | 0.3 | 210 | Palm | 12,000 | 6 | 150 | 5/16-24 | 18 | 8 | 16 | 7.6 | 1.7 | 0.8 | H&L | no | 5.13 | 1.8 | 81 | 92 | 1/4 |
| | CP7255SV | 894 107 2552 | 0.3 | 210 | Palm | 12,000 | 6 | 150 | 5/16-24 | 18 | 8 | 16 | 7.6 | 1.8 | 0.8 | PSA | SV | 8.22 | 2.3 | 81 | 92 | 1/4 |
| | CP7255SVE | 894 127 2552 | 0.3 | 210 | Palm | 12,000 | 6 | 150 | 5/16-24 | 18 | 8 | 16 | 7.6 | 1.8 | 0.8 | H&L | SV | 5.13 | 1.8 | 81 | 92 | 1/4 |

All models: Hose int. 3/8" (10mm) - @90 PSI (@6.3 Bar)

Listed specifications are for reference only. Please check documents in each tool.



FINISHING

0.3 hp (210 W) Orbital Sanders

CP7215H ★★



CP7215HE / HCVE

Same features as CP7215H with handle and H&L / with 2 hands and Central Vacuum



Eco change motor, see page 133

LIGHTWEIGHT & POWERFUL

FEATURES

- Non Vacuum (NV) model in PSA Pad
- 2-handed 6" (150 mm) random orbital palm sander
- Powerful 0.3 hp (210 W) motor

BENEFITS

- Operator comfort with ergonomic palm shape
- Productivity increased with low vibration level
- Powerful and ergonomic palm shape for vertical and horizontal applications

CP7255H ★★

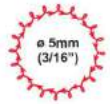

CP7255HE / HCVE

Same features as CP7255H with handle and H&L / with 2 hands and Central Vacuum



Eco change motor, see page 133

LIGHTWEIGHT & POWERFUL

FEATURES

- Non Vacuum (NV) model in PSA Pad
- 2-handed 6" (150 mm) random orbital palm sander
- Powerful 0.3 hp (210 W) motor

BENEFITS

- Operator comfort with ergonomic palm shape
- Productivity increased with low vibration level
- Powerful and easy to use for vertical and horizontal applications

CP7268 ★



IN-LINE SANDING

FEATURES

- Heavy-duty dual piston straight line sander
- Twin piston rugged design
- Easy comfort trigger and handle

BENEFITS

- Operator comfort and safe operation
- Ideal tool for fast material removal, body smoothing, and for large surfaces



See accessories on pages 139-146

★ GENERAL MAINTENANCE ★★ INDUSTRIAL MAINTENANCE & PRODUCTION ★★★ SUPER INDUSTRIAL

| | MODEL | PART NUMBER | POWER | | GRIP | FREE SPEED | PAD CAPACITY | | PAPER SIZE | | SPINDLE THREAD | AIR CONS. AT FREE SPEED | | AIR CONS. @LOAD | | NET WEIGHT | | PAD TYPE | VIBRATION LEVEL ISO 28927 (M/S ²) | | SOUND PRESS. | SOUND POWER | AIR INLET |
|------------------------------|------------|--------------|-------|-----|------|------------|--------------|--------|------------|--------|----------------|-------------------------|-----|-----------------|-----|------------|-----|----------|---|------|--------------|-------------|-----------|
| | | | hp | W | | | in. | mm | in. | mm | | in. | cfm | l/s | cfm | l/s | lb | | kg | a | | | |
| | CP7268 | 894 107 2680 | - | - | Palm | 5,000 | 2.75x17.5 | 70x445 | 2.75x17.5 | 70x445 | - | 14 | 6.6 | 10.7 | 5.1 | 6.1 | 2.8 | - | 22.03 | 13.5 | 93 | 104 | 1/4 |
| ORBITAL ø 3/16" (5 mm) | CP7255HE | 894 127 2554 | 0.3 | 210 | Palm | 11,000 | 6 | 150 | 150 | 6 | 5/16-24 | 18 | 8 | 18 | 8.5 | 1.9 | 0.9 | H&L | 3.1 | 5.2 | 82 | 93 | 1/4 |
| | CP7255HCVE | 894 127 2555 | 0.3 | 210 | Palm | 11,000 | 6 | 150 | 150 | 6 | 5/16-24 | 18 | 8 | 18 | 8.5 | 1.9 | 0.9 | H&L | 3.1 | 5.2 | 83 | 94 | 1/4 |
| ORBITAL ø 3/8" (10 mm) | CP7255H | 894 107 2554 | 0.3 | 210 | Palm | 11,000 | 6 | 150 | 150 | 6 | 5/16-24 | 18 | 8 | 18 | 8.5 | 1.9 | 0.9 | H&L | 5.4 | 2.4 | 81 | 92 | 1/4 |
| | CP7215HE | 894 127 2154 | 0.3 | 210 | Palm | 11,000 | 6 | 150 | 150 | 6 | 5/16-24 | 18 | 8 | 18 | 8.5 | 2 | 0.9 | H&L | 4.4 | 2.8 | 85 | 96 | 1/4 |
| | CP7215HCVE | 894 127 2155 | 0.3 | 210 | Palm | 11,000 | 6 | 150 | 150 | 6 | 5/16-24 | 18 | 8 | 18 | 8.5 | 2 | 0.9 | H&L | 4.4 | 2.8 | 86 | 97 | 1/4 |
| | CP7215H | 894 107 2154 | 0.3 | 210 | Palm | 11,000 | 6 | 150 | 150 | 6 | 5/16-24 | 18 | 8 | 18 | 8.5 | 2 | 0.9 | PSA | 4.4 | 2.8 | 84 | 95 | 1/4 |

All models: Hose int. 3/8" (10mm) - @90 PSI (@6.3 Bar)

Listed specifications are for reference only. Please check documents in each tool.



0.3 hp (210 W) Orbital Sanders

CP7220E



HIGH PERFORMANCE WITH LOW NOISE NON VACUUM



CP7220SVE

Same features as CP7220E with self-vacuum

CP7250E

Same features as CP7220E with 3/16" (5 mm) orbit

CP7250SVE

Same features as CP7220SVE with 3/16" (5 mm) orbit and self vacuum



FEATURES

- Non-vacuum model available with PSA and Hook & Loop pads
- True oil-free operation to keep contaminants away from your sanding process
- Used for final sanding, finishing and prepolishing processes

BENEFITS

- Industrial orbital sander
- High durability thanks to simple and robust design
- Ideal for versatile sanding applications

CP7220HCVE



HIGH PERFORMANCE WITH LOW NOISE CENTRAL VACUUM



FEATURES

- Central-vacuum model available in PSA and Hook & Loop pads
- True oil-free operation to keep contaminants away from your sanding process
- Used for final sanding, finishing and prepolishing processes

BENEFITS

- Industrial orbital sander
- High durability thanks to simple and robust design
- Ideal for versatile sanding applications

CP7220CVE

HIGH PERFORMANCE WITH LOW NOISE CENTRAL VACUUM



FEATURES

- Central-vacuum model available in PSA and Hook & Loop pads
- True oil-free operation to keep contaminants away from your sanding process
- Used for final sanding, finishing and prepolishing processes

BENEFITS

- Industrial orbital sander
- High durability thanks to simple and robust design
- Ideal for versatile sanding application



CP7250CVE

Same features as CP7220CVE with 3/16" (5 mm) orbit

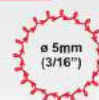

See accessories on pages 139-146

 GENERAL MAINTENANCE  INDUSTRIAL MAINTENANCE & PRODUCTION  SUPER INDUSTRIAL

| MODEL | PART NUMBER | POWER | | GRIP | FREE SPEED | PAD CAPACITY | | SPINDLE THREAD | AIR CONS. AT FREE SPEED | | AIR CONS. @LOAD | | NET WEIGHT | | PAD TYPE | VAC | VIBRATION LEVEL ISO 28927 (M/S ²) | | SOUND PRESS. | SOUND POWER | AIR INLET |
|-------------------------------------|--------------|-------|-----|------|------------|--------------|-----|----------------|-------------------------|-----|-----------------|-----|------------|-----|----------|-----|---|-----|--------------|-------------|-----------|
| | | hp | W | | | in. | mm | | in. | cfm | l/s | cfm | l/s | lb | | | kg | a | | | |
| PALM GRIP - ORBITAL ø 3/32" (2.5mm) | | | | | | | | | | | | | | | | | | | | | |
| CP7220CVE | 894 127 2203 | 0.3 | 210 | Palm | 12,000 | 6 | 150 | 5/16-24 | 16.6 | 7.8 | 16.6 | 7.8 | 1.7 | 0.8 | H&L | CV | 3.2 | 1.4 | 76 | 87 | 1/4 |
| CP7220E | 894 127 2201 | 0.3 | 210 | Palm | 12,000 | 6 | 150 | 5/16-24 | 16.6 | 7.8 | 16.6 | 7.8 | 1.7 | 0.8 | H&L | no | 3.4 | 1.3 | 76 | 87 | 1/4 |
| CP7220SVE | 894 127 2202 | 0.3 | 210 | Palm | 12,000 | 6 | 150 | 5/16-24 | 16.6 | 7.8 | 16.6 | 7.8 | 1.7 | 0.8 | H&L | SV | 3.2 | 1.4 | 76 | 87 | 1/4 |
| CP7220HCVE | 615 170 3790 | 0.3 | 210 | Palm | 12,000 | 6 | 150 | 5/16-24 | 16.6 | 7.8 | 16.6 | 7.8 | 2 | 0.9 | H&L | CV | 5.1 | 3.2 | 81 | 92 | 1/4 |
| PALM GRIP - ORBITAL ø 3/16" (5mm) | | | | | | | | | | | | | | | | | | | | | |
| CP7250CVE | 894 127 2503 | 0.3 | 210 | Palm | 12,000 | 6 | 150 | 5/16-24 | 16.6 | 7.8 | 16.6 | 7.8 | 1.7 | 0.8 | H&L | CV | 5.7 | 2.9 | 76 | 87 | 1/4 |
| CP7250E | 894 127 2501 | 0.3 | 210 | Palm | 12,000 | 6 | 150 | 5/16-24 | 16.6 | 7.8 | 16.6 | 7.8 | 1.7 | 0.8 | H&L | no | 5 | 2.3 | 76 | 87 | 1/4 |
| CP7250SVE | 894 127 2502 | 0.3 | 210 | Palm | 12,000 | 6 | 150 | 5/16-24 | 16.6 | 7.8 | 16.6 | 7.8 | 1.7 | 0.8 | H&L | SV | 5.7 | 2.9 | 76 | 87 | 1/4 |

All models: Hose int. 3/8" (10mm) - @90 PSI (@6.3 Bar)

Listed specifications are for reference only. Please check documents in each tool.



FINISHING

CP7250HCVE

**HIGH PERFORMANCE
WITH LOW NOISE
CENTRAL VACUUM**



FEATURES

- Central-vacuum model available in PSA and Hook & Loop pads
- 0.3 hp (210 W) orbital sander
- True oil-free operation to keep contaminants away from your sanding process

BENEFITS

- Industrial orbital sander
- High durability thanks to simple and robust design
- Ideal for versatile sanding applications



CP7250HCVE

0.3 hp (210 W) Orbital Sanders

CP7220HE



**HIGH PERFORMANCE
WITH LOW NOISE
NON VACUUM**

FEATURES

- Central-vacuum model available in PSA and Hook & Loop pads
- 0.3 hp (210 W) orbital sander
- True oil-free operation to keep contaminants away from your sanding process

BENEFITS

- Industrial orbital sander
- High durability thanks to simple and robust design
- Ideal for versatile sanding applications

CP9534



**HIGH PERFORMANCE
WITH LOW NOISE
CENTRAL VACUUM**

CP9674

Same features as CP9534 with low noise Central-vacuum



Ø 10mm (3/8")

FEATURES

- Central-vacuum model available in PSA and Hook & Loop pads
- True oil-free operation to keep contaminants away from your sanding process
- 0.3 hp (210 W) orbital sander

BENEFITS

- Industrial orbital sander
- High durability thanks to simple and robust design
- Ideal for versatile sanding applications



See accessories on pages 139-146

 GENERAL MAINTENANCE  INDUSTRIAL MAINTENANCE & PRODUCTION  SUPER INDUSTRIAL

| MODEL | PART NUMBER | POWER | | GRIP | FREE SPEED rpm | PAD CAPACITY | | SPINDLE THREAD | AIR CONS. AT FREE SPEED | | AIR CONS. @LOAD | | NET WEIGHT | | PAD TYPE | VAC | VIBRATION LEVEL ISO 28927 (M/S ²) | | SOUND PRESS. ISO 15744 - dB(A) | SOUND POWER | AIR INLET |
|-------------------------------------|---------------------|-------|-----|------|-------------------|--------------|-----|-------------------|----------------------------|-----|--------------------|-----|------------|-----|----------|-----|--|-----|-----------------------------------|-------------|-----------|
| | | hp | W | | | in. | mm | | in. | cfm | l/s | cfm | l/s | lb | | | kg | a | | | |
| PALM GRIP - ORBITAL Ø 3/32" (2.5mm) | | | | | | | | | | | | | | | | | | | | | |
| CP7220HE | 615 170 3770 | 0.3 | 210 | Palm | 12,000 | 6 | 150 | 5/16-24 | 16.6 | 7.8 | 16.6 | 7.8 | 2 | 0.9 | H&L | SV | 5.1 | 3.2 | 81 | 92 | 1/4 |
| PALM GRIP - ORBITAL Ø 3/16" (5mm) | | | | | | | | | | | | | | | | | | | | | |
| CP7250HCVE | 615 170 3760 | 0.3 | 210 | Palm | 12,000 | 6 | 150 | 5/16-24 | 16.6 | 7.8 | 16.6 | 7.8 | 2 | 0.9 | H&L | CV | 4.4 | 1.9 | 81 | 92 | 1/4 |
| CP9534 | 615 193 9534 | 0.3 | 210 | Palm | 9,000 | 6 | 150 | 5/16-24 | 9 | 3.2 | 9 | 3.2 | 2.9 | 1.3 | H&L | CV | 2.58 | 1.2 | 83 | 94 | 1/4 |
| PALM GRIP - ORBITAL Ø 3/8" (10mm) | | | | | | | | | | | | | | | | | | | | | |
| CP9674 | 615 193 9674 | 0.3 | 210 | Palm | 9,000 | 6 | 150 | 5/16-24 | 9 | 3.2 | 9 | 3.2 | 2.3 | 1.3 | H&L | CV | 2.54 | 1.2 | 83 | 94 | 1/4 |

All models: Hose int. 3/8" (10mm) - @90 PSI (@6.3 Bar)

Listed specifications are for reference only. Please check documents in each tool.



Jitterbug Sanders

CP7263E ★



ERGONOMIC & POWERFUL

CP7263CVE

Same features as CP7263E with Central Vacuum

FEATURES

- Non-vacuum in Hook & Loop (H&L) pad
- 3"x4-1/4" (74x109 mm) jitterbug rectangle sander
- Powerful 0.3 hp (210 W) motor

BENEFITS

- Operator comfort with ergonomic palm shape
- Powerful and easy to use
- Compact pad great for sanding on small surfaces

CP7264E ★



ERGONOMIC & POWERFUL

CP7264CVE

Same features as CP7264E with Central Vacuum

FEATURES

- Non-vacuum in Hook & Loop (H&L) pad
- 2-3/4"x7-3/4" (70x198 mm) Jitterbug rectangle sander
- Powerful 0.3 hp (210 W) motor

BENEFITS

- Operator comfort with ergonomic palm shape
- Powerful and easy to use
- Long pad ideal for larger surfaces

CP7266E ★



ERGONOMIC & POWERFUL

CP7266CVE

Same features as CP7266E with Central Vacuum

FEATURES

- Non-vacuum in Hook & Loop (H&L) pad
- 3-1/4"x5" (80x130 mm) jitterbug rectangle sander
- Powerful 0.3 hp (210 W) motor

BENEFITS

- Operator comfort with ergonomic palm shape
- Powerful and easy to use
- Universal size pad for versatile use

CP7267E ★



ERGONOMIC & POWERFUL

CP7267CVE

Same features as CP7267E with Central Vacuum

FEATURES

- Non-vacuum in Hook & Loop (H&L) pad
- 3-7/8"-5-5/8" (100x144 mm) jitterbug delta sander
- Powerful 0.3 hp (210 W) motor

BENEFITS

- Operator comfort with ergonomic palm shape
- Powerful and easy to use
- Great for corners with the delta pad



See accessories on pages 139-146

★ GENERAL MAINTENANCE ★★ INDUSTRIAL MAINTENANCE & PRODUCTION ★★★ SUPER INDUSTRIAL

| MODEL | PART NUMBER | POWER | | GRIP | FREE SPEED | PAD CAPACITY | | AIR CONS. AT FREE SPEED | | AIR CONS. @LOAD | | NET WEIGHT | | PAD TYPE | VAC | VIBRATION LEVEL ISO 28927 (M/S ²) | | SOUND PRESS. | SOUND POWER | AIR INLET |
|-----------|--------------|-------|-----|------|------------|---------------------|---------------|-------------------------|-----|-----------------|-----|------------|-----|----------|-----|---|-----|--------------|-------------|-----------|
| | | hp | W | | | in. | mm | cfm | l/s | cfm | l/s | lb | kg | | | a | k | | | |
| CP7267E | 894 107 2670 | 0.3 | 210 | Palm | 10,000 | 3-7/8"-5-5/8" delta | 100x144 celta | 18 | 8.5 | 18 | 8.5 | 1.5 | 0.7 | H&L | no | 9.6 | 3.2 | 78 | 89 | 1/4 |
| CP7267CVE | 894 117 2670 | 0.3 | 210 | Palm | 10,000 | 3-7/8"-5-5/8" delta | 100x144 celta | 18 | 8.5 | 18 | 8.5 | 1.6 | 0.7 | H&L | CV | 9 | 3.7 | 78 | 89 | 1/4 |
| CP7266E | 894 107 2660 | 0.3 | 210 | Palm | 10,000 | 3-1/4"x5 | 80x130 | 18 | 8.5 | 18 | 8.5 | 1.5 | 0.7 | H&L | no | 7.3 | 2.9 | 78 | 89 | 1/4 |
| CP7266CVE | 894 117 2660 | 0.3 | 210 | Palm | 10,000 | 3-1/4"x5 | 80x130 | 18 | 8.5 | 18 | 8.5 | 1.3 | 0.7 | H&L | CV | 7.7 | 2.8 | 78 | 89 | 1/4 |
| CP7264E | 894 107 2640 | 0.3 | 210 | Palm | 10,000 | 2-3/4"x7-3/4 | 70x198 | 18 | 8.5 | 18 | 8.5 | 1.2 | 0.7 | H&L | no | 9.2 | 3.4 | 78 | 89 | 1/4 |
| CP7264CVE | 894 117 2640 | 0.3 | 210 | Palm | 10,000 | 2-3/4"x7-3/4 | 70x198 | 18 | 8.5 | 18 | 8.5 | 1.7 | 0.8 | H&L | CV | 7.2 | 2.1 | 78 | 89 | 1/4 |
| CP7263E | 894 107 2650 | 0.3 | 210 | Palm | 10,000 | 3"x4-1/4 | 74x109 | 18 | 8.5 | 18 | 8.5 | 1.4 | 0.6 | H&L | no | 9.4 | 3.0 | 78 | 89 | 1/4 |
| CP7263CVE | 894 117 2650 | 0.3 | 210 | Palm | 10,000 | 3"x4-1/4 | 74x109 | 18 | 8.5 | 18 | 8.5 | 1.5 | 0.7 | H&L | CV | 8.9 | 2.1 | 78 | 89 | 1/4 |

All models: Hose int. 3/8" (10mm) - @90 PSI (@6.3 Bar)

Listed specifications are for reference only. Please check documents in each tool.



FINISHING

1.5 hp (1,100 W) Angle Sanders

The CP3550 Series Benefits

INDUSTRIAL PRODUCTIVITY & ERGONOMICS

- Industrial angle sander
- Industrial grade durability with up to a 1,000 hour maintenance intervals
- Superior torque for maximal productivity



CP3550-120AB



FEATURES

- 1.5 hp (1,100 W) governed motor
- Durable bevel gear
- Spindle lock button



CP3550-120AB



See accessories on pages 139-146

CP3550-120AA



FEATURES

- 1.5 hp (1,100 W) governed motor
- Durable bevel gear
- Spindle lock button



CP3550-120AB



| MODEL | PART NUMBER | FREE SPEED | | POWER | | PAD CAPACITY | | SPINDLE THREAD | AIR CONS. AT FREE SPEED | | AIR CONS. @LOAD | | NET WEIGHT | | LENGTH | | VIBRATION LEVEL (ISO 28927 (M/S ²)) | | SOUND PRESS. ISO 15744 - dB(A) | SOUND POWER | AIR INLET |
|--------------|--------------|------------|--|-------|-------|--------------|-----|----------------|-------------------------|-----|-----------------|------|------------|-----|--------|-----|---|-----|--------------------------------|-------------|-----------|
| | | rpm | | hp | W | in. | mm | | in. | cfm | l/s | cfm | l/s | lb | kg | in. | mm | a | | | |
| CP3550-120AA | 615 162 0360 | 12,000 | | 1.5 | 1,100 | 5 | 125 | M14 | 36 | 18 | 56 | 26.5 | 3.2 | 1.5 | 9.8 | 249 | 5.2 | 3.4 | 84 | 95 | 3/8 |
| CP3550-120AB | 615 162 0370 | 12,000 | | 1.5 | 1,100 | 5 | 125 | 5/8-11 | 36 | 18 | 56 | 26.5 | 3.2 | 1.5 | 9.8 | 249 | 5.2 | 3.4 | 84 | 95 | 3/8 |

All models: Hose int. 3/8" (10mm) - @90 PSI (@6.3 Bar)

Listed specifications are for reference only. Please check documents in each tool.



2.4 hp (1,800 W) Sanders

The CP3650 Series Benefits

HIGH PERFORMANCE & ERGONOMICS

- Industrial angle sander
- Highest durability in demanding applications with up to 2,000 hours maintenance intervals
- Superior torque for maximal productivity



CP3650-120AB



CP3650-120AAE

Same features as CP3650-120AB with M14 spindle

CP3650-135AC4SE

Same features as CP3650-120AB with 3/8"-24 spindle and 13,500 rpm

FEATURES

- High power and torque motor
- Superior durability bevel gear
- Spindle lock button

SEE ALL CP3650 UNIQUE FEATURES ON PAGE 106



CP3650-120AB

SANDERS DELIVERED WITHOUT GUARD, WITHOUT PAD



See accessories on pages 139-146

CP3650-085AB

FEATURES

- High power and torque motor
- Superior durability bevel gear
- Spindle lock button



CP3650-085AB

CP3650-085AAE

Same features as CP3650-085AB with M14 spindle

CP3650-075AB

Same features as CP3650-085AB with 7,300 rpm

CP3650-075AAE

Same features as CP3650-085AB with 7,500 rpm and M14 spindle

GENERAL MAINTENANCE INDUSTRIAL MAINTENANCE & PRODUCTION SUPER INDUSTRIAL

| MODEL | PART NUMBER | FREE SPEED | | POWER | | PAD CAPACITY | | SPINDLE THREAD | AIR CONS. AT FREE SPEED | | AIR CONS. @LOAD | | NET WEIGHT | | LENGTH | | VIBRATION LEVEL ISO 28927 (M/S ²) | | SOUND PRESS. ISO 15744 - dB(A) | SOUND POWER | AIR INLET |
|-----------------|--------------|------------|-----|-------|-----|--------------|--------|----------------|-------------------------|-----|-----------------|-----|------------|-----|--------|-----|---|----|--------------------------------|-------------|-----------|
| | | rpm | hp | W | in. | mm | in. | | cfm | l/s | cfm | l/s | lb | kg | in. | mm | a | k | | | |
| CP3650-075AAE | 615 160 7270 | 7,500 | 2.4 | 1,800 | 7 | 180 | M14 | 32 | 15 | 57 | 27 | 3.0 | 1.4 | 9.4 | 238 | 3.3 | 1.6 | 79 | 90 | 3/8 | |
| CP3650-075AB | 615 160 7280 | 7,500 | 2.4 | 1,800 | 7 | 180 | 5/8-11 | 32 | 15 | 57 | 27 | 3.1 | 1.4 | 9.4 | 238 | 3.3 | 1.6 | 78 | 89 | 3/8 | |
| CP3650-085AAE | 615 160 7260 | 8,500 | 2.4 | 1,800 | 7 | 180 | M14 | 42 | 20 | 68 | 32 | 3.0 | 1.4 | 9.4 | 238 | 3.4 | 1.7 | 80 | 91 | 3/8 | |
| CP3650-085AB | 615 162 0190 | 8,500 | 2.4 | 1,800 | 7 | 180 | 5/8-11 | 42 | 20 | 68 | 32 | 3.0 | 1.4 | 9.4 | 238 | 3.4 | 1.7 | 80 | 91 | 3/8 | |
| CP3650-120AAE | 615 160 7240 | 12,000 | 2.4 | 1,800 | 5 | 125 | M14 | 42 | 20 | 68 | 32 | 3.0 | 1.4 | 9.4 | 238 | 2.9 | 1.5 | 85 | 96 | 3/8 | |
| CP3650-120AB | 615 160 7250 | 12,000 | 2.4 | 1,800 | 5 | 125 | 5/8-11 | 42 | 20 | 68 | 32 | 3.1 | 1.4 | 9.4 | 238 | 2.9 | 1.5 | 86 | 97 | 3/8 | |
| CP3650-135AC4SE | 615 160 7290 | 13,500 | 2.4 | 1,800 | 4 | 115 | 3/8-24 | 53 | 25 | 74 | 35 | 3.3 | 1.5 | 9.4 | 238 | 4.8 | 3.6 | 85 | 96 | 3/8 | |

All models: Hose int. 1/2" (13mm) - @90 PSI (@6.3 Bar)

Listed specifications are for reference only. Please check documents in each tool.



FINISHING

2.8 hp (2,100 W) Sanders

The CP3850 Series Benefits

SUPERLATIVE PERFORMANCE & ERGONOMICS

- Industrial angle sander
- Highest durability in demanding applications with up to 2,000 hours maintenance intervals
- Superior torque for maximum productivity



CP3850-85ABVE

FEATURES

- Low profile angle head
- Superior durability bevel gear
- Double action safety lever

CE CERTIFICATION
NOT FOR ANSI MARKET



CP3850-85ABVE

CP3850-77AB

Same features as CP3850-85ABVE with 7,700 rpm free speed and without autobalancer

FOR ANSI MARKET

CP3850-65ABVE



CP3850-60AB

Same features as CP3850-65ABVE with 6,000 rpm free speed and without autobalancer

FOR ANSI MARKET

FEATURES

- Low profile angle head
- Superior durability bevel gear
- Double action safety lever

SEE ALL CP3850 UNIQUE FEATURES ON PAGE 109



CP3850-65ABVE

SANDERS DELIVERED
WITHOUT GUARD, WITHOUT PAD



See accessories on pages 139-146

GENERAL MAINTENANCE INDUSTRIAL MAINTENANCE & PRODUCTION SUPER INDUSTRIAL

| MODEL | PART NUMBER | FREE SPEED | | POWER | | PAD CAPACITY | | SPINDLE THREAD | AIR CONS. AT FREE SPEED | | AIR CONS. @LOAD | | NET WEIGHT | | LENGTH | | VIBRATION LEVEL ISO 28927 (M/S ²) | | SOUND PRESS. ISO 15744 - dB(A) | SOUND POWER | AIR INLET |
|---|--------------|------------|-----|-------|-----|--------------|--------|----------------|-------------------------|-----|-----------------|-----|------------|------|--------|------|---|----|--------------------------------|-------------|-----------|
| | | rpm | hp | W | in. | mm | in. | | cfm | l/s | cfm | l/s | lb | kg | in. | mm | a | k | | | |
| ANSI MODELS | | | | | | | | | | | | | | | | | | | | | |
| CP3850-60AB | 615 170 5000 | 6,000 | 2.8 | 2,100 | 9 | 230 | 5/8-11 | 38 | 18 | 80 | 38 | 5.1 | 2.3 | 13.4 | 340 | <2.5 | - | 86 | 97 | 1/2 | |
| CP3850-77AB | 615 170 4990 | 7,700 | 2.8 | 2,100 | 7 | 180 | 5/8-11 | 33 | 16 | 69 | 32 | 4.1 | 2.3 | 13.4 | 340 | 3.6 | 0.8 | 84 | 95 | 1/2 | |
| CE CERTIFICATION - NOT FOR ANSI MARKET | | | | | | | | | | | | | | | | | | | | | |
| CP3850-65ABVE | 615 170 4980 | 6,500 | 2.8 | 2,100 | 9 | 230 | 5/8-11 | 44 | 21 | 80 | 38 | 5.1 | 2.3 | 13.4 | 340 | <2.5 | - | 89 | 100 | 1/2 | |
| CP3850-85ABVE | 615 170 4970 | 8,500 | 2.8 | 2,100 | 7 | 180 | 5/8-11 | 36 | 17 | 77 | 36 | 5.1 | 2.3 | 13.4 | 340 | <2.5 | - | 87 | 98 | 1/2 | |

All models: Hose int. 5/8" (15mm) - @90 PSI (@6.3 Bar)

Listed specifications are for reference only. Please check documents in each tool.



Accessories & Spares - Angle sanders 2" & 3" / Pistol sanders



FINISHING



BACK-UP PLATE

| MODEL | DESCRIPTION | PART NO. |
|---------|--|--------------|
| CP9778 | 3" (75mm) | 205 048 5063 |
| CP9778 | 4.5" (115mm) | 205 048 5073 |
| CP9778 | 5.5" (140mm) | 205 048 5083 |
| CP7202D | 3" ROL-LOC/twist lock backing pad, 1/4 - 20 female thread (must be used with Surface Prep Pad) | CA158102 |

ACCESSORIES INCLUDED

| MODEL | DESCRIPTION | PART NO. |
|-----------|--------------------------|--------------|
| CP3019-.. | Exhaust hose 31" (0.80m) | 615 875 1060 |
| | Flat wrench | 615 801 0030 |

| MODEL | ITEM | DESCRIPTION | PART NO. |
|--------|------|------------------------|--------------|
| CP3070 | 1 | Backing pad 5" (125mm) | 205 054 8393 |
| | 2 | Backing pad 3" (76mm) | 205 054 8383 |
| | 3 | Holder flange | 205 054 8403 |
| | . | Wrench kit | 205 054 8333 |

OPTIONAL ACCESSORIES

PADS

| MODEL | CAPACITY | PART NO. |
|-----------------|---------------|--------------|
| CP3019-.. | 2" (50mm) Pad | 205 054 9913 |
| CP3030-325AFR | 2" (50mm) Pad | 205 054 9913 |
| CP3030-4/5..AFR | 3" (76mm) Pad | 205 054 9933 |

SILENCERS

| MODEL | DESCRIPTION | PART NO. |
|-----------|--------------------|--------------|
| CP3019-.. | Silencer kit | 615 396 1010 |
| | Clippable silencer | 615 396 1240 |
| CP3030-.. | Clippable silencer | 615 396 1240 |

COLLET HOLDER

| MODEL | ITEM | CAPACITY | PART NO. |
|---------------|------|---------------------------------|--------------|
| CP3030-4..AFR | 1 | Series 200 collet holder | 615 523 0230 |
| CP3030-5..AFR | 2 | Series 200 collet nut | 615 607 1440 |
| | 3 | Collet, ø 1/8" (2.4 to 3.2mm) | 615 526 0610 |
| | . | Collet, ø 5.2 to 6mm | 615 526 0620 |
| | . | Collet, ø 1/4" (5.55 to 6.35mm) | 615 526 0630 |
| | . | Collet, ø 7.2 to 8mm | 615 526 0640 |

GREASE GUN

| MODEL | DESCRIPTION | PART NO. |
|-----------|------------------------------------|--------------|
| CP3019-.. | Grease gun (capacity 0.8 oz - 24g) | 615 990 1490 |

TUNE-UP KITS

| MODEL | PART NO. |
|-------------|--------------|
| CP3030-3. | 205 054 6403 |
| CP3030-4.. | 205 054 7863 |
| CP3030-5.. | 205 054 7923 |
| CP3070-120G | 205 054 8293 |
| CP9778 | 205 050 6663 |
| CP9779 | 205 050 3853 |
| CP9780 | 205 050 3863 |



FINISHING

Accessories & Spares - Belt sanders



TUNE-UP KITS

| MODEL | PART NO. |
|---------------|--------------|
| CP5080-3260.. | 205 054 6403 |
| CP5080-4200.. | 205 054 7863 |
| CP5080-5220.. | 205 054 7923 |

OPTIONAL ACCESSORIES CP5080 SERIES

CP5080-3260 Series - 12" (305mm)

| GUARD SUPPORT | PART NO. | CONTACT ARM | PART NO. | WHEEL ASSEMBLY | PART NO. | PLATTEN PAD SET | PART NO. |
|--|-----------------------------------|--------------|---------------------------|----------------|-----------------------------|-----------------|----------|
|  | 12" (305mm) Guard support | 205 054 5513 | 1/2" (13mm) - 5/8" (16mm) | 205 054 6443 | 1/2" x 1.97" (13 x 50mm) | 205 054 6233 | |
|  | 1/2"x12" (13x305mm) - 5/8" (16mm) | 205 054 5523 | 1/2" (13mm) - 5/16" (8mm) | 205 054 6503 | 1/2" x 1-15/16" (13 x 49mm) | 205 054 6243 | |
|  | 1/2"x12" (13x305mm) - 5/16" (8mm) | 205 054 5533 | 1/8" (3mm) | 205 054 6473 | 5/16" x 2.05" (8 x 52mm) | 205 054 6253 | |
|  | 1/8"x12" (3x305mm) | 205 054 5543 | 1/4" (6mm) | 205 054 6493 | | | |
|  | 1/4"x12" (6x305mm) | 205 054 5553 | | | | | |

CP5080-4200 Series - 18" (457mm)

| GUARD SUPPORT | PART NO. | CONTACT ARM | PART NO. | WHEEL ASSEMBLY | PART NO. | PLATTEN PAD SET | PART NO. |
|---|--|--------------|---------------------------------------|----------------|-------------|-------------------------------|--------------|
|  | 18" (457mm) Guard support | 205 054 5443 | 5/8" to 3/4" x 18" (16 to 19 x 457mm) | 205 054 5453 | 5/8" (16mm) | 3/4" x 2-1/8" (19 x 54mm) | 205 054 6263 |
|  | 18" (457mm) Guard support with side handle | 205 054 7953 | 1/2" x 18" (13 x 457mm) | 205 054 5463 | 1/2" (13mm) | 11/16" x 1-15/16" (17 x 49mm) | 205 054 6273 |
|  | 5/8" to 3/4" x 18" (16 to 19 x 457mm) | 205 054 5453 | 1/8" to 1/2" x 18" (3 to 13 x 457mm) | 205 054 5473 | 1/8" (3mm) | 205 054 6473 | |
|  | 1/2" x 18" (13 x 457mm) | 205 054 5463 | 1/2" x 18" (13 x 457mm) | 205 054 5483 | 1/2" (13mm) | 205 054 6483 | |
|  | 1/8" to 1/2" x 18" (3 to 13 x 457mm) | 205 054 5473 | 1/4" x 18" (6 x 457mm) | 205 054 5493 | 1/4" (6mm) | 205 054 6493 | |
|  | 1/2" x 18" (13 x 457mm) | 205 054 5483 | 1" x 18" (25 x 457mm) | 205 054 5503 | 1" (25mm) | 205 054 6423 | |
|  | 1/4" x 18" (6 x 457mm) | 205 054 5493 | | | | | |
|  | 1" x 18" (25 x 457mm) | 205 054 5503 | | | | | |

CP5080-5220 Series - 24" (610mm)

| GUARD SUPPORT | PART NO. | CONTACT ARM | PART NO. | WHEEL ASSEMBLY | PART NO. | PLATTEN PAD SET | PART NO. |
|---|---------------------------|--------------|----------------------------------|----------------|-------------|--------------------------|--------------|
|  | 24" (610mm) Guard support | 205 054 5413 | 1/2"x24" (13x610mm) | 205 054 5423 | 1/2" (13mm) | 1/2" x 1.97" (13 x 50mm) | 205 054 6243 |
|  | 1/2"x24" (13x610mm) | 205 054 5423 | 1/4" to 1/2"x24" (6 to 13x610mm) | 205 054 5433 | 1/4" (6mm) | 205 054 6473 | |
| | 24" (610mm) Guard support | 205 054 5413 | | | | | |



Accessories & Spares - Belt sanders



FINISHING

| DESCRIPTION | IMPERIAL (" INCHES) | METRIC (MM) | FOR TOOL 1/2 | FOR TOOL 2/2 | GRIT | UNITS | PART NUMBER |
|--------------------------------------|---------------------|-------------|---|--|-------------|-------|--------------|
| Sanding belt | 1/8 x 12 | 3 x 305 | CP5080-3260D12(K) + 205 054 5543 contact arm | - | 120 | 10 | 894 016 9706 |
| | | | | | 80 | 10 | 894 016 9705 |
| Sanding belt | 1/4 x 12 | 6 x 305 | CP5080-3260D12(K) + 205 054 5553 contact arm | - | 120 | 10 | 894 016 9710 |
| | | | | | 40 | 10 | 894 016 9707 |
| | | | | | 60 | 10 | 894 016 9708 |
| | | | | | 80 | 10 | 894 016 9709 |
| Sanding belt | 1/2 x 12 | 13 x 305 | CP5080-3260D12(K) + 205 054 5533 contact arm | - | 120 | 10 | 894 016 9714 |
| | | | | | 40 | 10 | 894 016 9711 |
| | | | | | 60 | 10 | 894 016 9712 |
| | | | | | 80 | 10 | 894 016 9713 |
| Sanding belt | 3/8 x 13 | 10 x 330 | CP9779, CP858 | - | 100 | 10 | 894 016 9005 |
| | | | | | 120 | 10 | 894 016 9006 |
| Sanding belt | 1/8 x 18 | 3 x 457 | CP5080-4200H18 + 205 054 5474 contact arm | CP5080-5220H18 + 205 054 5474 contact arm | 60 | 10 | 894 016 9003 |
| | | | | | 80 | 10 | 894 016 9004 |
| Sanding belt | 1/8 x 18 | 3 x 457 | CP5080-4200H18 + 205 054 5493 contact arm | CP5080-5220H18 + 205 054 5493 contact arm | 120 | 10 | 894 016 9716 |
| | | | | | 80 | 10 | 894 016 9715 |
| Sanding belt | 1/4 x 18 | 6 x 457 | CP5080-4200H18 + 205 054 5493 contact arm | CP5080-5220H18 + 205 054 5493 contact arm | 120 | 10 | 894 016 9720 |
| | | | | | 40 | 10 | 894 016 9717 |
| | | | | | 60 | 10 | 894 016 9718 |
| | | | | | 80 | 10 | 894 016 9719 |
| Sanding belt | 1/2 x 18 | 13 x 457 | CP5080-4200H18 | CP5080-5220H18 + 205 054 5463 contact arm | 120 | 10 | 894 016 9724 |
| | | | | | 40 | 10 | 894 016 9721 |
| | | | | | 60 | 10 | 894 016 9722 |
| | | | | | 80 | 10 | 894 016 9723 |
| Sanding belt | 3/4 x 18 | 19 x 457 | CP5080-4200H18 + 205 054 5453 contact arm | CP5080-5220H18 + 205 054 5453 contact arm | 120 | 10 | 894 016 9728 |
| | | | | | 40 | 10 | 894 016 9725 |
| | | | | | 60 | 10 | 894 016 9726 |
| | | | | | 80 | 10 | 894 016 9727 |
| Sanding belt | 1 x 18 | 25 x 457 | CP5080-4200H18 + 205 054 5503 contact arm | CP5080-5220H18 | 120 | 10 | 894 016 9732 |
| | | | | | 40 | 10 | 894 016 9729 |
| | | | | | 60 | 10 | 894 016 9730 |
| | | | | | 80 | 10 | 894 016 9731 |
| Sanding belt | 3/4 x 20,4 | 19 x 520 | CP9780 | - | 100 | 10 | 894 016 9009 |
| | | | | | 120 | 10 | 894 016 9010 |
| | | | | | 60 | 10 | 894 016 9007 |
| | | | | | 80 | 10 | 894 016 9008 |
| Sanding belt | 1/4 x 24 | 6 x 610 | CP5080-4220D24 + 205 054 5433 contact arm | - | 120 | 10 | 894 016 9736 |
| | | | | | 40 | 10 | 894 016 9733 |
| | | | | | 60 | 10 | 894 016 9734 |
| | | | | | 80 | 10 | 894 016 9735 |
| Sanding belt | 1/2 x 24 | 13 x 610 | CP5080-4220D24 | - | 120 | 10 | 894 016 9740 |
| | | | | | 40 | 10 | 894 016 9737 |
| | | | | | 60 | 10 | 894 016 9738 |
| | | | | | 80 | 10 | 894 016 9739 |
| BELT SANDING SET 12" 5PC - CP | | | | | | | |
| Sanding belt | 1/2 x 12 | 13 x 305 | CP5080-3260D12(K) + 205 054 5533 contact arm | - | 80 | 1 | |
| | | | | | 120 | 1 | |
| Sanding belt | 1/4 x 12 | 6 x 305 | | | 4913 Medium | 1 | 205 054 5573 |
| | | | | | 80 | 1 | |
| | | | | | 120 | 1 | |
| BELT SANDING SET 18" 8PC - CP | | | | | | | |
| Sanding belt | 3/4 x 18 | 19 x 457 | CP5080-4200H18 + 205 054 5453 contact arm | CP5080-5220H18 + 205 054 5453 contact arm | 80 | 1 | |
| | | | | | 120 | 1 | |
| Sanding belt | 1/2 x 18 | 13 x 457 | CP5080-4200H18 | CP5080-5220H18 + 205 054 5463 contact arm | 4913 Medium | 1 | |
| | | | | | 80 | 1 | 205 054 5563 |
| Sanding belt | 1/4 x 18 | 6 x 457 | CP5080-4200H18 + 205 054 5493 contact arm | CP5080-5220H18 + 205 054 5493 contact arm | 120 | 1 | |
| | | | | | 4913 Medium | 1 | |
| | | | | | 80 | 1 | |
| | | | | | 120 | 1 | |

TUNE-UP KIT & REPAIR KIT



| MODEL | TUNE-UP KIT | MAINTENANCE KIT |
|------------------------|--------------|-----------------|
| CP7215/25/55 Series | 894 016 3459 | 205 052 2433 |
| CP7215/55H Series | 894 016 5875 | 205 052 2433 |
| CP7220/50.. | 894 015 8345 | 894 015 8346 |
| CP7225/55-3 Series | 894 016 3459 | 205 052 2433 |
| CP7263/64/66/67 Series | 894 016 9233 | |

| MODEL | TUNE-UP KIT |
|-----------------|--------------|
| CP7265S/CP7265P | 205 053 0943 |
| CP7269S/CP7269P | 894 016 7963 |
| CP9778 | 205 050 6663 |
| CP9779 | 205 050 3853 |
| CP9780 | 205 050 3863 |







FINISHING

Accessories - Orbital Sanders



ACCESSORIES INCLUDED

| MODEL | DESCRIPTION | PART NO. |
|---|------------------------------------|--------------|
|  CP7220/50E | 6" (150mm) Pad H&L | 615 990 1540 |
|  CP7220/50HE | 6" (150mm) Pad PSA | 615 990 1590 |
|  CP7220/50CVE/ HCVE | 6" (150mm) Pad H&L with 6 holes | 615 990 1550 |
|  CP7220/50SVE | 6" (150mm) Pad PSA with 6 holes | 615 990 1600 |
|  CP9534/CP9674 | 6" (150mm) Pad H&L with 6 holes | 352493 |
| CP7220/50SVE | Dust extraction kit | 894 015 8430 |

OPTIONAL ACCESSORIES

ECO CHANGE MOTOR



| MODEL | PART NO. |
|------------------------|--------------|
| CP7215 Series | 894 016 8374 |
| CP7225 Series | 894 016 8372 |
| CP7225-3 Series | 894 016 8370 |
| CP7255 / CP35.. Series | 894 016 8373 |
| CP7255-3 Series | 894 016 8371 |

VACUUM HOSE ADAPTERS FOR CENTRAL VACUUM SANDERS



| MODEL | DESCRIPTION | PART NO. |
|---|---|--------------|
| CP7220/50(H)CVE CP7225/55CVE-3, CP3514/15, CP7225/55/15CV(E), CP7255/15HCVE CP7263/64/66/67CVE | Vacuum hose adaptor ø 1" (25 mm) / ø 1-1/4" (32 mm) | 615 350 1170 |
| CP7220/50(H)CVE CP7225/55CVE-3, CP3514/15, CP7225/55/15CV(E), CP7255/15HCVE CP7263/64/66/67CVE | Vacuum hose adaptor ø 1-1/8" (28 mm) | 615 804 4480 |

DUST EXTRACTION KIT FOR SELF GENERATE VACUUM

| MODEL | DESCRIPTION | PART NO. |
|------------------------------|--|--------------|
| CP3512/13, CP7225/55/15SV(E) | Dust extraction kit (incl. 1 dust bag and its dust hose) | 205 052 2453 |
| CP3512/13, CP7225/55/15SV(E) | Dust bag set (incl. 5 dust bags) | 205 052 3203 |

DUST EXTRACTION KIT

| MODEL | DESCRIPTION | PART NO. |
|--|---------------------|--------------|
|  CP7220/7250 CP9534/9674 | Dust extraction kit | 894 015 8430 |

OPTIONAL ACCESSORIES

SANDING PADS (THREAD 5/16"-24)

| MODEL | DESCRIPTION | PART NO. |
|---|----------------------------------|--------------|
|  CP7220/50E | 6" (150mm) Pad H&L | 894 016 3456 |
|  CP7220/50HE | 6" (150mm) Pad PSA | 894 016 3455 |
|  CP7220/50CVE/HCVE | 6" (150mm) Pad PSA with 6 holes | 894 016 3457 |
|  CP7220/50CVE/HCVE | 6" (150mm) Pad PSA with 15 holes | 894 016 8235 |
|  CP7220/50CVE/HCVE | 6" (150mm) Pad H&L with 15 holes | 894 016 8236 |
| CP9534/9674 | 6" (150mm) Pad PSA with 6 holes | 615 990 1600 |
| CP9534/9674 | 6" (150mm) Pad H&L with 6 holes | 615 990 1550 |
| CP9534/9674 | Key for pad | 164433 |

SANDING PADS (THREAD 5/16"-24)

| MODEL | DESCRIPTION | PART NO. |
|-----------------|---|--------------|
| CP3510 | 5" (125 mm) Pad H&L | 894 016 6666 |
| CP3511 | 5" (125 mm) Pad PSA | 894 016 6665 |
| CP3512/14 | 5" (125 mm) Pad H&L with 5 holes | 894 016 6668 |
| CP3513/15 | 5" (125 mm) Pad PSA with 5 holes | 894 016 6667 |
| CP7225/55/15(H) | 6" (150 mm) Pad PSA with 15 holes | 894 016 8235 |
| CP7225/55/15(H) | 6" (150 mm) Pad H&L with 15 holes | 894 016 8236 |
| CP7225/55/15(H) | 6" (150 mm) Pad PSA with 6 holes, 123g (Only CP tools) | 894 016 3457 |
| CP7225/55/15(H) | 6" (150 mm) Pad H&L with 6 holes, 123g (Only CP tools) | 894 016 3458 |
| CP7225/55/15(H) | 6" (150 mm) Pad PSA | 894 016 3455 |
| CP7225/55/15(H) | 6" (150 mm) Pad H&L | 894 016 3456 |
| CP7225/55-3 | 3" (75 mm) Pad PSA w/o hole | 894 016 7203 |

SANDING PADS

| MODEL | DESCRIPTION | PART NO. |
|--------------|---|--------------|
| CP7263E | 3"x4-1/4" (74x109 mm) - NV - H&L Pad | 894 016 8997 |
| CP7263CVE | 3"x4-1/4" (74x109 mm) - CV - H&L Pad | 894 016 8998 |
| CP7264 Serie | 2-3/4"x7-3/4" (70x198 mm) - CV - H&L Pad Set | 894 016 9002 |
| CP7266E | 3-1/4"x5" (80x130 mm) - NV - H&L Pad | 894 016 8999 |
| CP7266CVE | 3-1/4"x5" (80x130 mm) - CV - H&L Pad | 894 016 9000 |
| CP7267 Serie | 3-7/8"-5-5/8" delta (100x144 mm) - CV - H&L Pad Set | 894 016 9001 |

SANDING PAPER

ROL-LOC SURFACE PREPARATION PAD
(must be used with the 3" ROL-LOC back-up pad)

| MODEL | DESCRIPTION | PART NO. |
|-----------|---|--------------|
| CP7202D | ø 3" (75 mm) Sanding disc 60 Grit (5 pc) | 894 016 1712 |
| CP7202D | ø 3" (75 mm) Sanding disc 80 Grit (5 pc) | 894 016 1713 |
| CP7202D | ø 3" (75 mm) Sanding disc 100 Grit (5 pc) | 894 016 1714 |
| CP7202D | ø 3" (75 mm) Sanding disc 120 Grit (5 pc) | 894 016 1715 |
| CP7202D | ø 3" (75 mm) Surface Prep Pad (fine) (5 pc) | 894 016 1716 |
| CP7202D | ø 3" (75 mm) Surface Prep Pad (medium) (5 pc) | 894 016 1717 |
| CP7202D | ø 3" (75 mm) Surface Prep Pad (course) (5 pc) | 894 016 1718 |
| CP7265/69 | Nut retainer | KF129586 |

SANDING ACCESSORIES

| MODEL | DESCRIPTION | PART NO. |
|--------|-------------|--------------|
| CP9778 | Flange | 205 048 5053 |
| | Rod-key | 205 048 5043 |

BACK-UP PLATE

| MODEL | DESCRIPTION | PART NO. |
|---------|--|----------------------|
| CP9778 | ø 4.75" (120 mm) Back-up ø 3.75" (95 mm) Back-up | KF137214 KF137215 |
| CP7202D | 3" ROL-LOC Backing pad, 1/4 - 20 female thread (must be used with Surface Prep Pad) | CA158102 |



Accessories - Sanders



CP3550 ACCESSORIES INCLUDED

| MODEL | ITEM | DESCRIPTION | PART NUMBER |
|--------|------|------------------|--------------|
| CP3550 | 1 | Exhaust hose kit | 615 813 2520 |
| | - | Side handle | 205 052 4063 |



CP3650 ACCESSORIES INCLUDED

| MODEL | ITEM | DESCRIPTION | PART NUMBER |
|--------|------|--|--------------|
| CP3650 | 1 | 3/8" air hose nipple for 1/2" (13mm) ID hose | 615 704 0270 |
| | 2 | Hose Clamp | 615 263 0240 |
| | 3 | Exhaust hose | 615 875 1130 |
| | 4 | Spanner wrench 17 mm | 615 995 1070 |
| | 5 | Side handle | 615 576 0380 |



| MODEL | ITEM | DESCRIPTION | PART NUMBER |
|-----------------|------|-------------------------------|--------------|
| CP3650-135AC4SE | 1 | Vibration-damping side handle | 615 576 0660 |
| | 2 | Flange | 615 606 5150 |
| | 3 | Backing with nut | 615 990 1670 |
| | 4 | Pin wrench | 615 802 0080 |

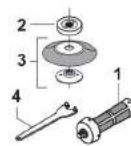

CP3550 OPTIONAL ACCESSORIES

| MODEL | ITEM | DESCRIPTION | PART NUMBER |
|------------|------|--|--------------|
| CP3550-... | 1 | Low vibration handle | 615 576 0780 |
| | 2 | Semi-hard backing pad 5" (125mm) with nut M14 & 5/8" | 615 804 0740 |



DIAMOND CUTTING KIT

| MODEL | ITEM | DESCRIPTION | PART NUMBER |
|--|------|-----------------------------------|--------------|
| CP3550-AA/AB ø127 (5") Diamond disc | - | Diamond disc 5" (127mm) | 615 804 9150 |
| | - | Complete kit | 615 397 8300 |
| | 1 | Manifold with screws | 615 504 2170 |
| | 2 | Gable cover plate complete 125 mm | 615 504 2180 |
| | 3 | Spacer 25 mm (5/8") | 615 643 0900 |
| | 3 | Spacer 25 mm (M14) | 615 643 0890 |
| | 4 | Spacer 6 mm (5/8") | 616 643 0910 |
| | 4 | Spacer 6 mm (M14) | 616 643 0920 |
| | 5 | Flange nut 5/8" | 617 606 0450 |
| | 5 | Flange nut M14 | 617 606 0460 |
| | - | Pin key | 617 802 0670 |



DUST EXTRACTION KIT Ø5" (125 MM)

| MODEL | ITEM | DESCRIPTION | PART NUMBER |
|--------------|------|------------------------|--------------|
| CP3550-AA/AB | - | Complete kit | 615 397 8280 |
| | 1 | Manifold with screws | 615 504 1940 |
| | 2 | Skirt 5" with brush | 615 570 2340 |
| | 3 | Spacer 15 mm (5/8") | 615 643 0880 |
| | 3 | Spacer 15 mm (M14) | 615 643 0870 |
| | 4 | Backing pad 5" (rigid) | 616 990 1990 |
| | 5 | Flange nut 5/8" | 617 606 0450 |
| | 5 | Flange nut M14 | 617 606 0460 |

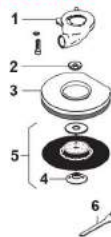

SANDING KIT FOR STANDARD ABRASIVE DISC 5" (125MM)

| MODEL | ITEM | DESCRIPTION | PART NUMBER |
|--|-----------------|-----------------------------------|--------------|
| CP3550-AA/AB ø127 (5") Diamond disc | - | Complete kit | 615 396 0720 |
| | 1 | Guard | 615 504 1450 |
| | 2 | Backing pad (with nut M14 & 5/8") | 615 990 1270 |
| | 3 | Washer M14 | 615 641 0270 |
| | 3 | Washer 5/8" | 615 642 0500 |
| | - | Hex key 5/16" | 616 802 0610 |
| - | Pin wrench 35mm | 617 802 0100 | |

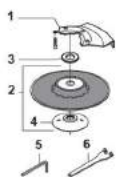

SANDING KIT FOR SEMI RIGID DISC 5" (125MM)

| MODEL | ITEM | DESCRIPTION | PART NUMBER |
|-----------|-----------------|-----------------------------------|--------------|
| CP3550-AA | - | Complete kit | 615 396 0750 |
| | 1 | Finger guard | 615 504 1450 |
| | 2 | Backing pad (with nut M14 & 5/8") | 615 990 1290 |
| | 3 | Washer M14 | 615 641 0270 |
| | - | Hex key 5/16" | 616 802 0610 |
| - | Pin wrench 35mm | 617 802 0100 | |

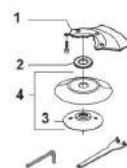

FINISHING

Accessories & Spares - Sanders

CP3650 OPTIONAL ACCESSORIES

DUST EXTRACTION KIT Ø5" (125 MM) FOR COMPOSITE (NON METAL SANDING)

| MODEL | ITEM | DESCRIPTION | PART NUMBER |
|---|------|------------------------|---------------------|
| CP3650-AA/AB | | Complete kit | 615 397 8280 |
|  | 1 | Suction cap | 615 504 1940 |
| | 2 | Spacer 15 mm (5/8") | 615 643 0880 |
| | 2 | Spacer 15 mm (M14) | 615 643 0870 |
| | 3 | Skirt with brush 5" | 615 570 2340 |
| | 4 | Nut (5/8") | 615 606 0450 |
| | 4 | Nut (M14) | 615 606 0460 |
| | 5 | Backing pad 5" (rigid) | 615 990 1990 |
| | 6 | Pin wrench 1-3/8" | 615 802 0100 |

| MODEL | ITEM | DESCRIPTION | PART NUMBER |
|---------------|------|---|---------------------|
| CP3650 | | 1 Silencer kit (55) (-11 dB) | 615 396 1660 |
| | 2 | Vibration-damping side handle | 615 576 0660 |
| | 3 | Reinforced cloth-lined exhaust hose L=30" | 615 875 1160 |
| | 4 | Hose clamp | 615 263 0240 |
| | 5 | Clippable silencer (-6 dB) | 615 396 9570 |
| | 6 | Grease gun include 24g | 615 990 1490 |
| | 7 | Grease for bevel gear (1kg) | 615 990 1480 |
| | - | Diamond disc 5" (125 mm) | 615 804 9150 |

| MODEL | ITEM | DESCRIPTION | PART NUMBER |
|---|------|-------------------------------|--------------|
|  | 1 | Sanding guard 7" (180 mm) kit | 615 504 2050 |

| MODEL | ITEM | DESCRIPTION | PART NUMBER |
|---|------|---|--------------|
|  | 1 | Semi-hard backing pad Ø5" (125mm) with nut M14 & 5/8" (max speed 12000 rpm) | 615 804 0740 |

| MODEL | ITEM | DESCRIPTION | PART NUMBER |
|----------------------|------|---------------------------------|--------------|
| CP3650-075AAE | 1 | Backing pad 7" (180 mm)(soft) | 615 990 1330 |
| CP3650-085AAE | 1 | Backing pad 7" (180 mm) (rigid) | 615 990 1340 |
| | 2 | Nut (M14) | - |
| | 2 | Nut (5/8") | - |
| | - | Pin wrench 1-3/8" (35 mm) | 615 802 0100 |

| MODEL | ITEM | DESCRIPTION | PART NUMBER |
|----------------------|------|---|--------------|
| CP3650-075AAE | 1 | Rigid velcro-backed backing pad 7" (180 mm) (M14x2) | 615 990 1450 |
| CP3650-085AAE | 1 | Rigid velcro-backed backing pad 6" (150 mm) (M14x2) | 615 990 1370 |

| MODEL | ITEM | DESCRIPTION | PART NUMBER |
|---------------------|------|---|--------------|
| CP3650-075AB | 1 | Rigid velcro-backed backing pad 7" (180 mm) (5/8"-11) | 615 990 1460 |
| CP3650-085AB | 1 | Rigid velcro-backed backing pad 6" (150 mm) (5/8"-11) | 615 990 1380 |



DUST EXTRACTION KIT Ø5" (125 MM) FOR COMPOSITE CUTTING (DIAMOND DISC)

| MODEL | ITEM | DESCRIPTION | PART NUMBER |
|---------------------|------|------------------------------|---------------------|
| CP3650-075AB | | Complete kit | 615 397 8300 |
| CP3650-120AB | 1 | Manifold cutting with screws | 615 504 2170 |
| | 2 | Goble cover plate complete | 615 504 2180 |
| | 3 | Spacer 6mm - Hole 14mm | 615 643 0920 |
| | 3 | Spacer 6mm - Hole 16mm | 615 643 0910 |
| | 4 | Spacer for M14 spindle | 615 643 0890 |
| | 4 | Spacer for 5/8" spindle | 615 643 0900 |
| | 5 | Flange nut M14 | 615 606 0460 |
| | 5 | Flange nut 5/8" | 615 606 0450 |
| | - | Pin key | 615 802 0670 |

DUST EXTRACTION KIT Ø7" (180 MM) FOR COMPOSITE (NON METAL SANDING)

| MODEL | ITEM | DESCRIPTION | PART NUMBER |
|---|------|---------------------------|---------------------|
| CP3650-AA/AB | | Complete kit | 615 397 8290 |
|  | 1 | Suction cap | 615 504 1940 |
| | 2 | Spacer 15 mm (5/8") | 615 643 0880 |
| | 2 | Spacer 15 mm (M14) | 615 643 0870 |
| | 3 | Skirt with brush | 615 570 2310 |
| | 4 | Nut (5/8") | - |
| | 4 | Nut (M14) | - |
| | 5 | Backing pad 7" (rigid) | 615 990 1340 |
| | 6 | Pin wrench 1-3/8" (35 mm) | 615 802 0100 |

SANDING KIT FOR STANDARD ABRASIVE DISC Ø5" (125MM)

| MODEL | ITEM | DESCRIPTION | PART NUMBER |
|---|------|---------------------------|---------------------|
| CP3650 (A&B) | | Complete kit | 615 396 0720 |
|  | 1 | Guard | 615 504 1450 |
| | 2 | Ventilated backing | 615 990 1270 |
| | 3 | M14 washer | 615 641 0270 |
| | 3 | 5/8" washer | 615 642 0500 |
| | 4 | Nut (M14) | - |
| | 4 | Nut (5/8) | 615 606 0290 |
| | 5 | Hex key 5/16" | 615 802 0610 |
| | 6 | Pin wrench 1-3/8" (35 mm) | 615 802 0100 |

SANDING KIT FOR SEMI-RIGID DISC Ø5" (125 MM)

| MODEL | ITEM | DESCRIPTION | PART NUMBER |
|---|------|---------------------------|---------------------|
| CP3650-...AA | | Complete kit | 615 396 0750 |
|  | 1 | Guard (CE only) | 615 504 1450 |
| | 2 | M14 washer | 615 641 0270 |
| | 3 | Nut (M14) | 615 606 0220 |
| | 4 | Complete backing | 615 990 1290 |
| | 5 | Hex key 5/16" | 615 802 0610 |
| | - | Pin wrench 1-3/8" (35 mm) | 615 802 0100 |

TUNE-UP KIT & REPAIR KIT

| MODEL | PART NUMBER |
|-------------------|---------------------|
| CP3650-... | 615 399 2280 |
| CP3650 | 205 055 6003 |



Accessories & Spares - Sanders



CP3850 ACCESSORIES INCLUDED

| MODEL | DESCRIPTION | PART NUMBER |
|------------------|---|--------------|
| CP3850-60AB/77AB | Vibration damping side handle | 615 576 0660 |
| | 1/2" Air hose nipple for 5/8" (15 mm) ID hose | 615 704 0140 |
| | Rear flange | 615 503 1070 |

| MODEL | DESCRIPTION | PART NUMBER |
|---------------|---|--------------|
| CP3850-65ABVE | Vibration damping side handle | 615 576 0660 |
| CP3850-85ABVE | 1/2" Air hose nipple for 5/8" (15 mm) ID hose | 615 704 0140 |
| | Auto balancer | 615 990 1950 |

CP3850 OPTIONAL ACCESSORIES

DUST EXTRACTION KIT Ø7" (180 MM) FOR COMPOSITE (NON METAL SANDING)

| MODEL | ITEM | DESCRIPTION | PART NUMBER |
|---|------|-----------------------------|--------------|
| CP3850-85ABVE / CP3850-65ABVE / CP3850-77AB / CP3850-60AB | 1 | Complete kit | 205 055 3563 |
| | | Manifold CP3850 with screws | 615 504 2190 |
| | | Push fit hood with brush | 615 570 2310 |
| | | Spacer 9mm | 615 643 0930 |
| | | Spacer 6mm hole 16mm | 615 643 0910 |
| | | Backing pad 180mm | 615 990 2000 |
| | | Flange nut 5/8 H16 | 615 606 0470 |
| | | Pin key | 615 802 0670 |

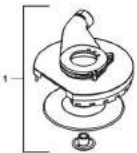

DUST EXTRACTION KIT Ø7" (180 MM) FOR COMPOSITE CUTTING (DIAMOND DISC)

| MODEL | ITEM | DESCRIPTION | PART NUMBER |
|---|------|------------------------------|--------------|
| CP3850-85ABVE / CP3850-65ABVE / CP3850-77AB / CP3850-60AB | | Complete kit | 205 055 3573 |
| | 1 | Manifold cutting with screws | 615 504 2200 |
| | 2 | Gable cover plate complete | 615 504 2210 |
| | 3 | Spacer for 5/8" spindle | 615 643 0900 |
| | 4 | Flange nut 5/8" | 615 606 0480 |
| | | Pin key | 615 8020 670 |
| | | 180mm Cutting Wheel | 615 811 1450 |



TUNE-UP KIT & REPAIR KIT



| MODEL | DESCRIPTION | TUNE-UP KIT |
|--------|---------------------|--------------|
| CP3850 | Motor Service Kit | 205 055 3543 |
| | Spindle Service Kit | 205 055 3553 |
| | Global Service Kit | 205 055 3433 |

PADS

| MODEL | ITEM | DESCRIPTION | PART NUMBER |
|-------|------|---|--------------|
| | 1 | Rigid backing pad with nut 5/8", Ø 180 mm (7") (max. 8,500 rpm) | 615 990 1340 |
| | 2 | Grease gun | 615 990 1490 |
| | 3 | Grease for bevel gear (1Kg) | 615 990 1480 |



| MODEL | ITEM | DESCRIPTION | PART NUMBER |
|-----------------------------|------|----------------------------------|--------------|
| CP3850-65ABVE / CP3850-60AB | 1 | Rear flange (ABVE) | 615 503 1070 |
| | 2 | Pin spanner 1-3/8" (35 mm) | 615 802 0100 |
| | 3 | Soft backing Pad 9" (230 mm) kit | 615 990 1410 |

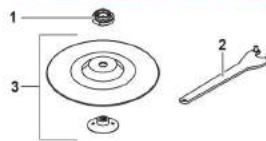

| MODEL | ITEM | DESCRIPTION | PART NUMBER |
|-----------------------------|------|----------------------------|--------------|
| CP3850-85ABVE / CP3850-77AB | 1 | Rear flange (ABVE) | 615 503 1070 |
| | 2 | Pad 7" (180mm) kit | 615 990 1330 |
| | 3 | Pin spanner 1-3/8" (35 mm) | 615 802 0100 |

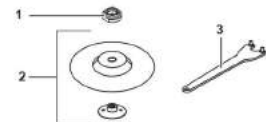

| MODEL | ITEM | DESCRIPTION | PART NUMBER |
|-----------------------------|------|----------------------------|--------------|
| CP3850-85ABVE / CP3850-77AB | 1 | Rear flange (ABVE) | 615 503 1070 |
| | 2 | Rigid Pad 7" (180mm) | 615 990 1340 |
| | 3 | Pin spanner 1-3/8" (35 mm) | 615 802 0100 |

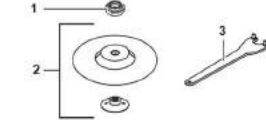

| MODEL | ITEM | DESCRIPTION | PART NUMBER |
|-------------|------|----------------------------|--------------|
| CP3850-77AB | 1 | Spiracool Pad 7" (180mm) | S091836 |
| | 2 | Pin spanner 1-3/8" (35 mm) | 615 802 0100 |

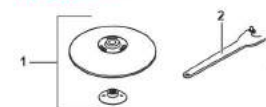

FINISHING

Dimensions

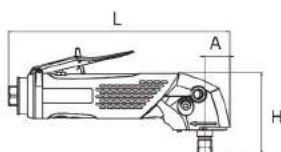
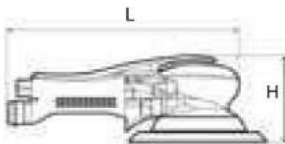
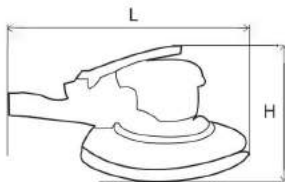
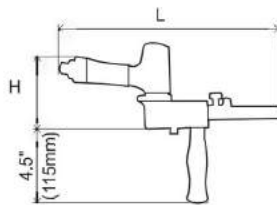
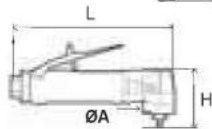
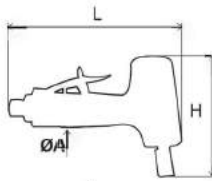
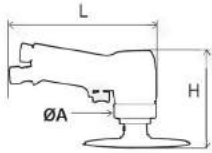

| PISTOL SANDERS | L | | H | | A | |
|----------------|-----|-----|-----|-----|------|----|
| | in. | mm | in. | mm | in. | mm |
| CP7202 | 6.5 | 166 | 4.3 | 110 | | |
| CP3070-120G | 6.9 | 175 | 4.2 | 108 | 1.97 | 50 |
| CP9778 | 8.2 | 203 | 4.5 | 115 | | |

| BELT SANDERS | L | | H | | W | |
|----------------|------|-----|-----|-----|-----|----|
| | in. | mm | in. | mm | in. | mm |
| CP5080-3260D12 | 11.4 | 290 | 3.7 | 95 | 2.7 | 70 |
| CP5080-4200D24 | 15.3 | 390 | 4.5 | 115 | 2.9 | 75 |
| CP5080-3260H18 | 14.5 | 370 | 9.8 | 250 | 3.1 | 80 |
| CP5080-5220H18 | 14.5 | 370 | 9.8 | 250 | 3.1 | 80 |
| CP5080-3260H19 | 14.5 | 370 | 4 | 100 | 3.1 | 80 |
| CP858 | 11.8 | 300 | 3.3 | 85 | 1.8 | 45 |
| CP9778 | 11.8 | 300 | 3.3 | 85 | 1.8 | 45 |
| CP9780 | 14.4 | 365 | 4.1 | 105 | 2.7 | 70 |

| ORBITAL SANDERS | L | | H | |
|-----------------------|------|-----|-----|-----|
| | in. | mm | in. | mm |
| CP3510 | 6.3 | 160 | 4.1 | 105 |
| CP3511 | 6.3 | 160 | 4.1 | 105 |
| CP3512 | 8.3 | 211 | 4.1 | 105 |
| CP3514 | 7.9 | 200 | 4.1 | 105 |
| CP7215/25/55 - (NV)-E | 7.3 | 185 | 4.1 | 105 |
| CP7215CV/25CV/55CV -E | 8.7 | 221 | 4.1 | 105 |
| CP7215SV/25SV/55SV -E | 9.1 | 232 | 4.1 | 105 |
| CP7215H/55H-E | 11.2 | 285 | 3.8 | 96 |
| CP7215HCVE/55HCVE | 11.2 | 285 | 3.8 | 96 |
| CP7220/50E | 5.0 | 127 | 3.7 | 95 |
| CP7220/50SVE | 7.3 | 186 | 3.3 | 83 |
| CP7220/50CVE | 7.3 | 186 | 3.3 | 83 |
| CP7220/50HE | 9.7 | 246 | 3.3 | 83 |
| CP722/50HCVE | 10 | 255 | 3.3 | 83 |
| CP7263E | 5.7 | 145 | 3 | 75 |
| CP7263CVE | 7.3 | 185 | 3 | 75 |
| CP7264E | 7.9 | 200 | 3.1 | 80 |
| CP7264ECVE | 9.5 | 240 | 3.1 | 80 |
| CP7266E | 6.1 | 155 | 2.7 | 70 |
| CP7266CVE | 7.7 | 195 | 2.7 | 70 |
| CP7267E | 7.3 | 185 | 4 | 100 |
| CP7267CVE | 8.8 | 225 | 4 | 100 |
| CP7268 | 16.5 | 420 | 5.9 | 150 |
| CP9534/CP9674 | 7.5 | 190 | 3.3 | 83 |

| ANGLE SANDERS | L | | H | | A | |
|-----------------|------|-----|-----|------|------|------|
| | in. | mm | in. | mm | in. | mm |
| CP3019-...AF | 6.5 | 166 | 3.7 | 67 | 1.18 | 30 |
| CP3030-3... | 6.1 | 154 | 4.1 | 103 | 1.6 | 41 |
| CP3030-4... | 6.8 | 174 | 3.7 | 93 | 1.7 | 43 |
| CP3030-5... | 6.8 | 174 | 5.5 | 139 | 1.7 | 43 |
| CP3550-120AA | 9.8 | 249 | 3.7 | 94 | 1.1 | 27 |
| CP3550-120AB | 9.8 | 249 | 3.7 | 94 | 1.1 | 27 |
| CP3650-...AAE | 9.4 | 238 | 3.4 | 87.8 | 1.1 | 26.8 |
| CP3650-...AB | 9.4 | 238 | 3.6 | 92.8 | 1.1 | 26.8 |
| CP3850-...AB | 13.1 | 334 | 4.3 | 107 | 1.2 | 29 |
| CP3850-...ABVE | 13.1 | 334 | 4.1 | 104 | 1.2 | 29 |
| CP3650-...AC4SE | 9.4 | 238 | 3.4 | 87.5 | 1.1 | 26.8 |

