

Dial Indicator

.0001" Graduated Dial Indicator (AGD-2)



AI-9111
Graduation .0001"
Measuring Range .05"
Jeweld, heavy-duty type
Shockproof



AI-9112
Graduation .0001"
Measuring Range .05"
Jeweld, heavy-duty type
Shockproof
Symmetrical Scale

.001" Graduated Dial Indicator (AGD-2)



AI-905
Graduation .001"
Measuring Range .25"
Shockproof



AI-906
Graduation .001"
Measuring Range .25"
Symmetrical Scale
Shockproof



AI-911
Graduation .001"
Measuring Range .50"
Shockproof



AI-921
Graduation .001"
Measuring Range 1.0"
Shockproof



AI-921B
Graduation .001"
Measuring Range 1.0"
Black Face
Shockproof

Miniature Dial Indicator (AGD-1)

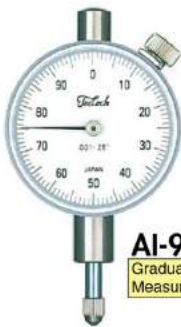

AI-935
Graduation .001"
Measuring Range .25"



AI-936
Graduation .001"
Measuring Range .25"
Symmetrical Scale

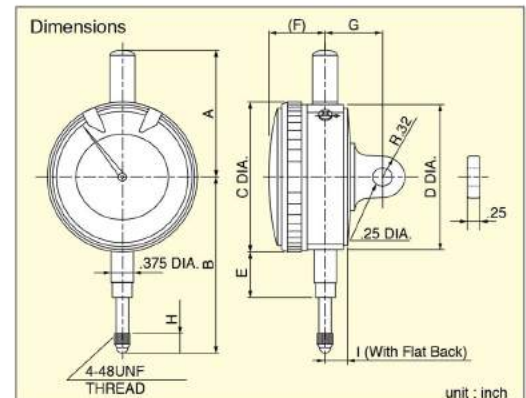

Specification

Model	Graduation (inch)	Total Range (inch)	Range per Rev. (inch)	Dial Reading	Accuracy (inch)	Measuring Force N(gf)	Dimensions (inch)									Weight (g)	Remark
							A	B	C	D	E	F	G	H	I		
AI-9111	.0001	.05	.01	0-5-10	±.0002	1.5(150) or less	1.58	2.35	2.2	2.07	.7	.59	.8	25	—	170	
AI-9112	.0001	.05	.01	0-5-0	±.0002	1.5(150) or less	1.58	2.35	2.2	2.07	.7	.59	—	.25	.32	170	Flat Back
AI-905	.001	.25	.10	0-50-100	±.0007	1.3(130) or less	1.76	2.51	2.17	2.05	.7	.62	.8	25	—	110	
AI-906	.001	.25	.10	0-50-0	±.0007	1.3(130) or less	1.76	2.51	2.17	2.05	.7	.62	—	.25	.31	110	Flat Back
AI-911	.001	.5	.10	0-50-100	±.0009	1.3(130) or less	1.49	2.65	2.17	2.05	.7	.62	.8	25	—	110	
AI-912	.001	.5	.10	0-50-0	±.0009	1.3(130) or less	1.49	2.65	2.17	2.05	.7	.62	.8	25	—	110	
AI-921	.001	1.0	.10	0-50-100	±.0014	2.2(220) or less	1.49	3.15	2.17	2.05	.7	.62	.8	25	—	115	
AI-921B	.001	1.0	.10	0-50-100	±.0014	2.2(220) or less	1.49	3.15	2.17	2.05	.7	.62	.8	25	—	115	Black Face
AI-922	.001	1.0	.10	0-50-0	±.0014	2.2(220) or less	1.49	3.15	2.17	2.05	.7	.62	.8	25	—	115	
AI-935	.001	.25	.10	0-50-100	±.0007	1.3(130) or less	1.08	1.73	1.54	1.43	.41	.53	.76	25	—	75	
AI-936	.001	.25	.10	0-50-0	±.0007	1.3(130) or less	1.08	1.73	1.54	1.43	.41	.53	.76	25	—	75	

Long Range Dial Indicator (AGD-2)



AI-951
Graduation .001"
Measuring Range 2.0"
Shockproof

AI-951B
Graduation .001"
Measuring Range 2.0"
Black Face
Shockproof

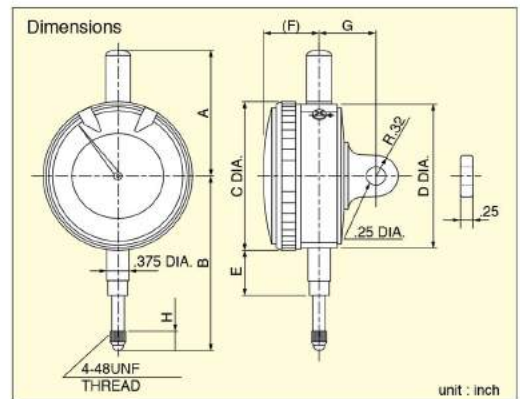

Specification

Model	Graduation (inch)	Total Range (inch)	Range per Rev. (inch)	Dial Reading	Accuracy (inch)	Measuring Force N(gf)	Dimensions (inch)								Weight (g)	Remark
							A	B	C	D	E	F	G	H		
AI-951	.001	2.0	.10	0-50-100	±.0032	2.5(250) or less	4.71	5.5	2.3	2.1	2.0	.71	.79	.25	215	
AI-951B	.001	2.0	.10	0-50-100	±.0032	2.5(250) or less	4.71	5.5	2.3	2.1	2.0	.71	.79	.25	215	Black Face

0.01mm Graduated Dial Indicator (AGD-2)



AM-921
Graduation 0.01mm
Measuring Range 25mm
.375" DIA. STEM
contact point (4-48UNF)
Shockproof

AM-110
Graduation 0.01mm
Measuring Range 10mm
.375" DIA. STEM
contact point (M2.5 × P0.45)
Shockproof

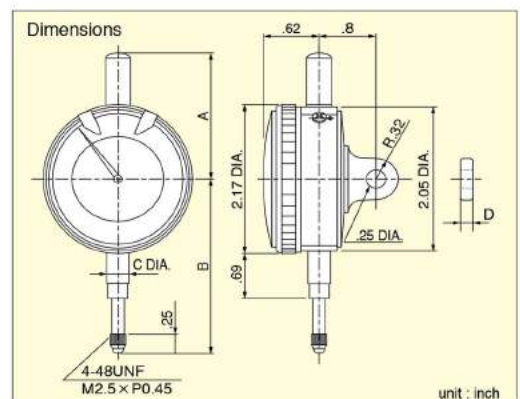

Specification

Model	Graduation (mm)	Total Range (mm)	Range per Rev. (mm)	Dial Reading	Accuracy (mm)	Measuring Force N(gf)	Dimensions (inch)				Contact Point Screw	Weight (g)
							A	B	Stem Dia : φ C	Lug Thickness : D		
AM-110	0.01	10	1.0	0-50-100	±0.015	1.4(140) or less	1.91	2.56	φ .375"	.25	M2.5 × P0.45	110
AM-121	0.01	20	1.0	0-50-100	±0.020	2.2(220) or less	1.42	2.95	φ 8mm	.196	M2.5 × P0.45	115
AM-921	0.01	25	1.0	0-50-100	±0.030	2.2(220) or less	1.49	3.15	φ .375"	.25	4-48UNF	115
AM-922	0.01	25	1.0	0-50-0	±0.030	2.2(220) or less	1.49	3.15	φ .375"	.25	4-48UNF	115

Dial Indicator (with 8mm stem)



TI-1111
Graduation .0001"
Measuring Range .05"
Heavy-duty, jeweled type
Shockproof



TI-1205
Graduation .0001"
Measuring Range .20"



TI-111
Graduation .001"
Measuring Range .50"
Shockproof



KI-121
Graduation .001"
Measuring Range 1.0"
Shockproof

Miniature Dial Indicator (AGD-1)



TI-35
Graduation .001"
Measuring Range .20"

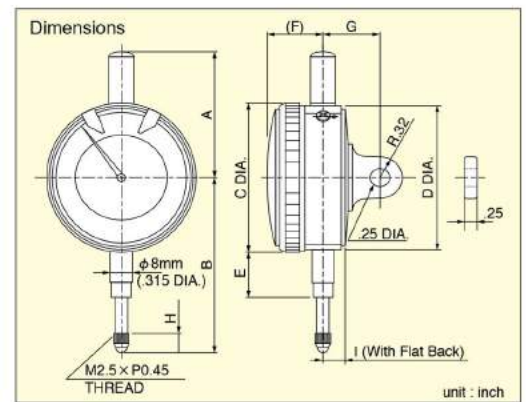

Specification

Model	Graduation (inch)	Total Range (inch)	Range per Rev. (inch)	Dial Reading	Accuracy (inch)	Measuring Force N(gf)	Dimensions (inch)								Weight (g)	Remark	
							A	B	C	D	E	F	G	H			I
TI-111	.001	.50	.10	0-50-100	±.0009	1.4(140) or less	1.76	2.7	2.177	2.05	.69	.62	.79	.30	—	110	
ki-121	.001	1.0	.10	0-50-100	±.0014	2.2(220) or less	1.44	3.19	2.17	2.05	.69	.62	.79	.30	—	115	
TI-1111	.0001	.05	.01	0-5-10	±.0002	1.5(150) or less	1.57	2.44	2.2	2.05	.71	.62	.79	.30	—	170	
TI-1112	.0001	.05	.01	0-5-0	±.0002	1.5(150) or less	1.57	2.44	2.2	2.05	.71	.62	.79	.30	.30	170	Flat Back
TI-1205	.0001	.20	.01	0-5-10	±.0004	1.5(150) or less	1.57	2.44	2.2	2.07	.59	.8	.79	.30	—	170	
TI-35	.001	.20	.10	0-50-100	±.0006	1.3(130) or less	1.08	1.63	1.54	1.43	.39	.57	.76	.20	—	70	

Test Indicator

Auto Clutch Type



LTI-352
Graduation .0005"
Measuring Range .03"



LTI-352B
Graduation .0005"
Measuring Range .03"
Blackface



LTI-355
Graduation .0001"
Measuring Range .01"



Standard Accessories Set
.375" DIA. Stem
.157" DIA. Stem
.125" Stylus (Steel ball)
.039" Stylus (Steel ball)

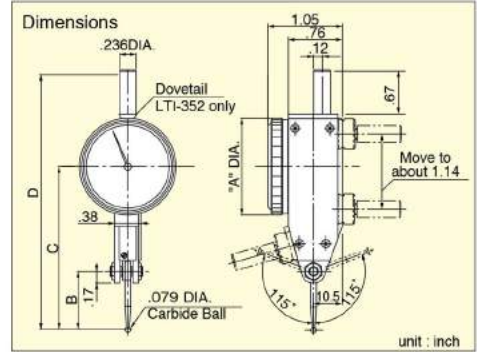

Specification

Model	Graduation (inch)	Total Range (inch)	Dial Reading	Accuracy (inch)	Measuring Force N(gf)	Dimensions (inch)				Weight (g)	Remark
						A	B	C	D		
LTI-352	.0005	.03	0-15-0	.0004	0.2(20) or less	1.38	.787	2.28	3.94	75	Standard
LTI-352B	.0005	.03	0-15-0	.0004	0.2(20) or less	1.38	.787	2.28	3.94	75	Black Face
LTI-353	.0005	.03	0-15-0	.0004	0.2(20) or less	1.38	1.52	3.02	4.68	75	Long Contact Point
LTI-355	.0001	.01	0-5-0	.0002	0.25(25) or less	1.38	.64	2.14	3.86	75	Precision

Lever Type



LTI-310
Graduation .001"
Measuring Range .03"



LTI-315
Graduation .0005"
Measuring Range .03"



LTI-370
Graduation .0001"
Measuring Range .01"

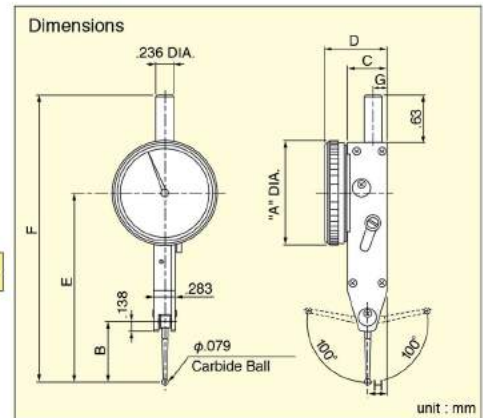

Specification

Model	Graduation (inch)	Total Range (inch)	Dial Reading	Accuracy (inch)	Measuring Force N(gf)	Dimensions (inch)								Weight (g)
						A	B	C	D	E	F	G	H	
LTI-310	.001	.03	0-15-0	.0004	0.4(40) or less	1.12	.56	.54	.85	1.83	3.1	.2	.28	50
LTI-315	.0005	.03	0-15-0	.0004	0.4(40) or less	1.38	.75	.53	.85	2.44	3.74	.19	.27	60
LTI-316	.0005	.04	0-20-0	.0005	0.4(40) or less	1.38	1.72	.53	.85	3.41	4.70	.19	.27	70
LTI-370	.0001	.01	0-5-0	.0002	0.4(40) or less	1.51	.43	.53	.85	2.12	3.41	.19	.27	70

Parts Stylus

Code No.	Type	Code No.	Type
ZS-722	LTI-310	ZS-729	.078" DIA.
ZS-723	LTI-315	ZS-730	LTI-353 .039" DIA.
ZS-724	LTI-316	ZS-731	.125" DIA.
ZS-735	LTI-370	ZS-732	.078" DIA.
ZS-725	.078" DIA.	ZS-733	LTI-355 .039" DIA.
ZS-726	LTI-352 .039" DIA.	ZS-734	.125" DIA.
ZS-727	.125" DIA.		

Steel ball

Universal Holder with Clamp



ZY-062

Code No.	Dimensions (inch)
ZY-062	Dovetail.236 DIA.

Thickness Gauge

Dial Thickness Gauges



SI-112
 Graduation .001"
 Measuring Range .5"
 Contact Point and Anvil (Ceramic)

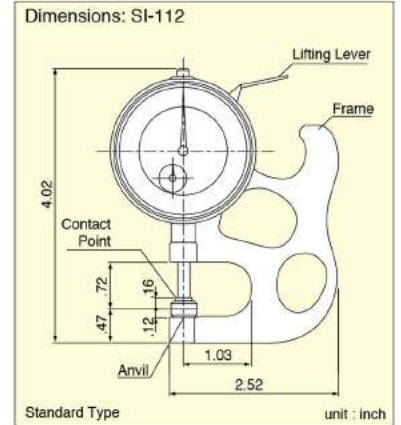

Specification

Model	Graduation (inch)	Total Range (inch)	Range per Rev. (inch)	Dial Reading	Contact Point Form (inch)	Anvil Form (inch)	Measuring Force N(gf)	Weight (g)
SI-112	.001	.5	.10	±0-50-100	.394 DIA. Flat	.394 DIA. Flat	2.5(250) or less	145
SI-112LS	.001	.5	.10	±0-50-100	S.125(1/8) DIA.	.394 DIA. Flat	2.5(250) or less	145
SI-112LW	.001	.5	.10	±0-50-100	S.125(1/8) DIA.	S.125(1/8) DIA.	2.5(250) or less	145
SI-112-3A	.001	.5	.10	±0-50-100	.197 DIA. Flat	.197 DIA. Flat	2.5(250) or less	145



SI-114
 Graduation .001"
 Measuring Range .5"
 Contact Point and Anvil (Ceramic)

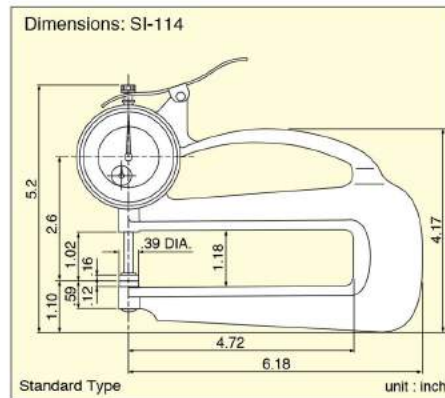

Specification

Model	Graduation (inch)	Total Range (inch)	Range per Rev. (inch)	Dial Reading	Contact Point Form (inch)	Anvil Form (mm)	Measuring Force N(gf)	Weight (g)
SI-114	.001	.5	.10	±0-50-100	.394 DIA. Flat	.394 DIA. Flat	2.5(250) or less	270
SI-114LS	.001	.5	.10	±0-50-100	S.125 (1/8) DIA.	.394 DIA. Flat	2.5(250) or less	270
SI-114LW	.001	.5	.10	±0-50-100	S.125 (1/8) DIA.	S.125 (1/8) DIA.	2.5(250) or less	270
SI-124	.001	1.0	.10	±0-50-100	.394 DIA. Flat	.394 DIA. Flat	3.5(350) or less	270
SI-124LS	.001	1.0	.10	±0-50-100	S.125 (1/8) DIA.	.394 DIA. Flat	3.5(350) or less	270
SI-124LW	.001	1.0	.10	±0-50-100	S.125 (1/8) DIA.	S.125 (1/8) DIA.	3.5(350) or less	270

Anvil & Contact Point

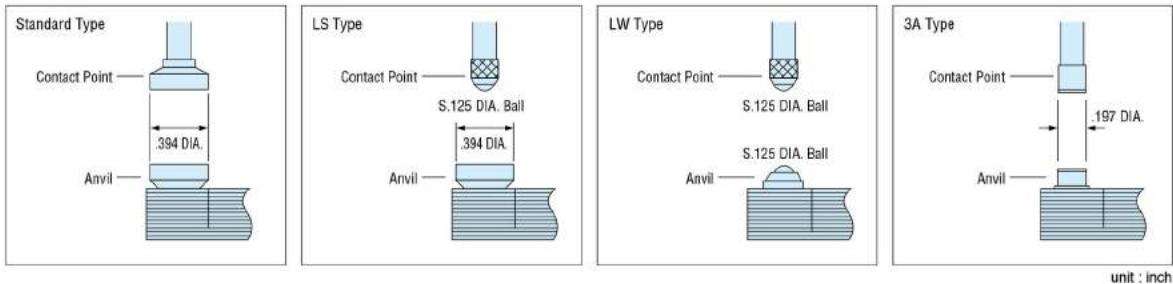

Digital Indicator



PC-442

Resolution .0005"/0.01mm
Measuring Range .5"/12.7mm



PC-467

Resolution .00005"/0.001mm
Measuring Range .5"/12.7mm

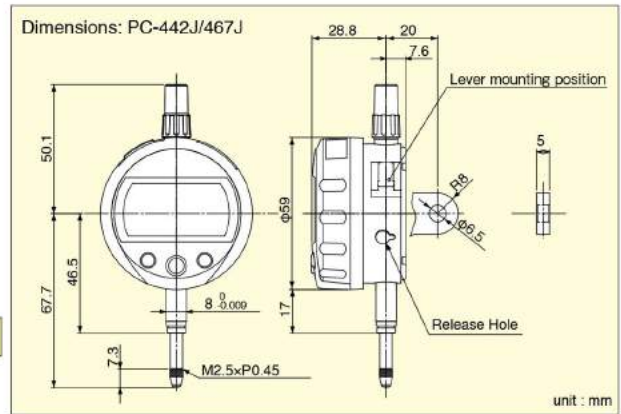

Supplied with Lug back as standard models.
Flat back and Lift lever are optional.

Specifications

Model	Designations (inch/mm)	Resolution (inch/mm)	Measuring Range (inch/mm)	Accuracy* (inch)	Stem Diameter (mm)	Contact Point	Point Screw	Measuring Force N(gf)	Weight (g)
PC-442	.5-.0005/12.7-0.01	.0005/0.01	.5/12.7	.0008	φ 8	Carbide	M2.5 × 0.45	1.2(120) or less	160
PC-467	.5-.00005/12.7-0.001	.00005/0.001	.5/12.7	.00012	φ 8	Carbide	M2.5 × 0.45	1.2(120) or less	160

* The quantising error is not included.